

# ASSEMBLY

## Allé Mobile Monitor Wall

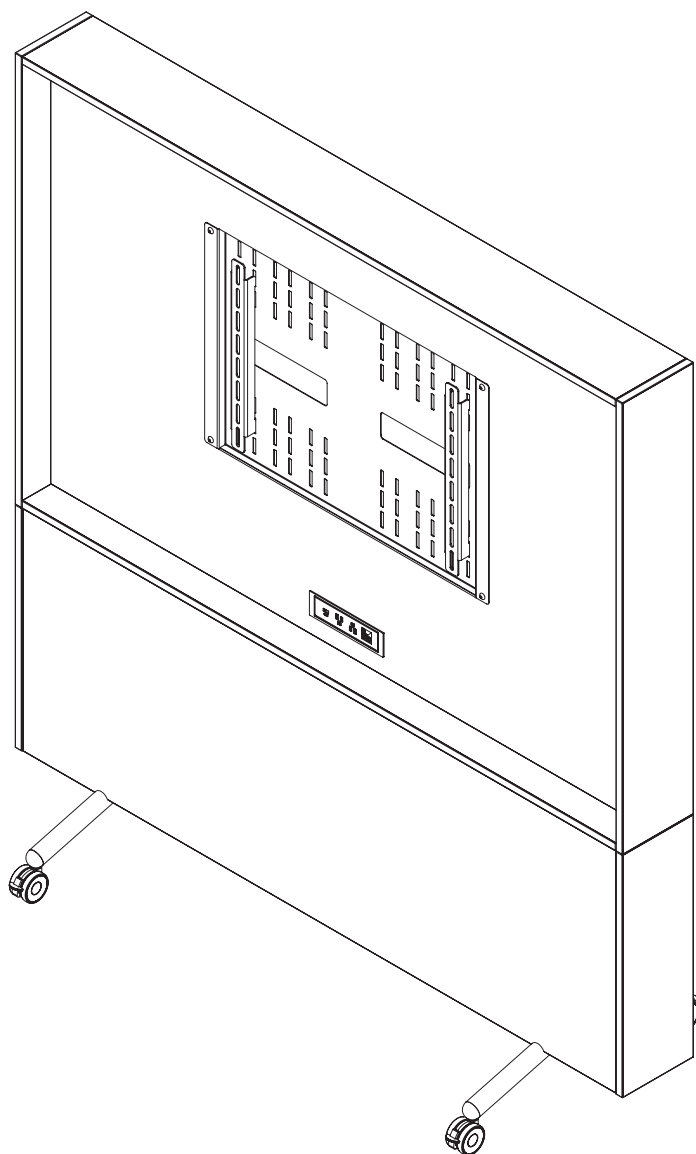

# Hardware

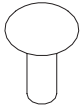

M4 x 12mm PH Zinc  
Screw  
(117016)

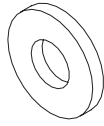

1/4 Flat Zinc  
Washer  
(145000)



M8 8mm  
Screw, Cone Tip Set  
(0002791)

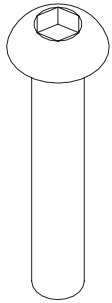

5/16-18 x 1-3  
4 SHCS BK  
Screw  
(125040)

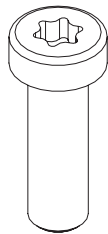

M8-1.25 x 25mm  
Screw, Low Head  
(0002870)

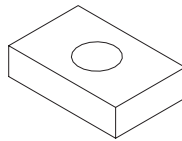

20 x 14 x 6mm  
Nut, Rectangular  
(0002935)

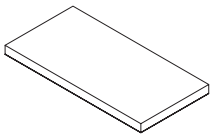

Dual-Lock 1 x 2" Black  
Optional  
(141800)

# Parts

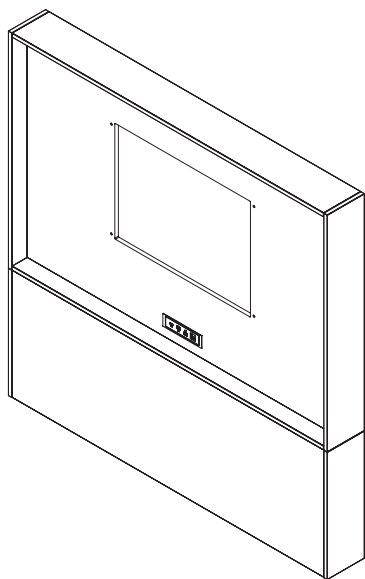

Case Assembly

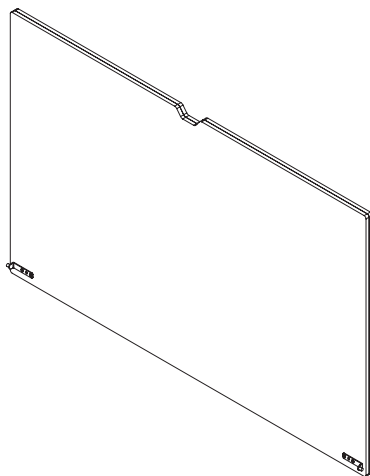

Fabric Panel

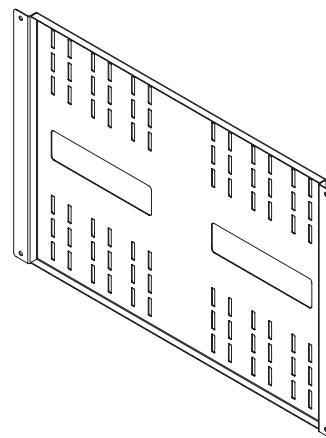

AV Mount Panel

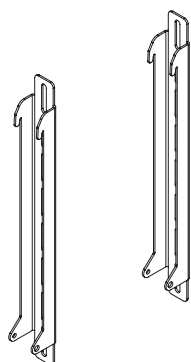

AV Mount Brackets

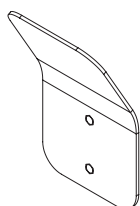

Wire Manager

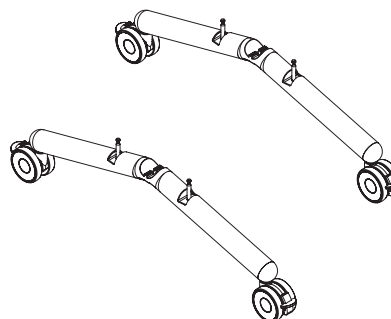

Mobile Leg Assembly

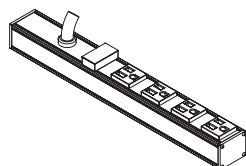

PDU (Optional)

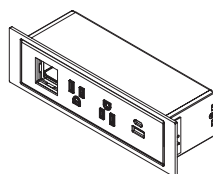

Power Module (Optional)

# 1. Secure Legs to Extrusion

Loosely secure the T-nut (PN 0002935) with the M8 screw (PN 0002870) through the center casting of each leg assembly. Slide the T-Nut and center casting of the leg assembly into the corresponding channel of the aluminum extrusion. This leg assembly will need to slide along the length of the extrusion into their final position in the case assembly. Do not tighten the screws fully in this step.

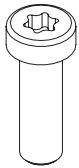

M8-1.25 x 25mm  
Screw, Low Head  
(0002870)  
(x2)

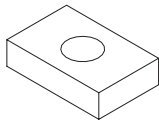

20 x 14 x 6mm  
Nut, Rectangular  
(0002935)  
(x2)

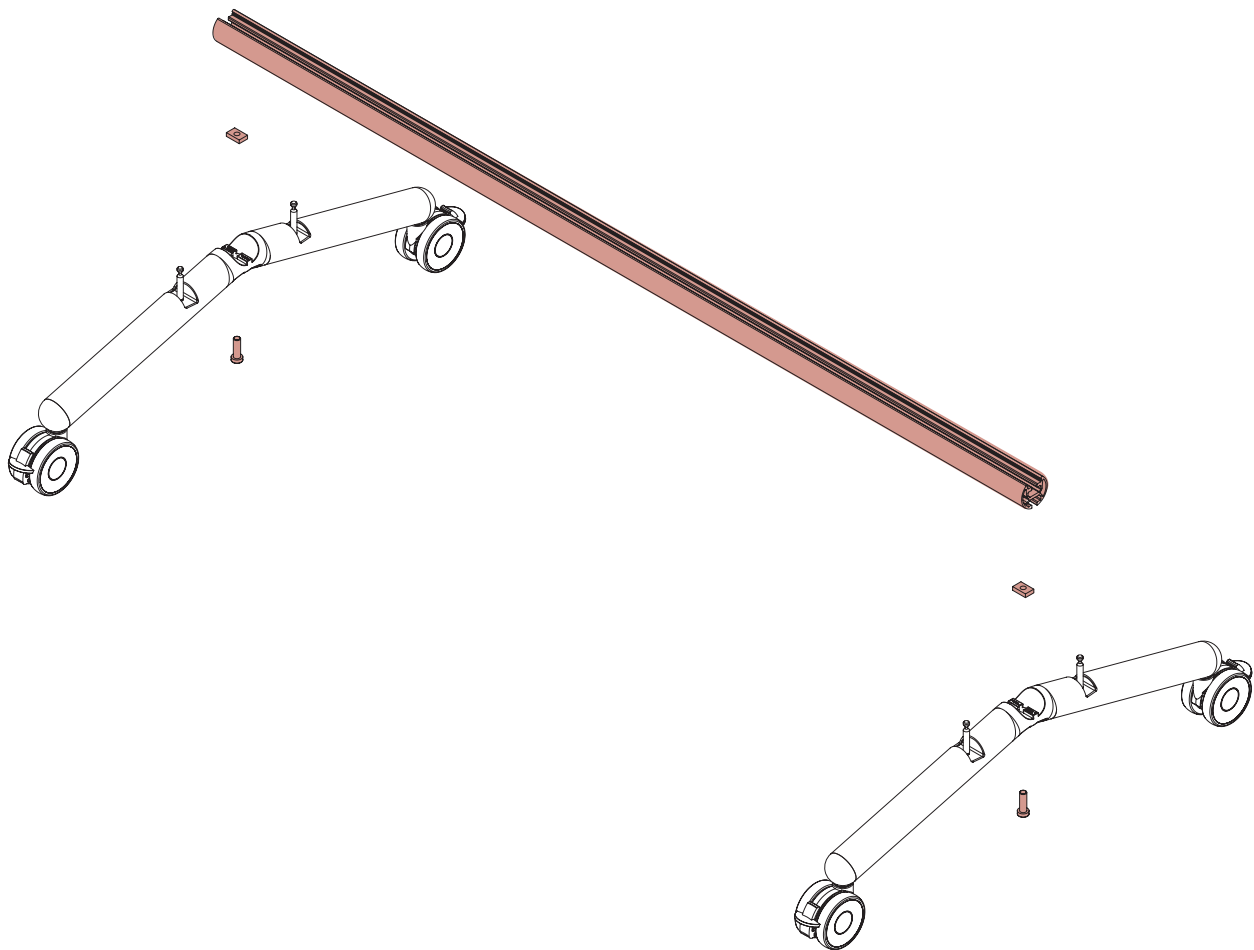

## 2. Insert Mobile Legs into Case Assembly

Slide the leg assemblies along the extrusion until they are aligned with the holes in the bottom of the lower panels. Insert each leg assembly into the lower panel holes. Insert a set screw (PN 0002791) into each housing (PN 0002790) in the lower case panel and fully tighten in place. Fully tighten the M8 screw in each leg assembly to secure it to the aluminum crossbar.



M8 8mm  
Screw, Cone Tip Set  
(0002791)

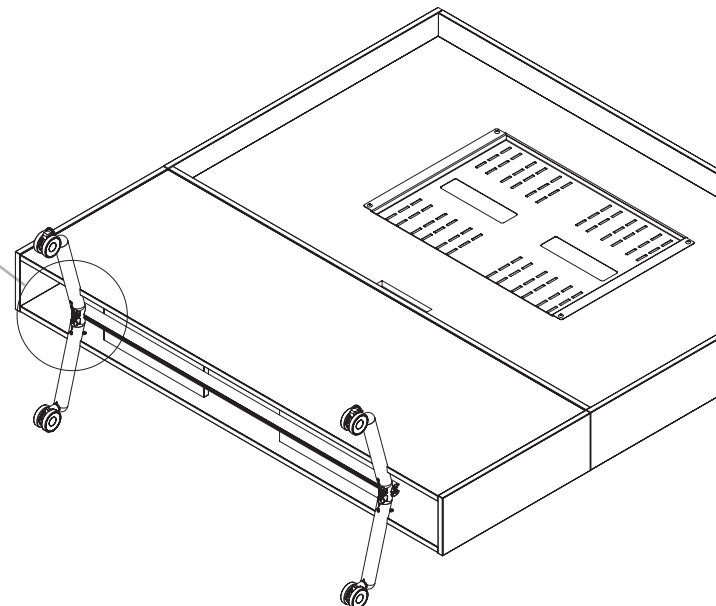
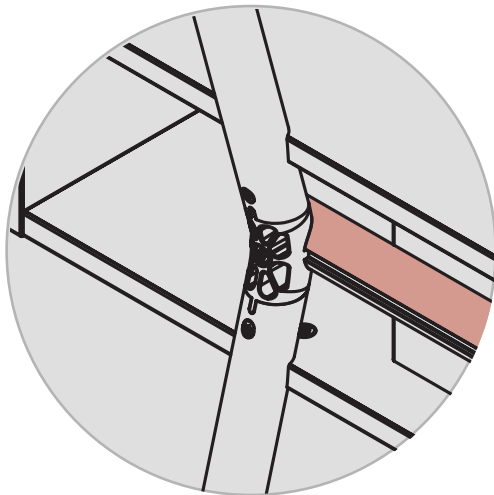
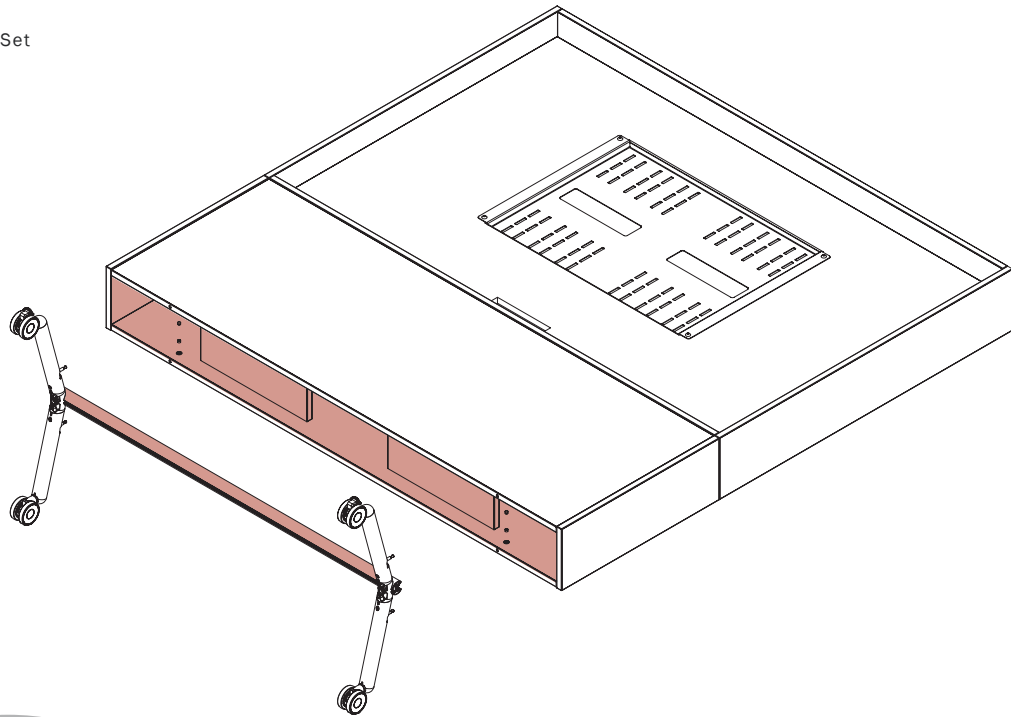

### 3. Attach the Cable Manager

Locate the two holes bored into the back of the lower case assembly. From the outside, feed the barrels of the internally threaded standoffs into the set of holes. From the inside, secure in place with QTY: 2 washers (PN 145000) and QTY: 2 M4 screws (PN 117016).

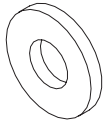

1/4 Flat Zinc  
Washer  
(145000)  
(x2)



M4 x 12mm PH Zinc  
Screw  
(117016)  
(x2)

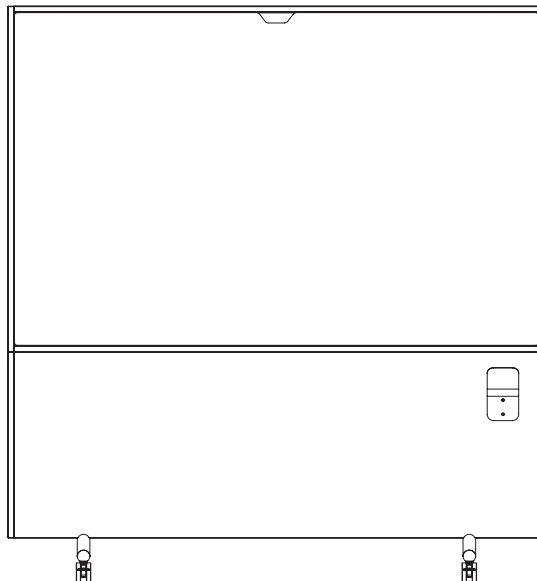
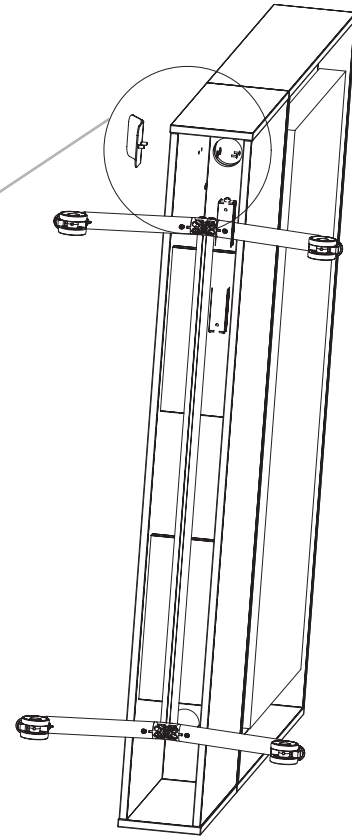
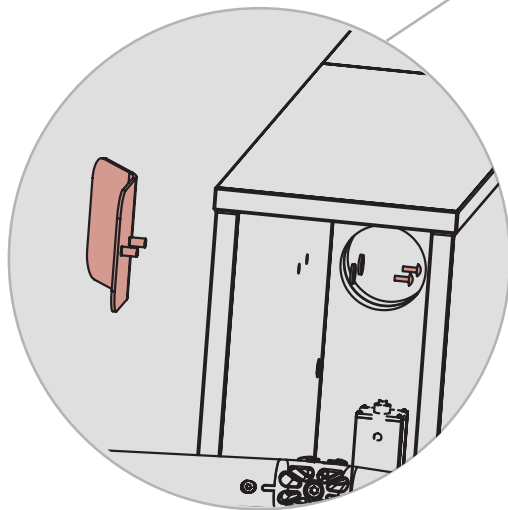

## 4. Install Optional Convenience Power

If convenience power is optioned, slide the Byrne power system through the slot in the center panel from the front side of the unit ensuring that the plug end goes through the slot first.

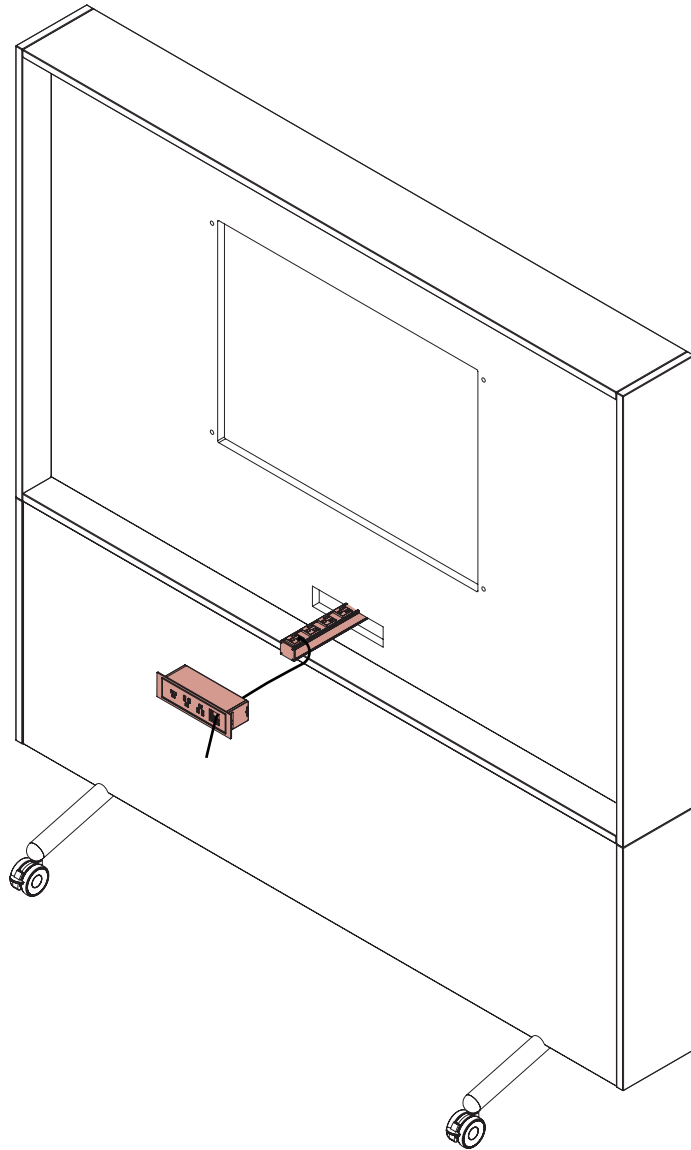

## 4b. Install Optional Convenience Power

Secure the in-surface convenience power unit by sliding the provided plastic pieces and glide into both ends of the extrusion channel. Hand tighten the glide knobs against the backside center panel until the unit is secured in place. Secure the utility power strip onto the backside horizontal panel with wood screws into the pilot holes provided. Route the plug end of the cable down the access cutout and wrap excess cable onto the cable manager.

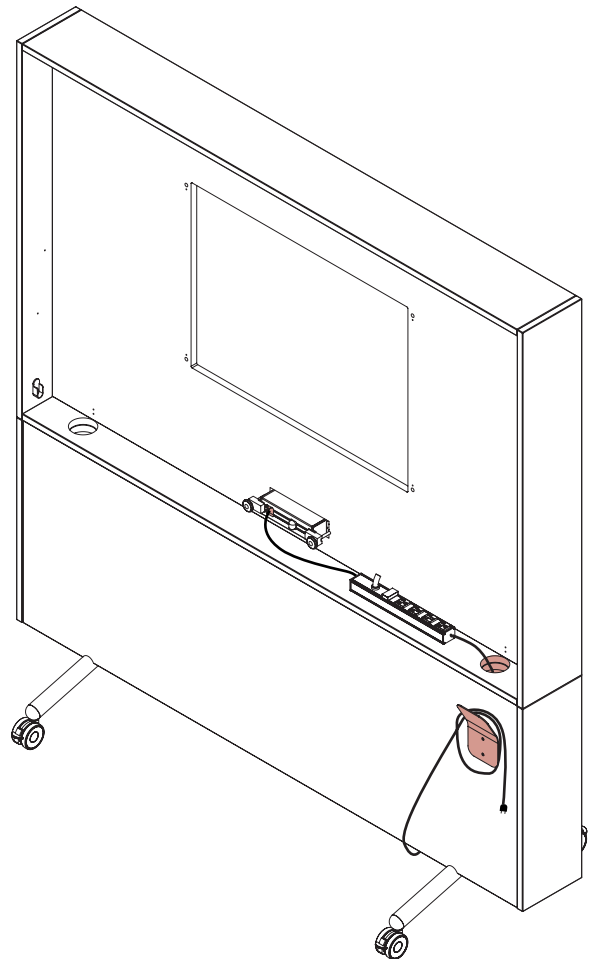
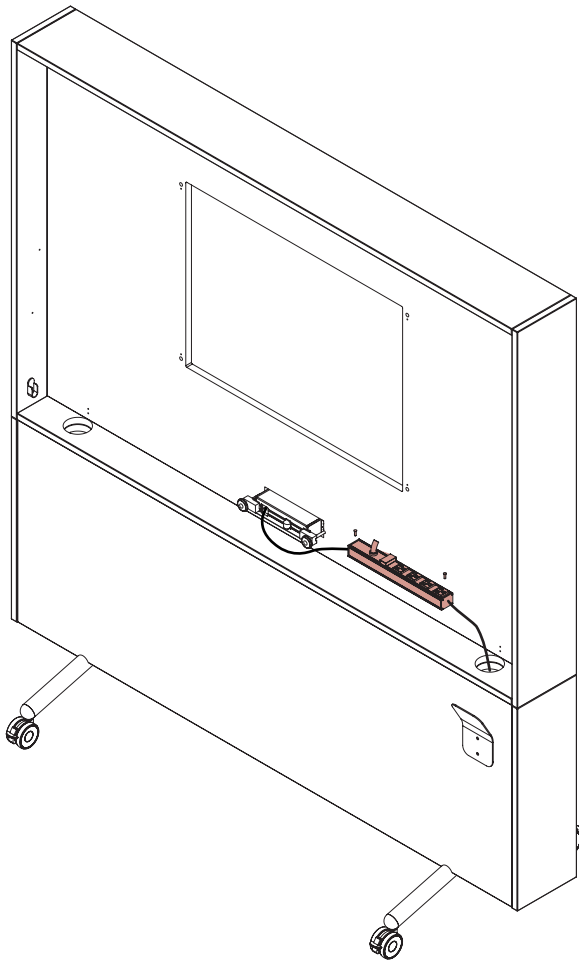



5.

### Attach Optional PDU

If in-surface power option is not selected, the unit will come standard with a 4-outlet PDU. Place the unit as close to the center panel as possible with the provided sections of adhesive tape. If the PDU is not placed close enough to the center panel, it will interfere with the closing of the removable fabric panel.

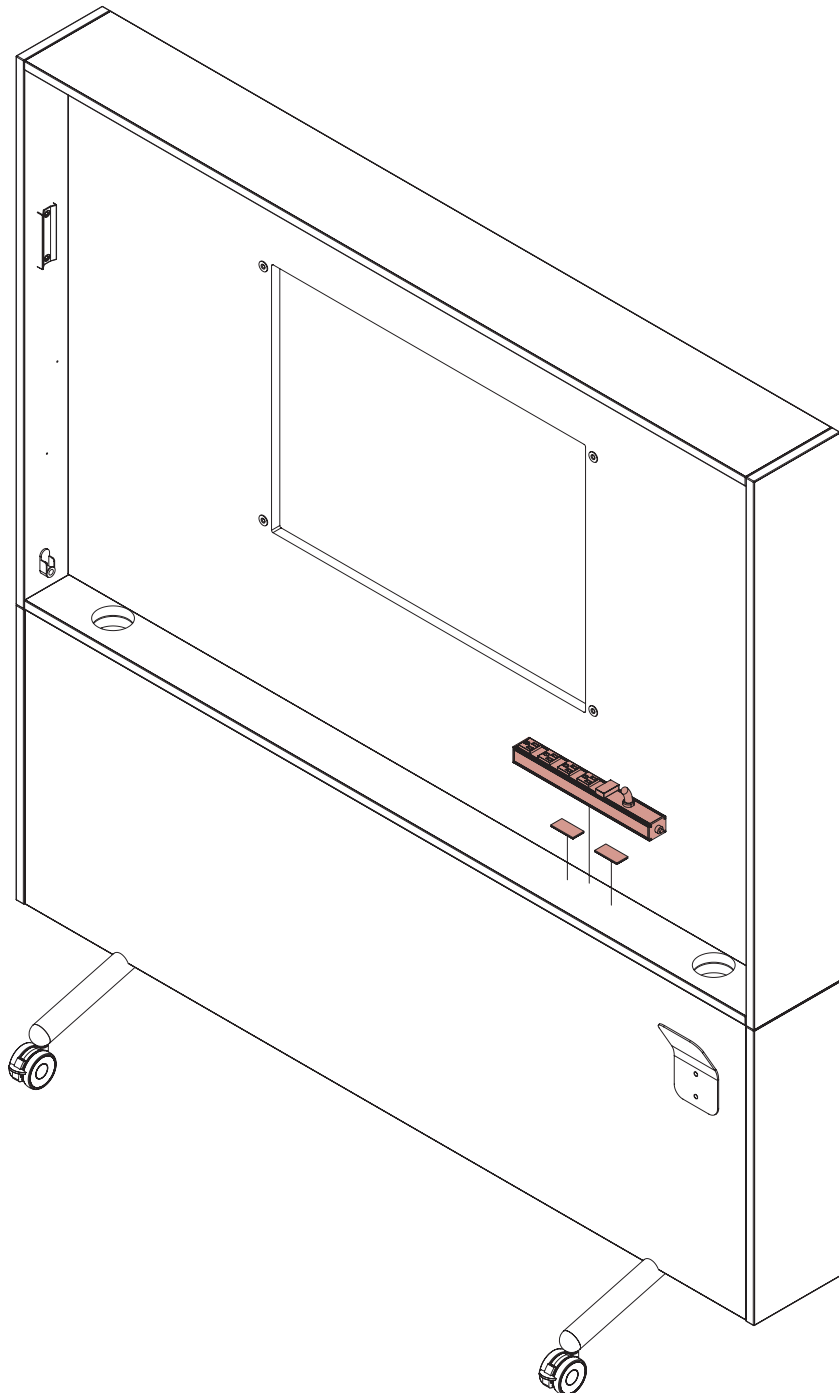

## 6. Attach Monitor Mount Brackets to Monitor

Secure the monitor mount brackets to the back of the monitor with the mounting hardware kit. Specific hardware and screw placement will vary based upon monitor brand. Align the brackets with the slots in the AV mount center bracket going straight toward the slot and carefully lowering until the brackets are seated.

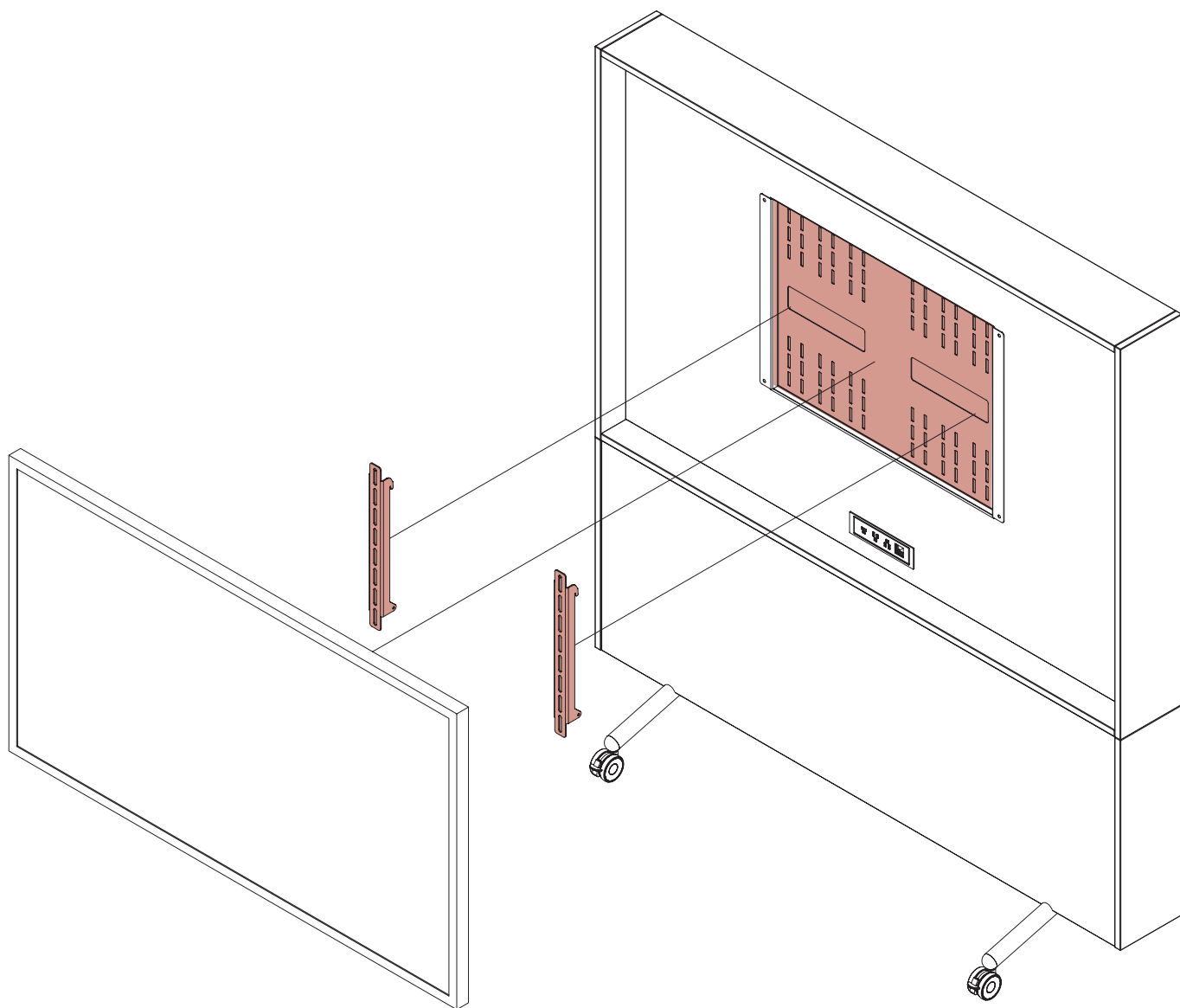

## 7. Secure Monitor Mount Bracket on Unit Backside

Remove the fabric panel from the backside of the monitor wall by rotating it outwards then lifting up and out of the hinge brackets. Secure the monitor mount brackets on the backside of the monitor wall using QTY: 2 of the 5/16-18 x 1 3/4" screws (PN 125040). Put the fabric panel back on by placing the hinges back in the brackets, rotating the panel inwards towards the unit and pressing the fittings together located at the top of the case.

