

ASSEMBLY

Allé Mobile Planter

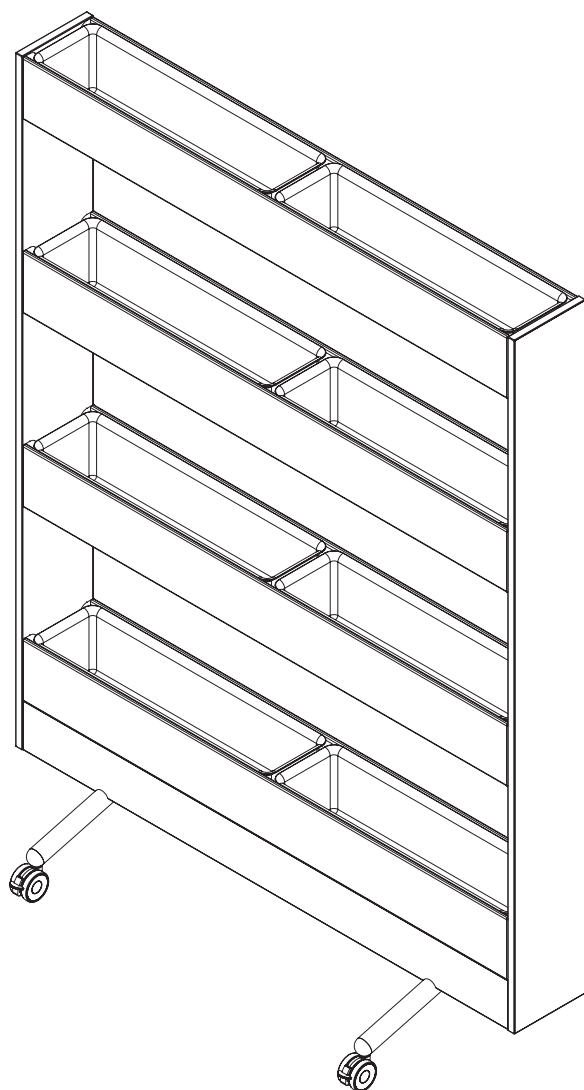

Hardware



8mm length
Screw, M8 Cone Tip Set
(0002791)

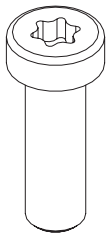

M8-1.25 x 25mm
Screw, Low Head
(0002870)

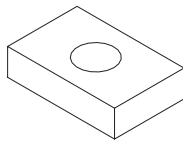

20 x 14 x 6mm
Nut, Rectangular
(0002935)

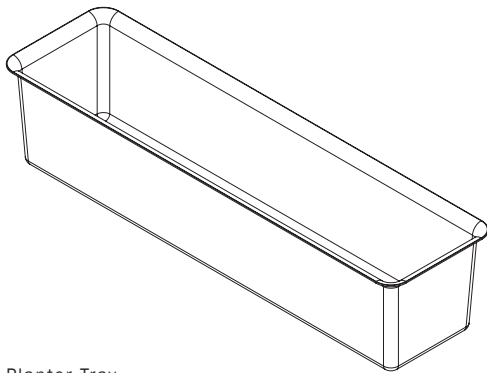

Planter Tray
Optional
(0002821)

Parts

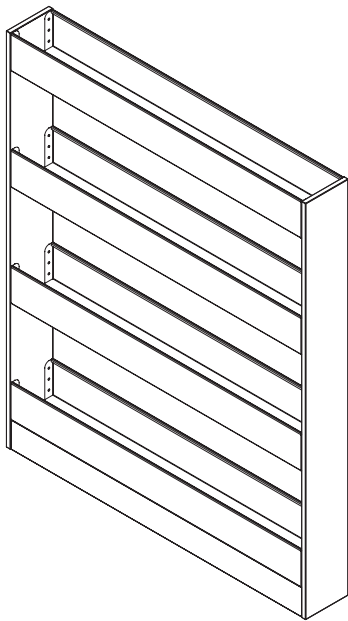

Planter Case Assembly

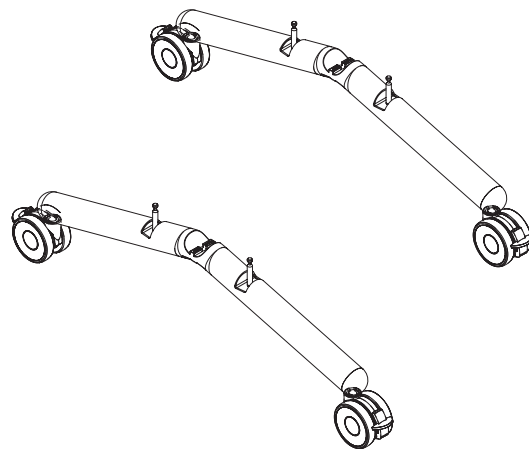

Mobile Leg Assembly

1. Secure Legs to Extrusion

Loosely secure the T-nut (PN 0002935) with the M8 screw (0002870) through the center casting of each leg assembly. Slide the T-nut and center casting of the leg assembly into the corresponding channel of the aluminum extrusion. The leg assembly will need to slide along the length of the extrusion into their final position in the case assembly. Do not tighten the screws fully in the step.

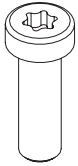

M8-1.25 x 25mm
Screw, Low Head
(0002870)
(x2)

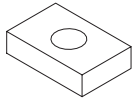

20 x 14 x 6mm
Nut, Rectangular
(0002935)
(x2)

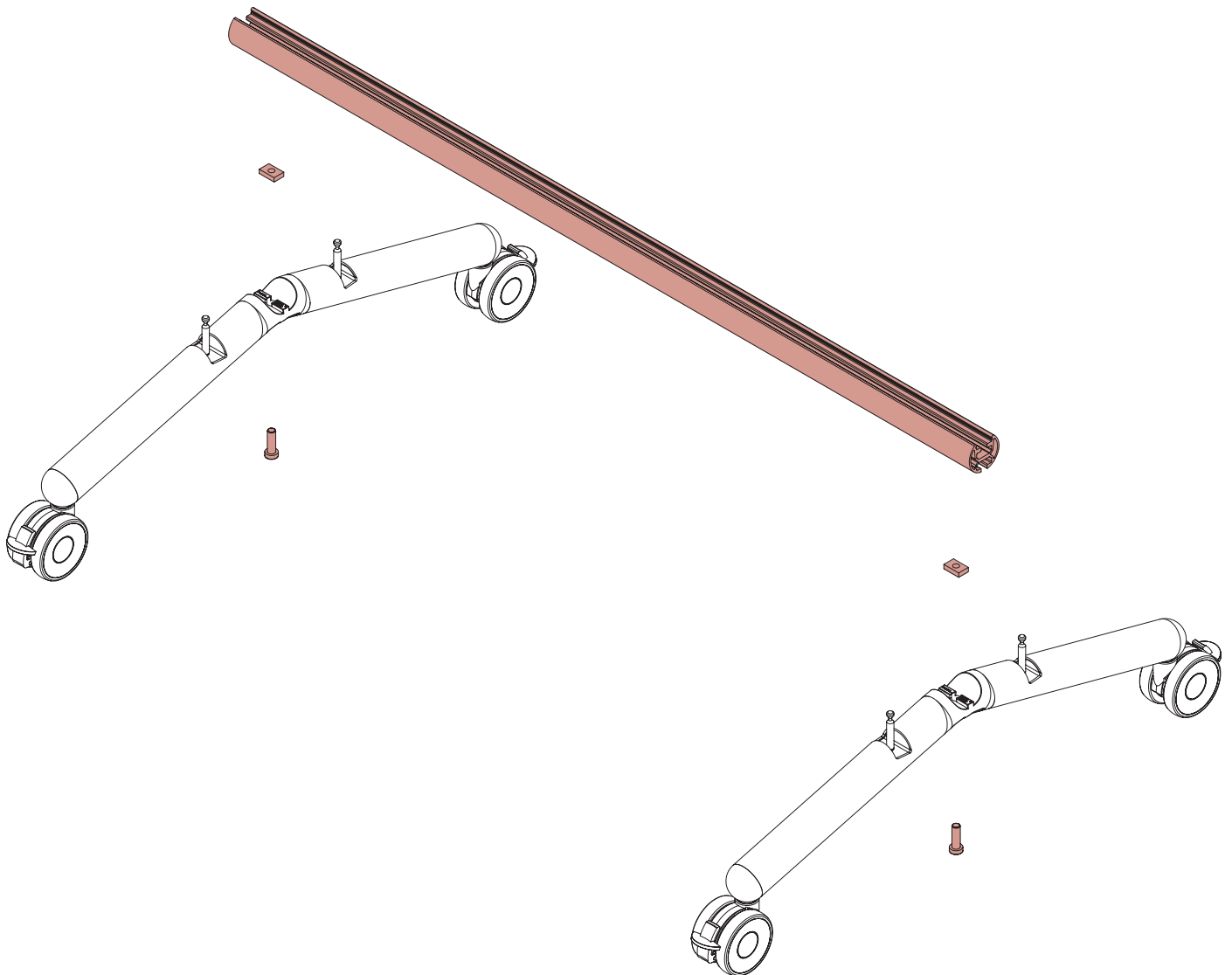

2. Insert Mobile Legs into Case Assembly

Slide the leg assemblies along the extrusion until they are aligned with the holes in the bottom of the lower panels. Insert each leg assembly into the lower panel holes. Insert a set screw (PN 0002791) into each housing (PN 0002790) in the lower case panel and fully tighten in place. Fully tighten the M8 screw in each leg assembly to secure it to the aluminum crossbar.

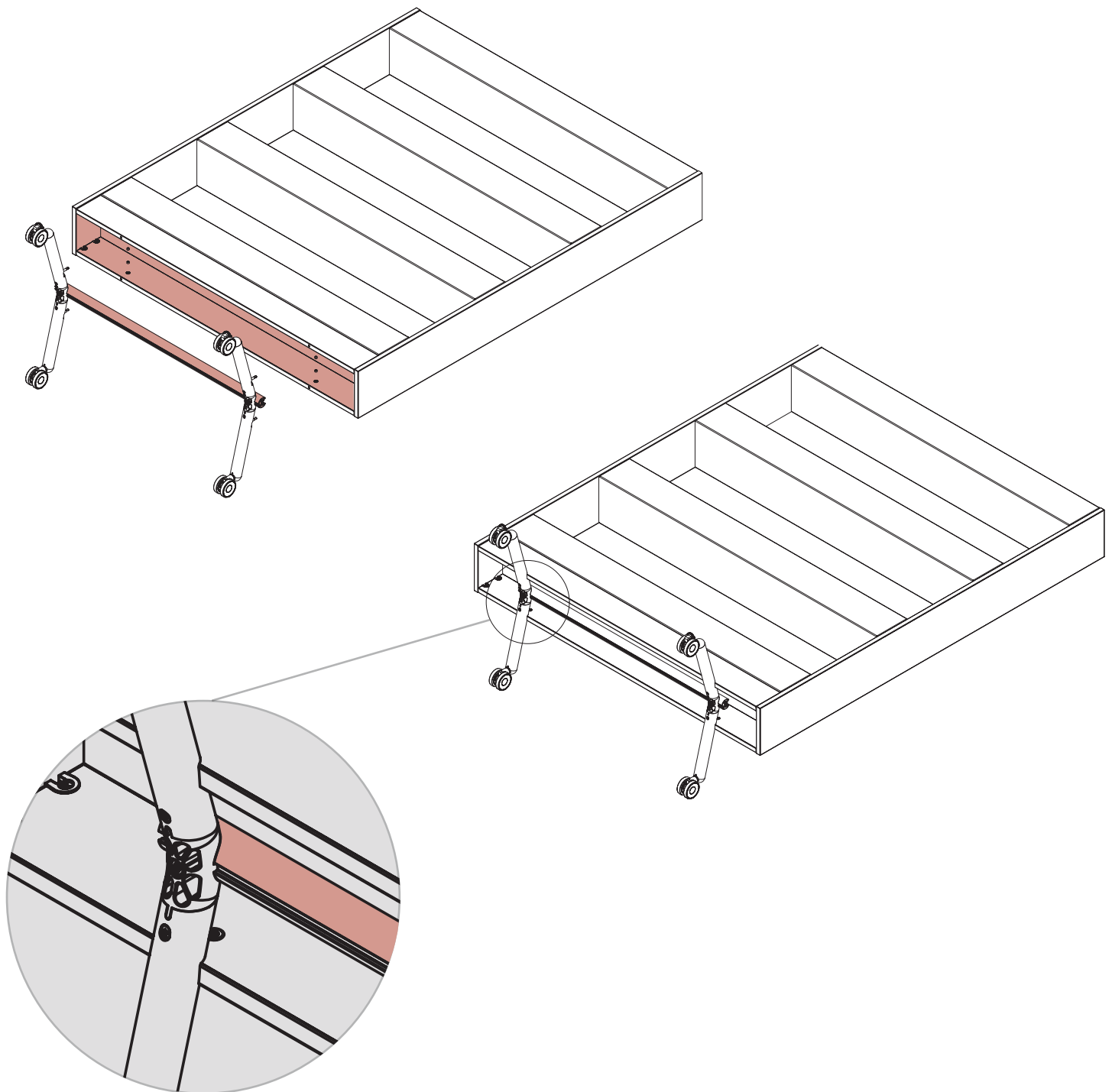

3. Place Planter Trays into Troughs

If optioned with plastic planter trays, place QTY: 2 into each trough level of the planter assembly..

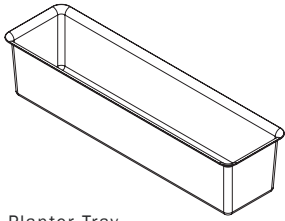

Planter Tray
Optional
(0002821)
(x6-8)

