

ASSEMBLY

Haven Recharge Bench



View Digitally

Recharge Bench Components

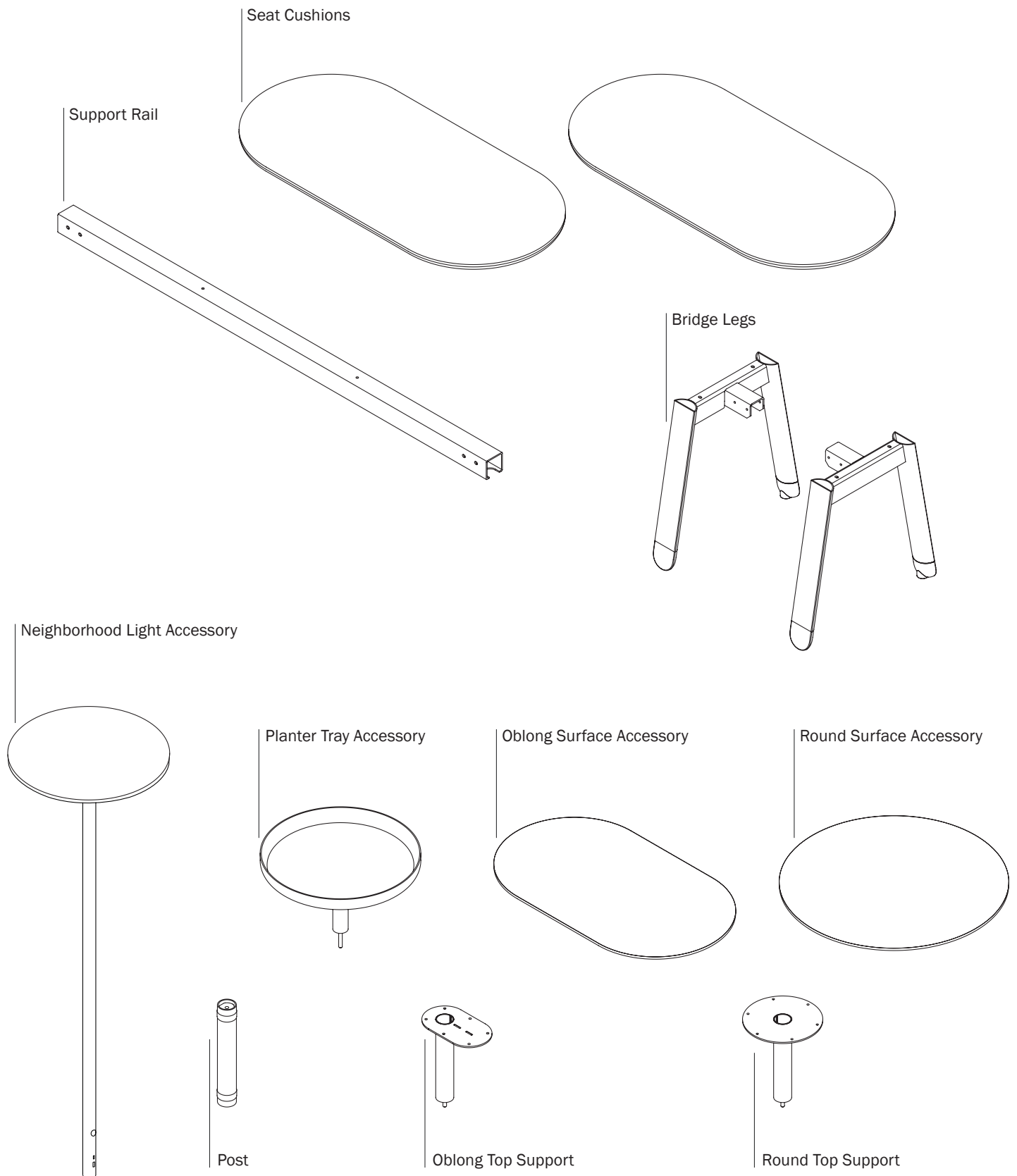

Hardware

Main Bench Hardware

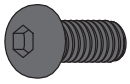

M6-1.0 X 12mm
(125285)

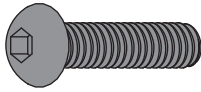

1/4 - 20 X 7/8"
Button Head Screw
(0000750)



#6 X 3/4" Pan Head
Screw (122500)

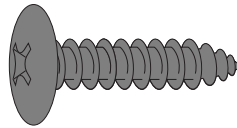

10 X 3/4" Pan
Head Screw
(122875)

Planter Tray Accessory Hardware

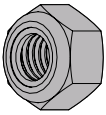

M8 Nylock Nut
(0001248)

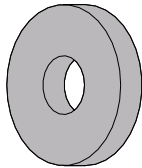

M8 Washer, 23mm
OD (0001567)

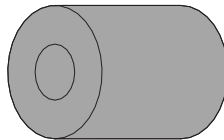

M8 1" Spacer
(0002196)

Oblong Surface Accessory Hardware

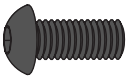

M8 X 20MM
Button Head Screw
(0000752)



Washer, Split 5/16
(147550)

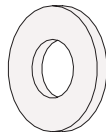

M8 Plastic Washer
(0002165)

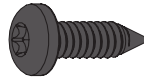

#10 X 5/8 Pan Head
Screw (0002148)

Round Surface Accessory Hardware



#10 X 5/8 Pan Head
Screw (0002148)

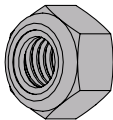

M8 Nylock Nut
(0001248)

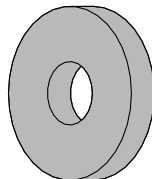

M8 Washer, 23mm
OD (0001567)

Neighborhood Light Accessory Package

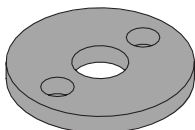

Mounting Washer

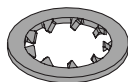

Locking Washer

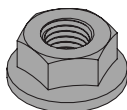

Mounting Nut

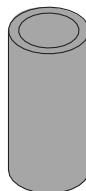

Spacer (used
only for the
bench assembly)

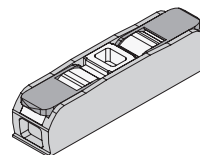

Wire Splice
Connector

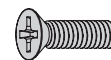

Flat Head
Machine Screw
8-32 X 14mm

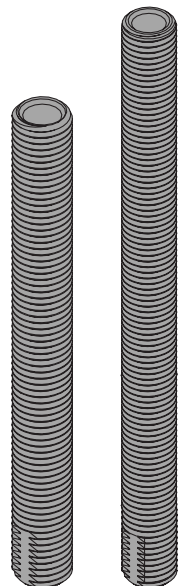

Light Rod 60mm
(used for bench and
table surface only)

Light Rod 100mm
(used for rail assembly
only)

Tools

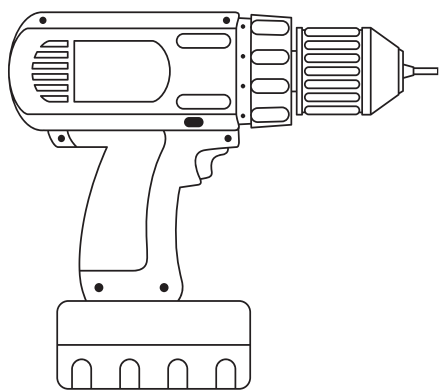

Electric Drill



T25 Torx Bit



4mm Hex Bit



5mm Hex Bit



Phillips Bit

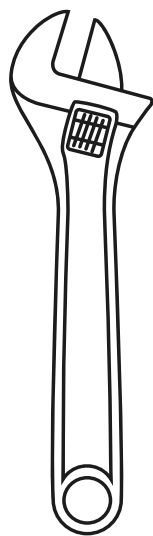

Adjustable Wrench



13mm Wrench

1. Assemble Bench Base

Place the support rail on a soft surface with the large slots facing up. Slide each bridge leg into the ends of the support rail and secure with (4) screws each.

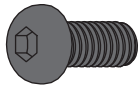

M6-1.0 X 12mm
(125285)

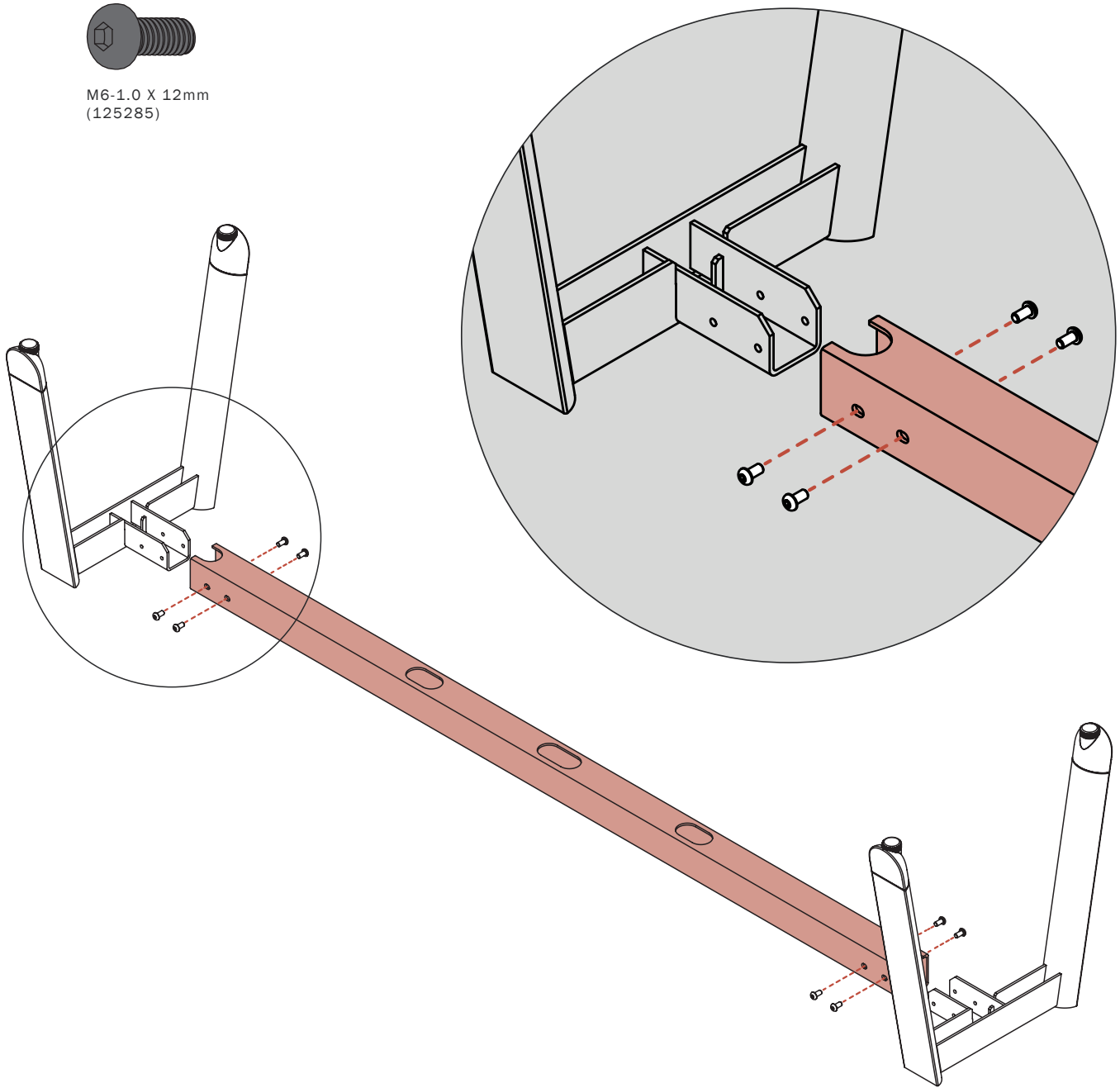

2. Attach Seat Cushions to Base

Place the cushions under the base. For each cushion, align the three holes in the base with the appropriate pilot holes in the cushion. Drive (3) screws per side.

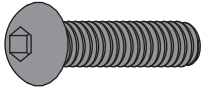

1/4 - 20 X 7/8"
Button Head Screw
(0000750)

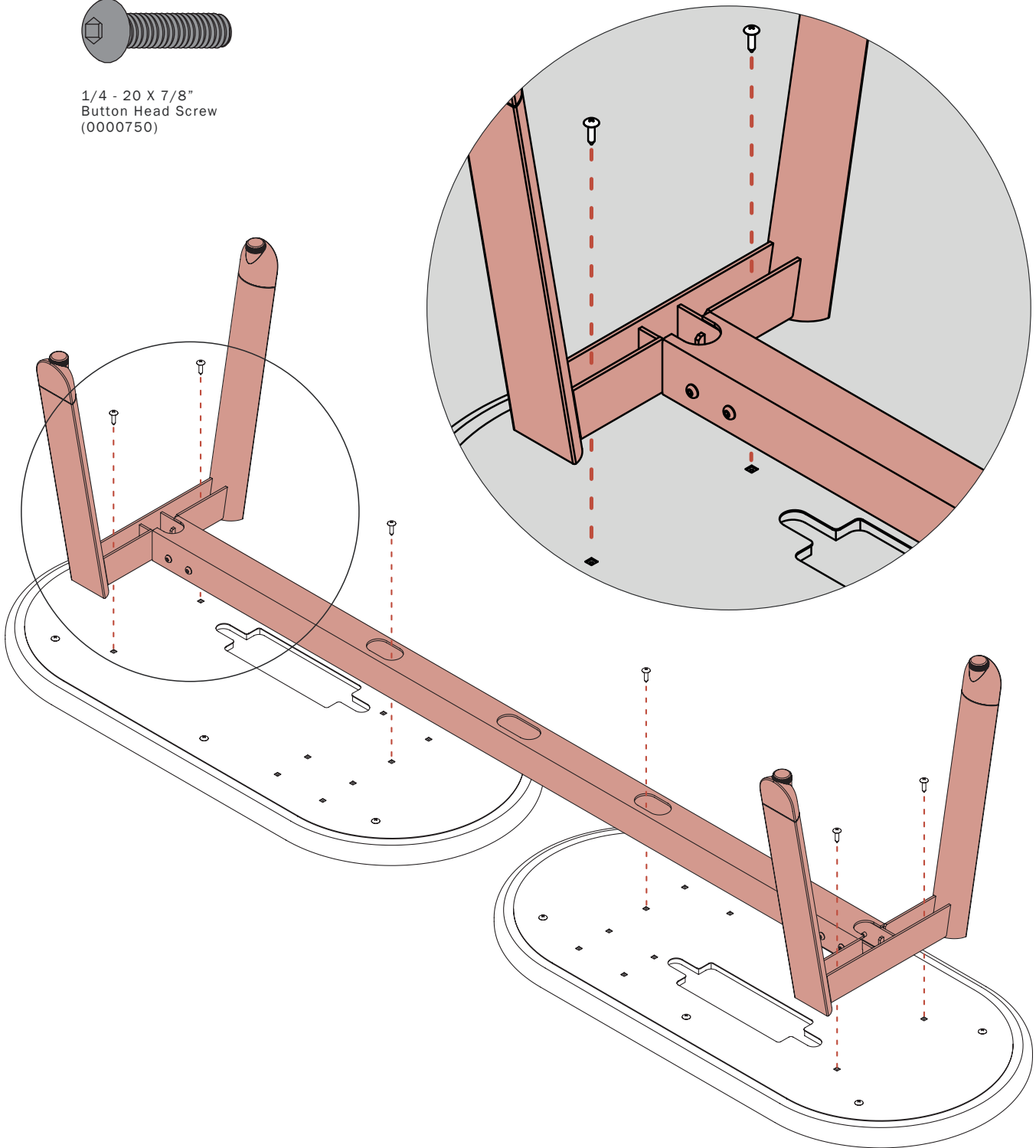

3. Optional Power Unit

The optional power unit can be mounted on either side of the bench. Locate the four pilot holes on the underside of the seat cushion that the power unit will mount to. Slide the power unit into the bracket so the four holes line up. Align the assembly with the pilot holes in the cushion, and secure the power unit with (4) screws. Run the power cord through the nearest oblong cutout in the support tube, and out the end of the side closest to a wall outlet. Plug the power cord in.



#6 X 3/4" Pan Head
Screw (122500)

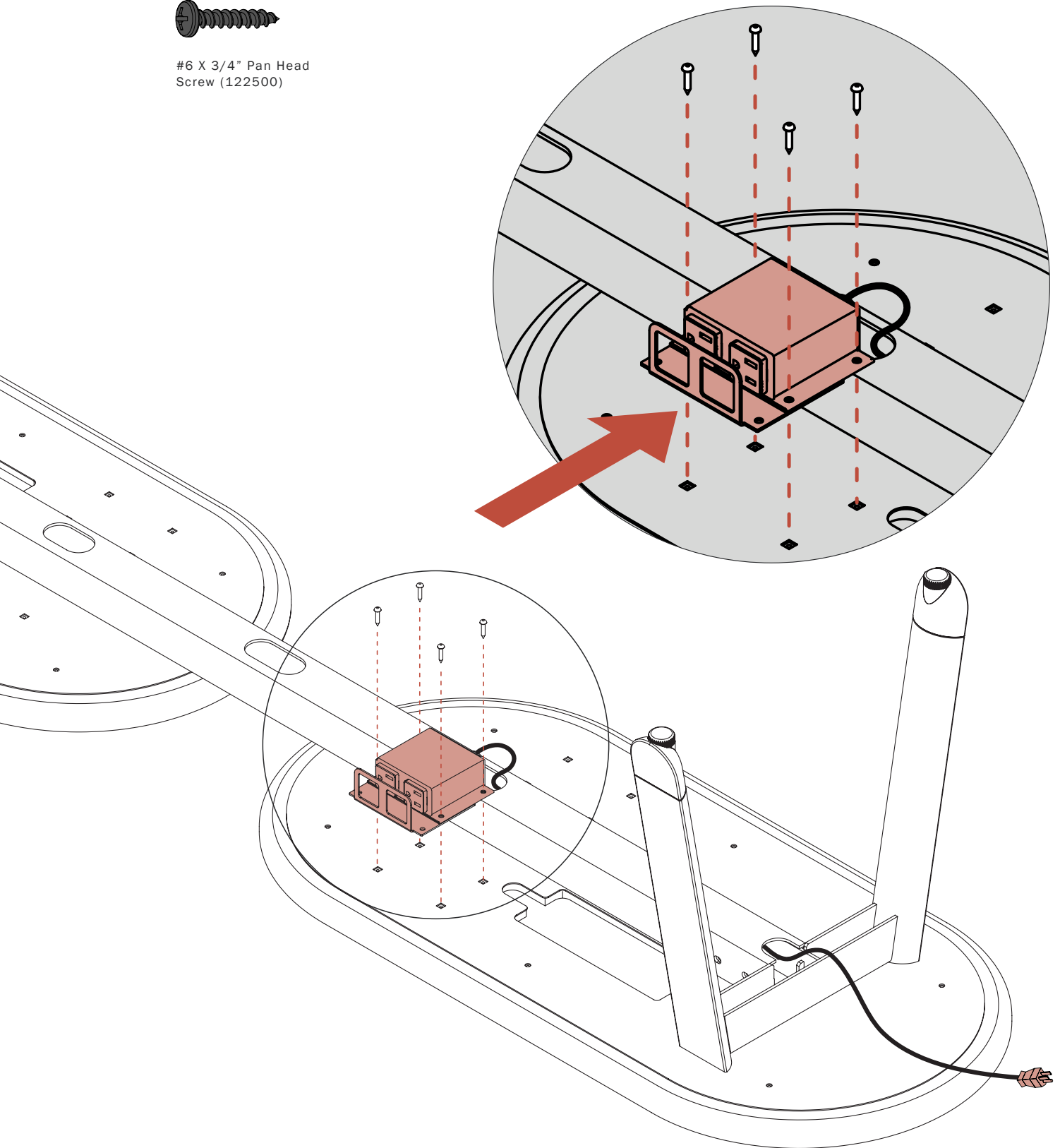

5. Optional Oblong Surface

Attach post (a.) to bench from below with button head screw (0000752) and split washer (147550). Tighten with 5mm hex bit to secure. Secure table support (b.) to top of post using a button head screw (0000752) and a M8 plastic washer (0002165) - hand tighten and leave loose.

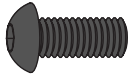

M8 X 20MM
Button Head Screw
(0000752)



Washer, Split 5/16
(147550)

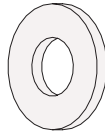

M8 Plastic Washer
(0002165)

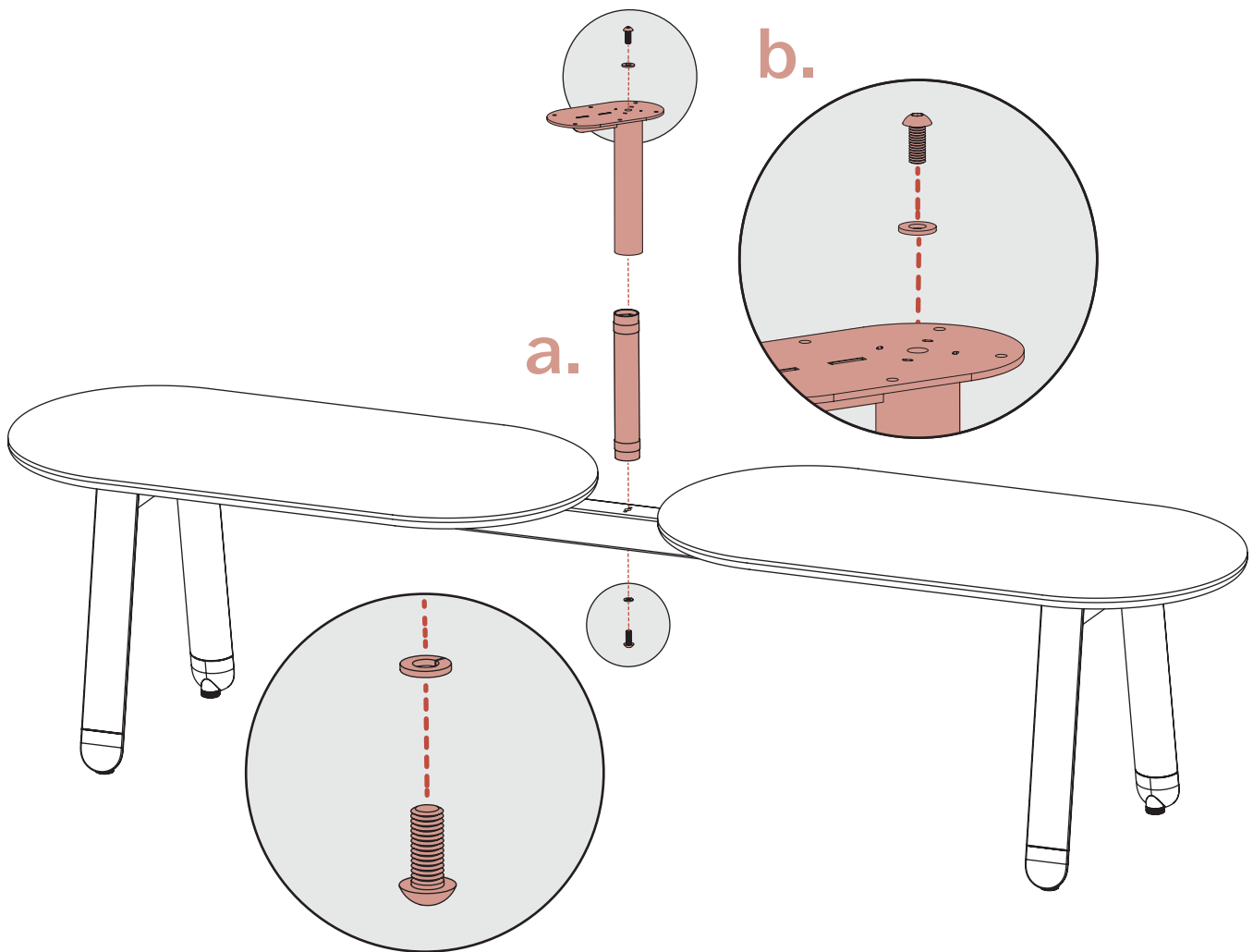

5. Optional Oblong Surface

Place the Oblong Surface on the mounting plate and stem by aligning the plate to the holes, making sure the table stem is justified to the outside of the table. Secure the plate with (6) screws (0002148).

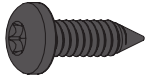

#10 X 5/8 Pan Head
Screw (0002148)

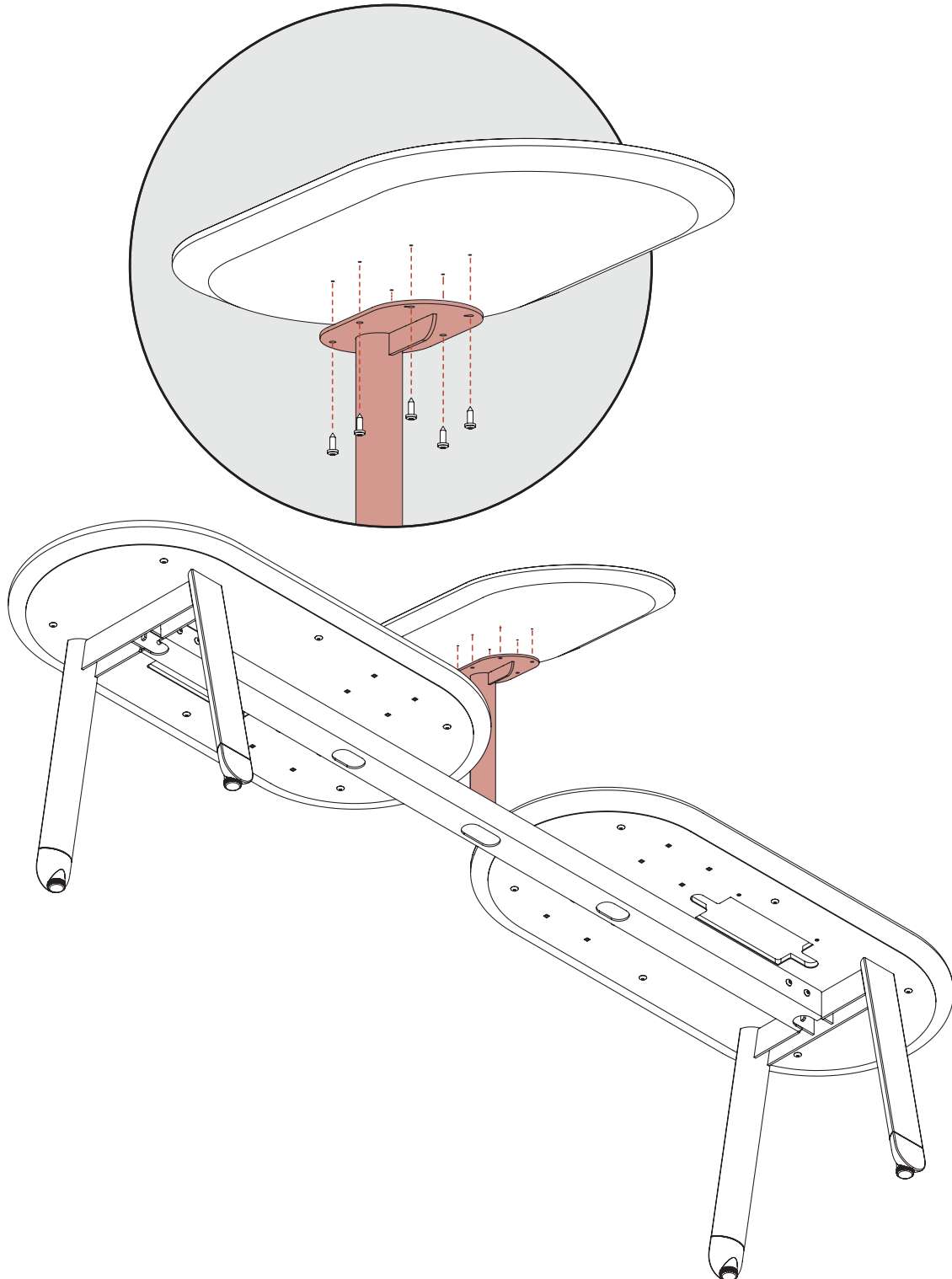

4. Optional Planter Tray

Place the Planter Tray stem through the center hole in the support rail of the bench. From the underside of the support Rail, slide the spacer (0002196) and washer (0001567) onto the stem of the Planter Tray, and spin the nut (0001248) onto the stem by hand. Use a wrench or socket to fully tighten the nut and secure the Planter Tray.

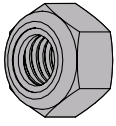

M8 Nylock Nut
(0001248)

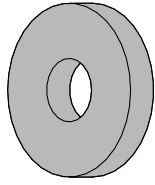

M8 Washer, 23mm
OD (0001567)

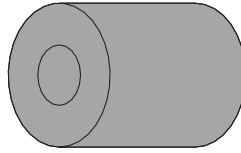

M8 1" Spacer
(0002196)

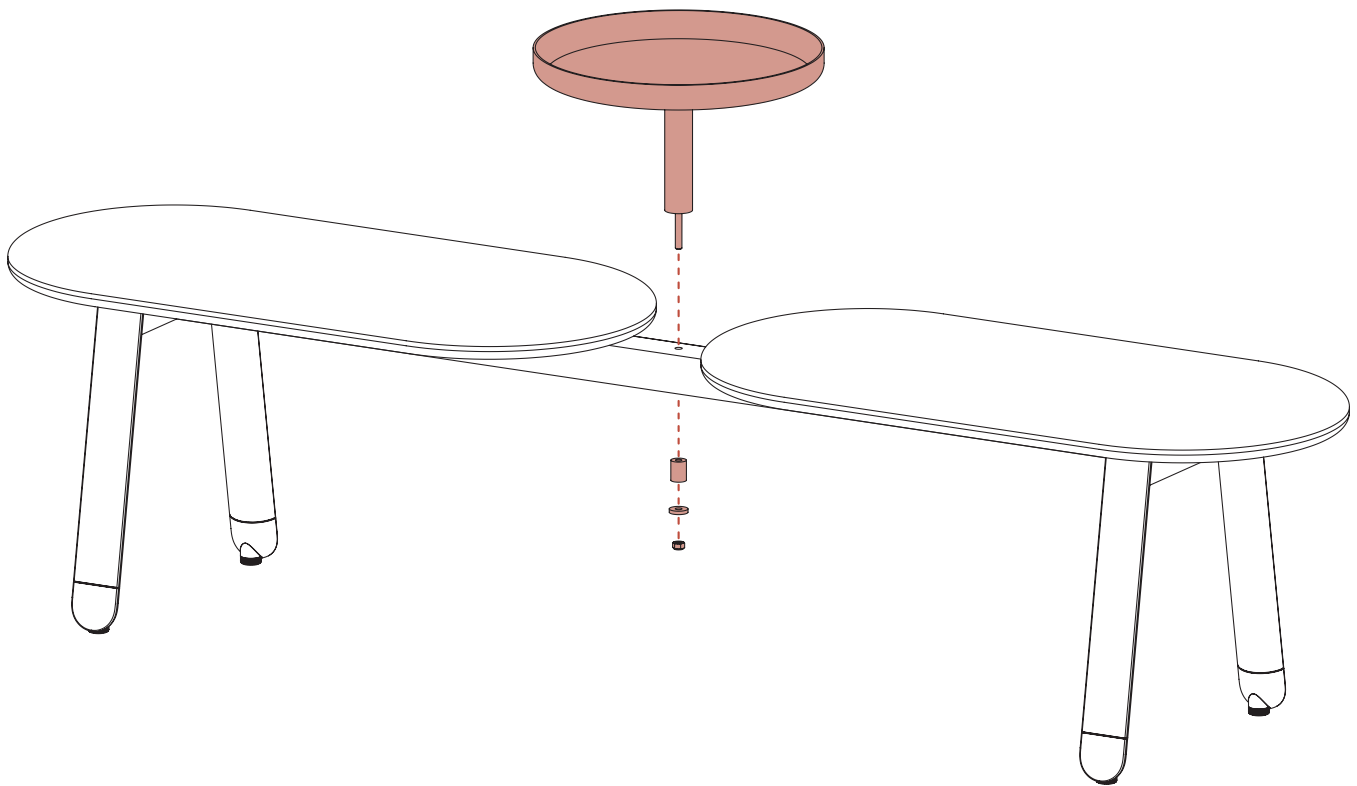

6. Optional Round Surface

Place the Round Surface upside down on a soft surface. Attach the mounting plate and stem by first placing the plate in the dado. Secure the plate with (6) screws (0002148) (a.). Place the table assembly through the center hole in the support rail of the bench. From the underside of the support rail, slide the washer (0001567) onto the stem of the table and spin the nut (0001248) onto the stem by hand. Use a socket to fully tighten the nut and fully secure the Round Surface (b.).

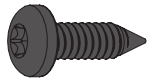

#10 X 5/8 Pan Head
Screw (0002148)

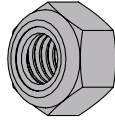

M8 Nylock Nut
(0001248)

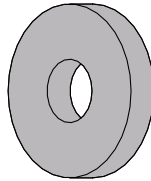

M8 Washer, 23mm
OD (0001567)

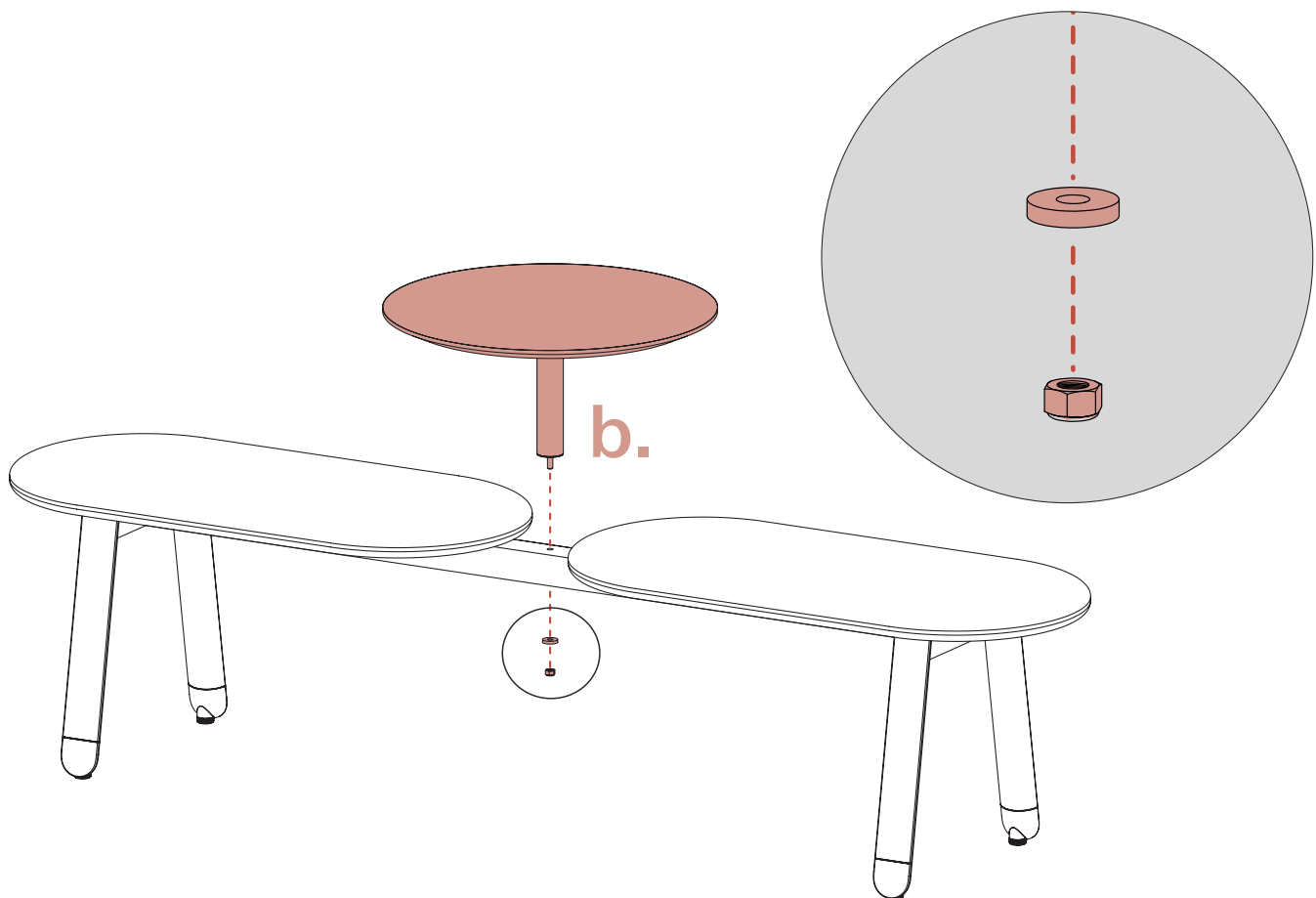
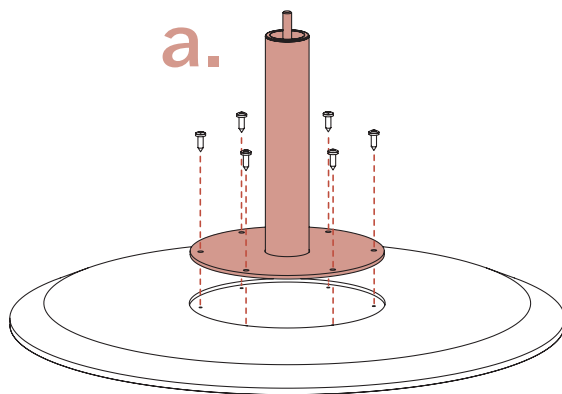

7. Optional Neighborhood Light: Attach Light Rod

Pass the cables in the light stem through the light rod (a.) and slide the light rod over the cable and up to the light stem (b.). Screw the light rod into the threaded plate in the light stem, and use the flat sections on the end of the light rod to tighten fully into the bottom of the lamp (c.).



Light Rod 60mm

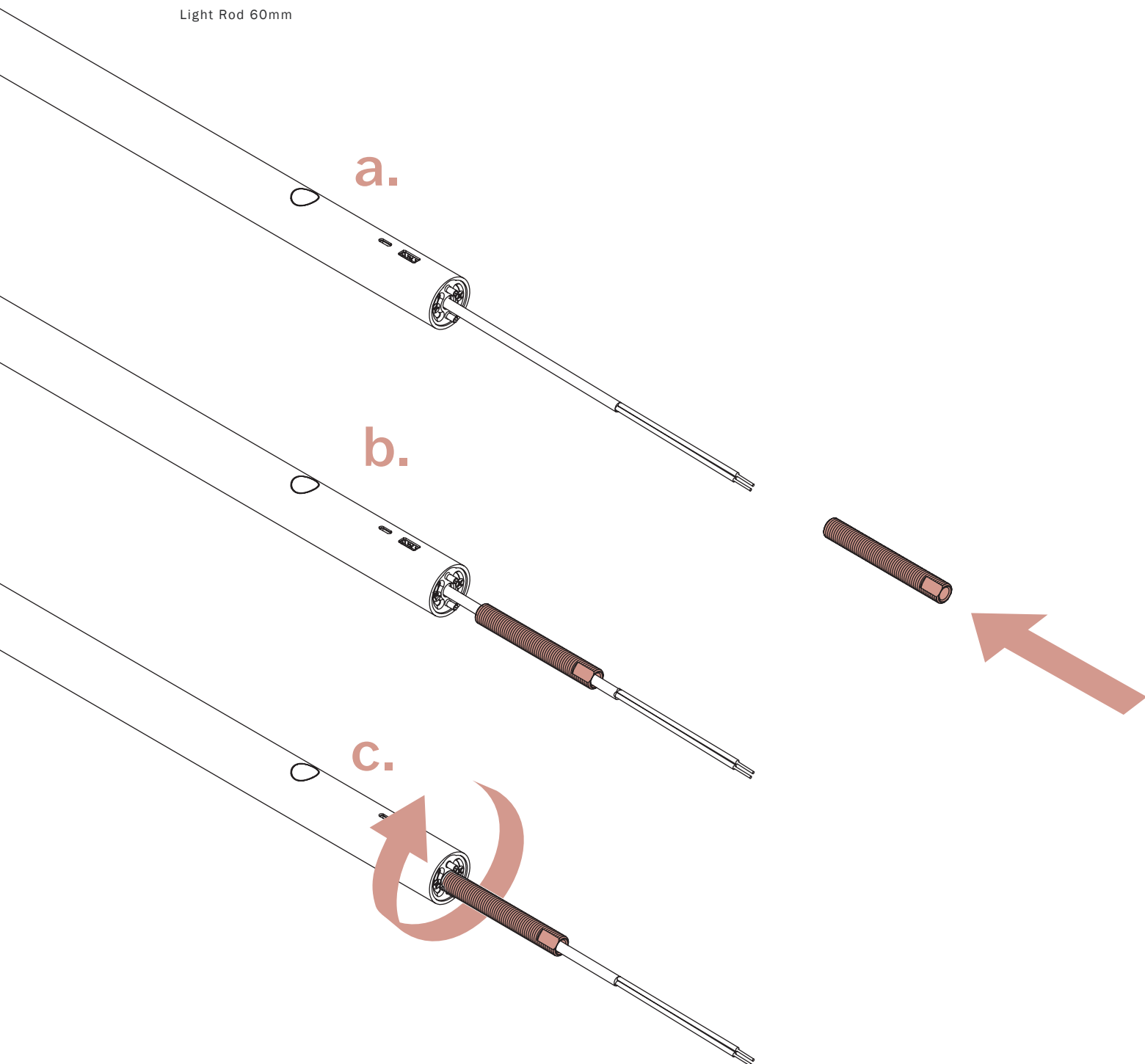

8. ~~Optional~~ Neighborhood Light: Position Light

Pass the cables through the hole in the bench and insert the light rod into the mounting hole. Position the light stem so the alignment pins go through the alignment holes in the bench frame.

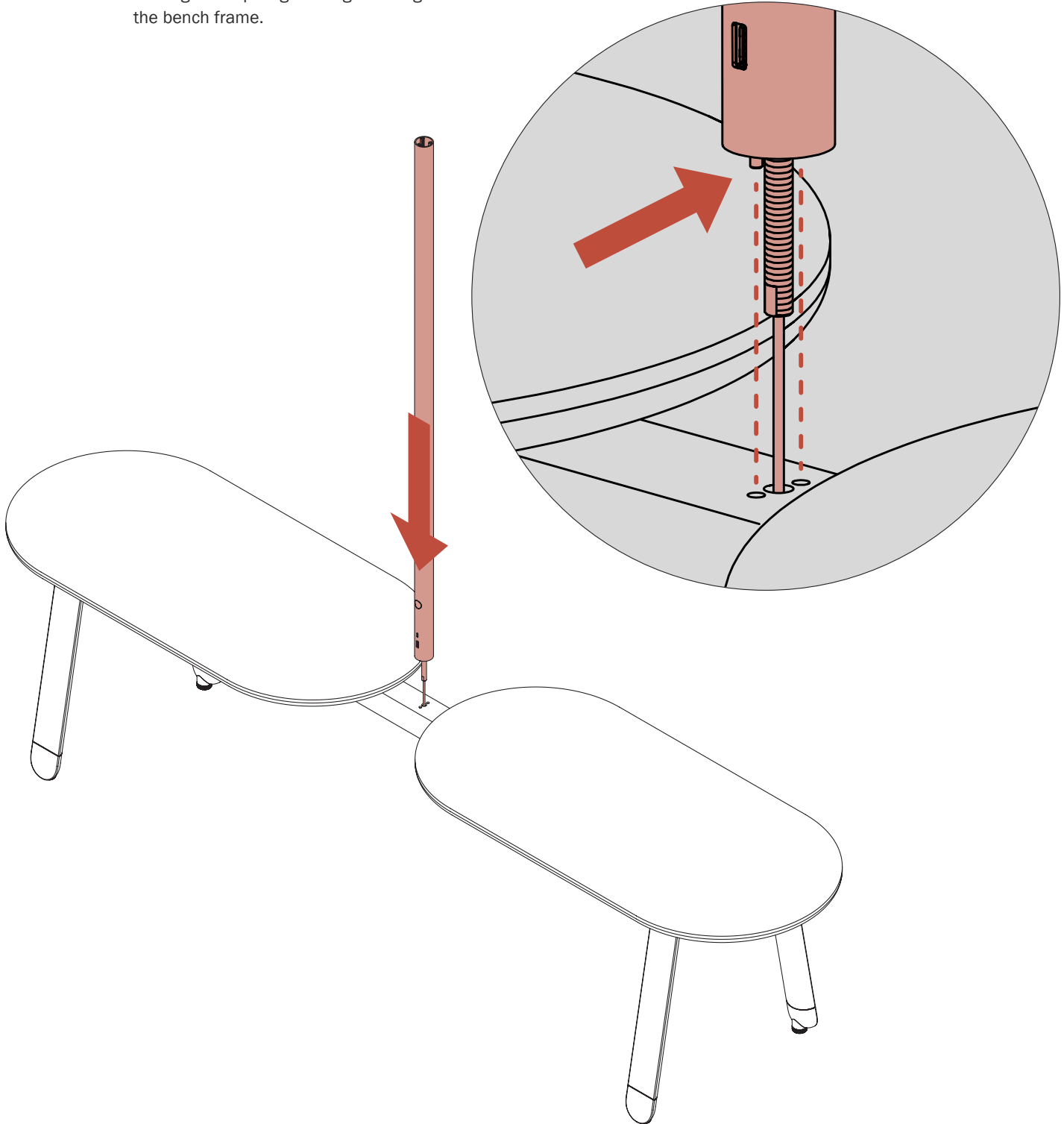

9. Optional Neighborhood Light: Secure Light Stem

Pass the cables through the mounting washer, spacer, lock washer, and mounting nut and secure the stem to the bench frame by tightening the mounting nut.

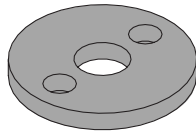

Mounting Washer

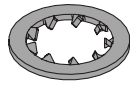

Locking Washer

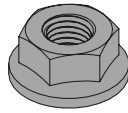

Mounting Nut



Spacer (used only for the bench assembly)

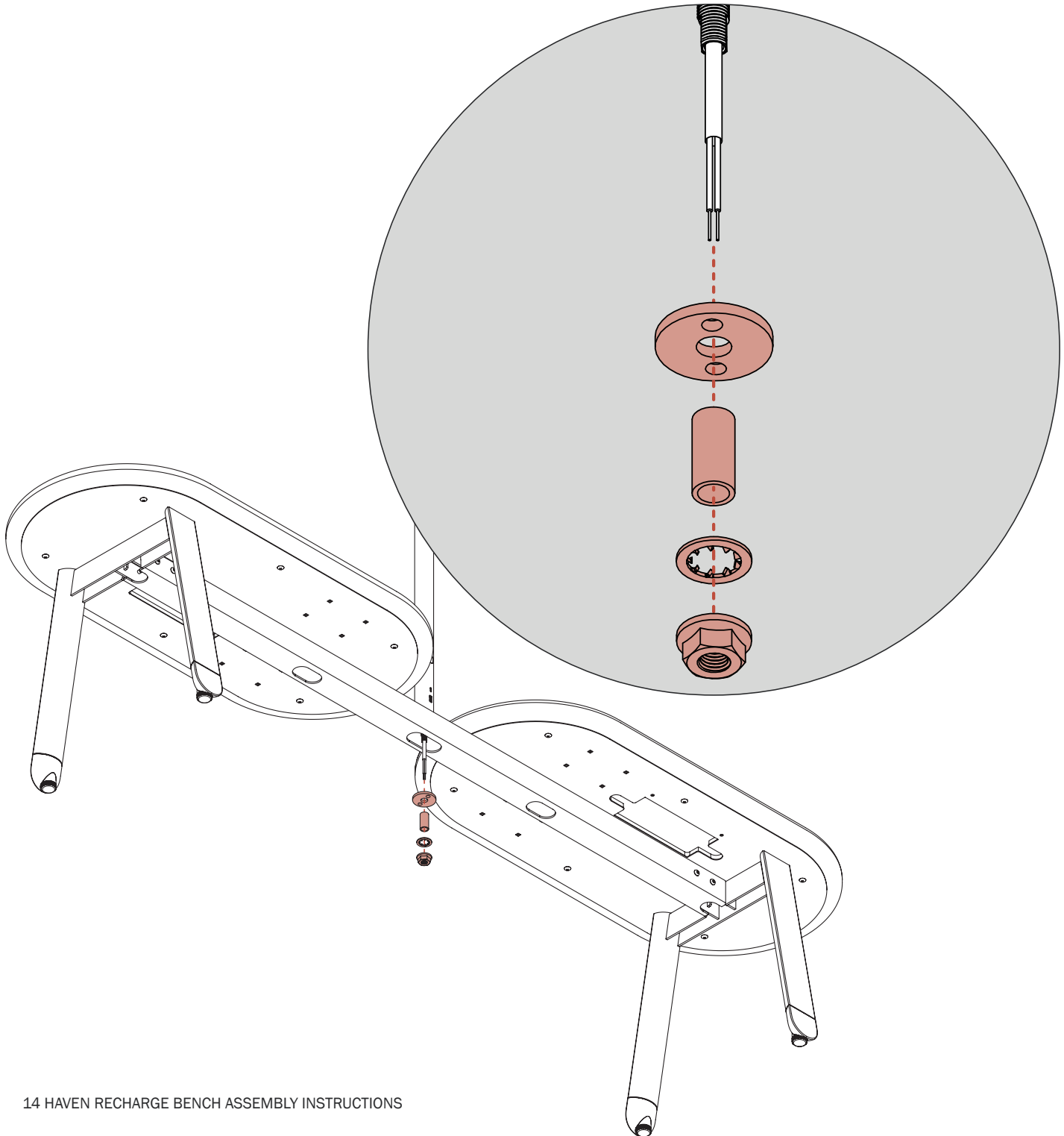

10. ~~Distal~~ Distal Neighborhood Light: Attach Light

Plug the connector from the light disc into the connector from the stem (a.) and feed the excess cable down into the stem. Secure the light disc to the stem using (3) flat head screws (b.).



Flat Head Machine
Screw
8-32 X 14mm

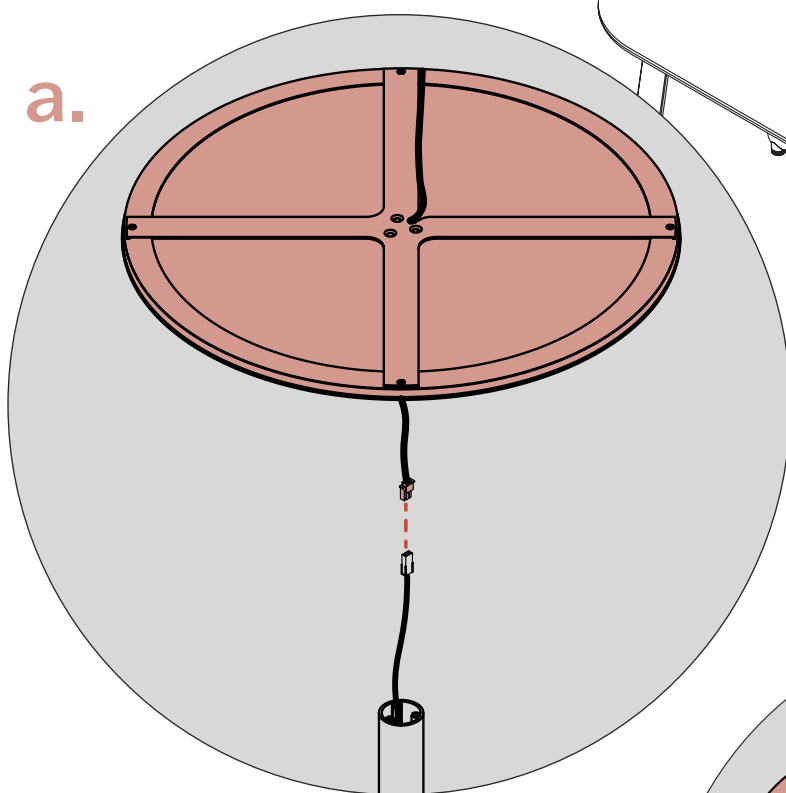

b.

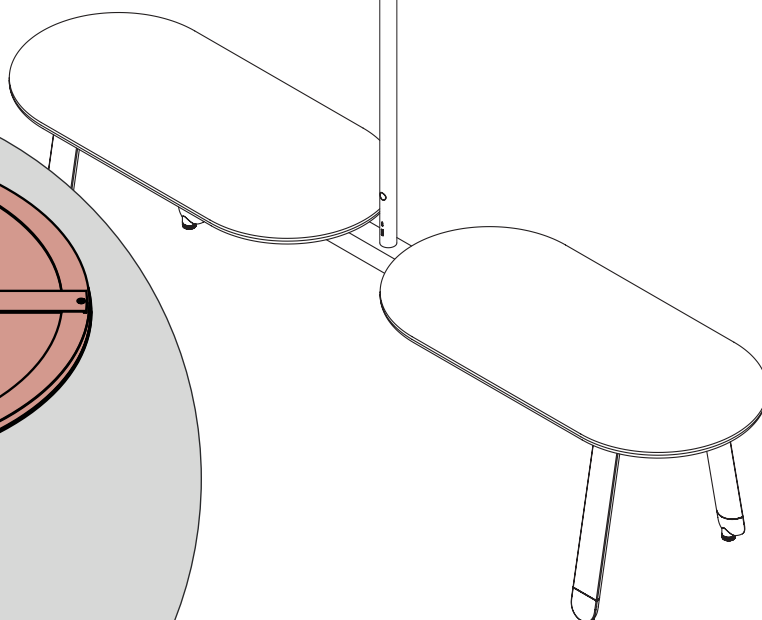
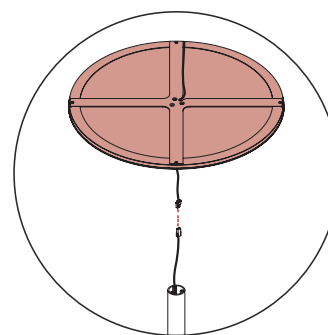
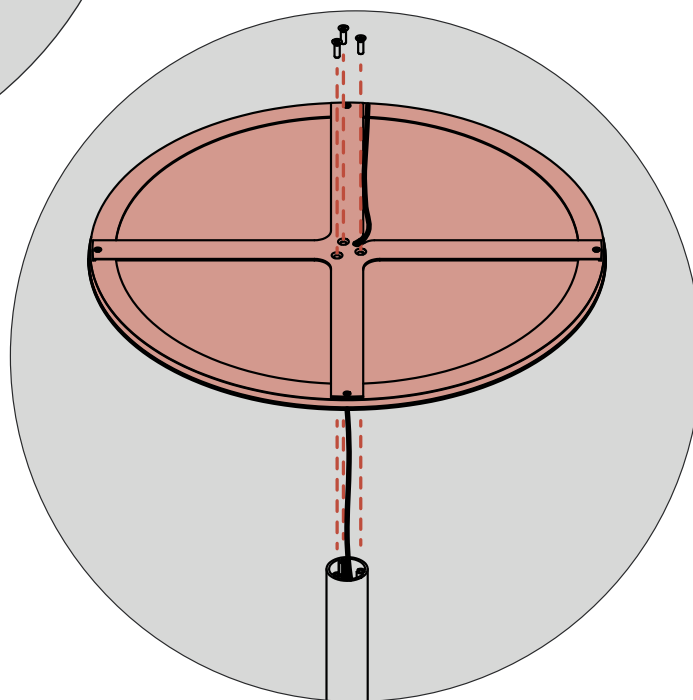

11. Optional Neighborhood Light: Secure Power Supply

Secure the power supply to the bench using (2) screws and the power supply mounting bracket.

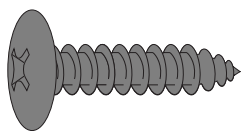

10 X 3/4" Pan
Head Screw
(122875)

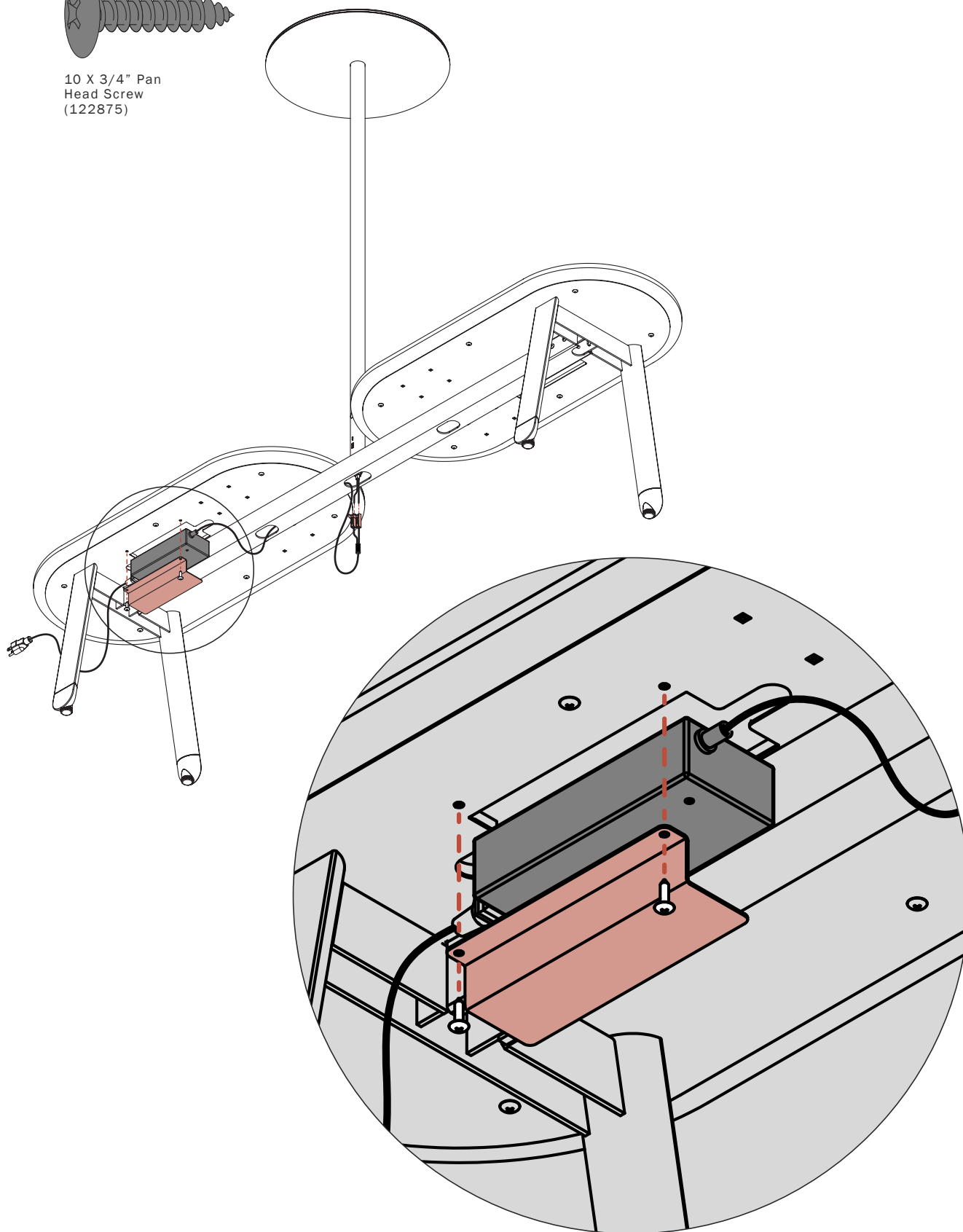

12. Optional Neighborhood Light: Connect Power

Connect the wires from the power supply to the wires on the light by inserting the cable into the wire splice connector and then snapping the connector closed. Make sure to connect red to red and black to black. Tuck any excess cable into the bench frame tube to keep it out of the way. Plug into power source and test.

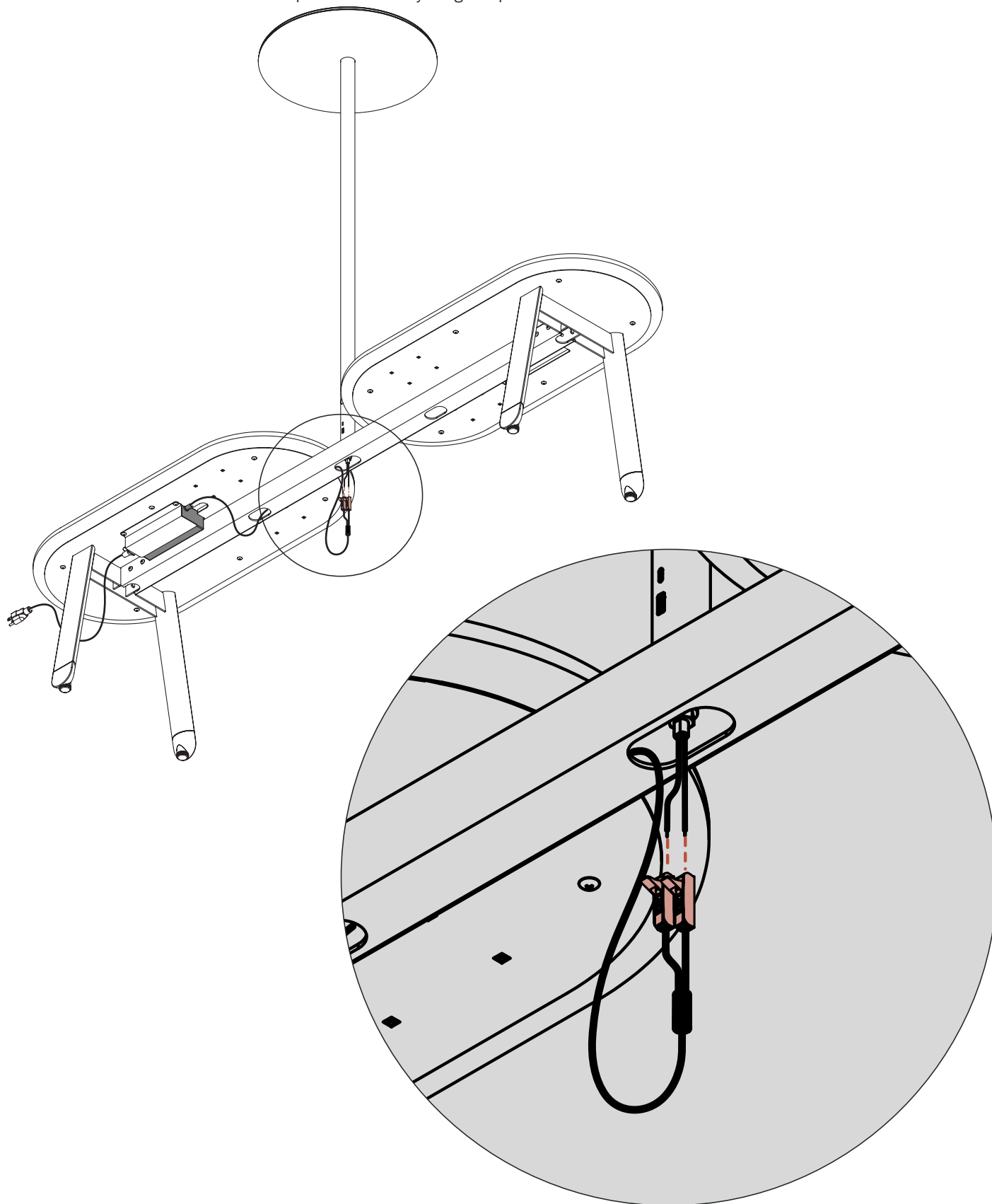

13. Optional Neighborhood Light: Attach Light Shade

Press the shade onto the light disc, applying even pressure around the perimeter until a snug and level fit.

