

ASSEMBLY

Mastermind Tables

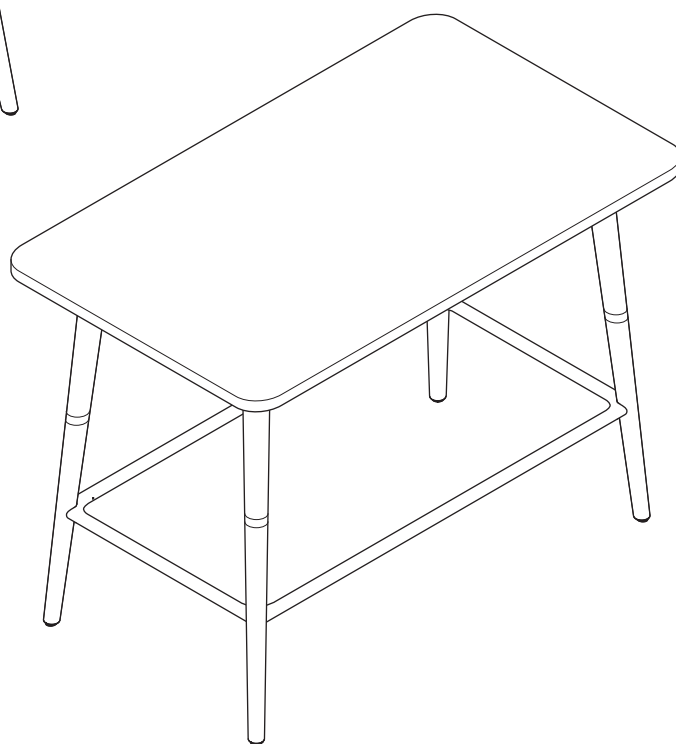
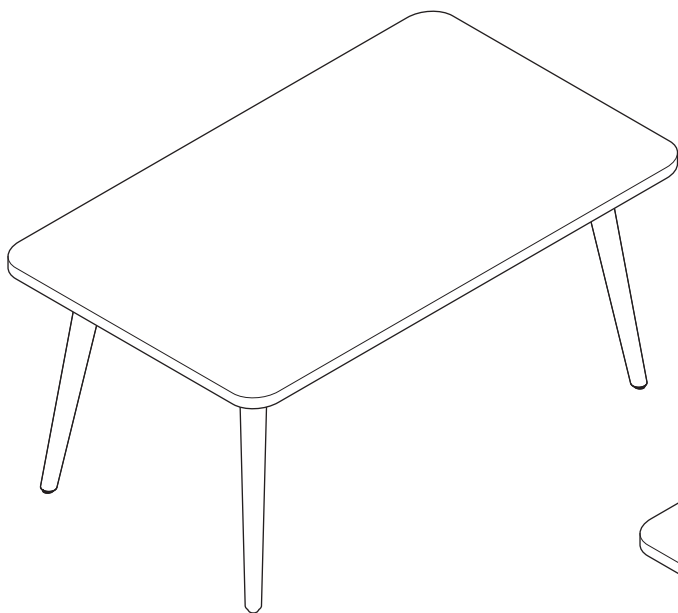

View Digitally

Important Safety Instructions

This product is for commercial use only.

Maximum intended load for each worksurface is 200 lbs (91 kg)

When using an electrical furnishing, basic precautions should always be followed, including the following: Read all instructions before using (this furnishing).

DANGER

To reduce the risk of electric shock:

1. Always unplug this furnishing from the electrical outlet before cleaning.

WARNING

To reduce the risk of burns, fire, electric shock, or injury to persons:

1. Unplug from outlet before putting on or taking off parts.
2. Close supervision is necessary when this furnishing is used by, or near children, invalids, or disabled persons.
3. Use this furnishing only for its intended use as described in these instructions. Do not use attachments not recommended by the manufacturer.
4. Never operate this furnishing if it has a damaged cord or plug, if it is not working properly, if it has been dropped or damaged, or dropped into water. Return the furnishing to a service center for examination and repair.
5. Keep the cord away from heated surfaces.
6. Do not use outdoors.
7. Do not operate where aerosol (spray) products are being used or where oxygen is being administered.
8. To disconnect, turn all controls to the off position, then remove the plug from outlet.
9. Risk of Electric Shock – Connect this furnishing to a properly grounded outlet only. See Grounding Instructions (Fig. 1).

Grounding Methods

(Fig. 1)

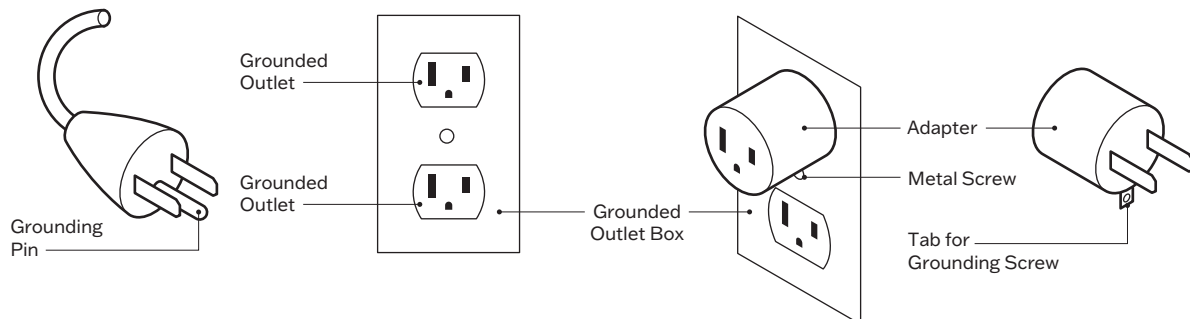

10. Mount furnishings at the correct height.
11. Risk of Fire or Electric Shock. It is possible for this office furnishing system to be connected to more than one source of supply. Disconnect all sources prior to any servicing. A single circuit shall not be powered by more than one source.

12. Electrical connection between rail segments shall be disconnected prior to removal of a mechanical connection.
13. The system may be supplied by a three phase power system with four individual circuits rated at 20 amps/120 volts maximum, or as permitted by local code.
14. No more than 12 duplex receptacles shall be supplied by one circuit. (12 segments Two Duplex, 6 segments Four
15. For commercial use only.

NOTE - Installation must be in accordance with the National Electrical Code and local codes. Electrically interconnected tables need to be mechanically connected.

General Rail Assembly Notes

It is recommended to perform as much of the rail assembly upside-down, keeping in mind how many installers are available to flip the run right-side up once assembled.



If 1 - 2 installers: flip the first rail segment upside down and complete steps 1 & 2. Then flip the rail right side up and continue with instructions, adding one segment at a time for step 3.



If 3+ installers: complete steps 1-4 with the rail flipped upside down. Once complete, flip right side up. The length of run will determine how many installers are needed to perform the flip.

If Using Optional Utility Power -

1. The electrical desk plug must be plugged into the utility power when present.
2. This product is for use on a nominal 120-volt circuit and has a grounding plug that looks like the plug illustrated in sketch A (see Figure 77.1). Make sure that the product is connected to an outlet having the same configuration as the plug. No adapter should be used with this product.

Save These Instructions

OPERATING INSTRUCTIONS – Please refer to the provided Installation Instructions and User Guide.

POLARIZED PLUG INSTRUCTIONS – To reduce the risk of electric shock, this furnishing has a polarized plug (one blade is wider than the other). This plug will fit in a polarized outlet only one way. If the plug does not fit fully in the outlet, reverse the plug. If it still does not fit, contact a qualified electrician to install the proper outlet. Do not change the plug in any way.

SERVICING OF DOUBLE-INSULATED PRODUCTS – In a double-insulated product, two systems of insulation are provided instead of grounding. No grounding means is provided on a double-insulated product, nor is a means for grounding to be added to the product. Servicing a double-insulated product requires extreme care and knowledge of the system, and is to be done only by qualified service personnel. Replacement parts for a double-insulated product must be identical to the parts they replace. A double-insulated product is marked with the words “DOUBLE INSULATION”, “DOUBLE INSULATED”, or .

This product is for use on a nominal 120-V circuit. Make sure that the product is connected to an outlet having the same configuration as the plug. No adapter should be used with this product.

Tools

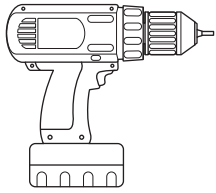

Electric Drill

Additional tools such as a 90 Degree Bit and an 18" Extension are helpful for some steps.

*No torque or ball bits should be used



90 DGREE BIT



Phillips Drill/
Driver Bit



5mm Hex Drill/
Driver Bit

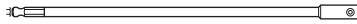

18" EXTENSION

Hardware

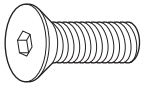

0002678
Screw, M8 X 25MM,
Flat Head

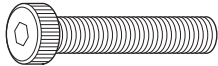

0002629
M8X35MM, PAN HEAD
(For High Tables with
Footbar only)



0002148
SCREW, #10 X 5/8, BK,
PHILLIPS (For Optional
Cable Tray only)

Essential Components

Leg Mount
Plastic Nut

0002558
Traverse End Cover

Long Traverse

Short Traverse

Optional Cable Tray

Leg

High Table Leg

Footbar
(High Table Only)

Surfaces

Note: Table and High Table both install in the same manner with the exception of step 6 “Install Footbar (High Table Only)”.

1. Install Plastic Nut Assembly.
Align and insert Plastic Nut Assembly into holes on Leg Mount Casting (1a).

Refer to Figure 1 and align Plastic Nut Assembly with notches in the Leg Mount Casting (1b).

M6-1.0 X 12MM Button Head
Screw, Black or Zinc dependent
on desk color (125285/125290)

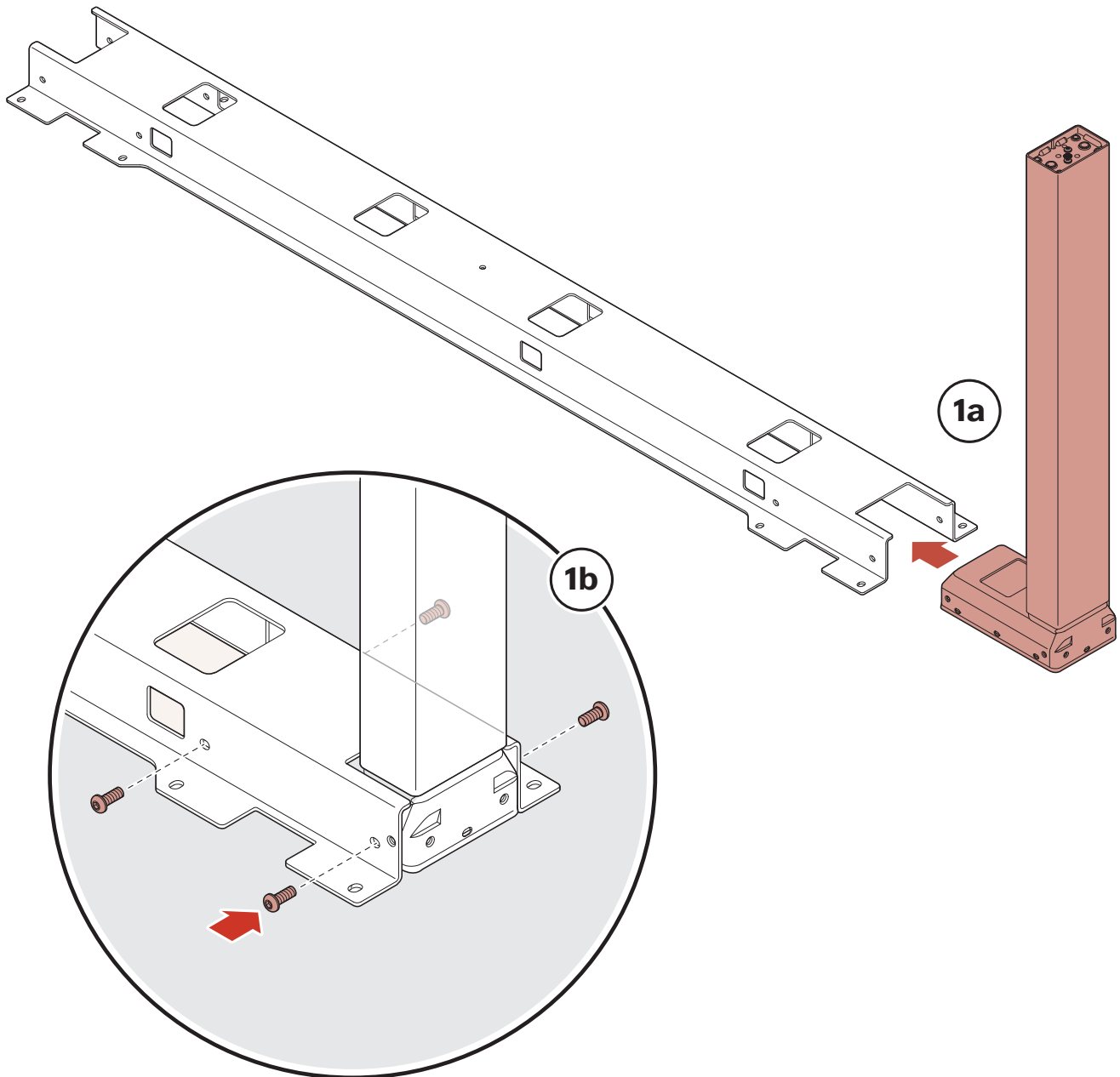

2. Install Traverse End Covers.

Align and attach Traverse End Covers to Leg Mount Castings wherever there is a Plastic Nut Assembly installed (2a & 2b). Refer to Fig. 2 for locations for the rest of the Traverse End Covers.

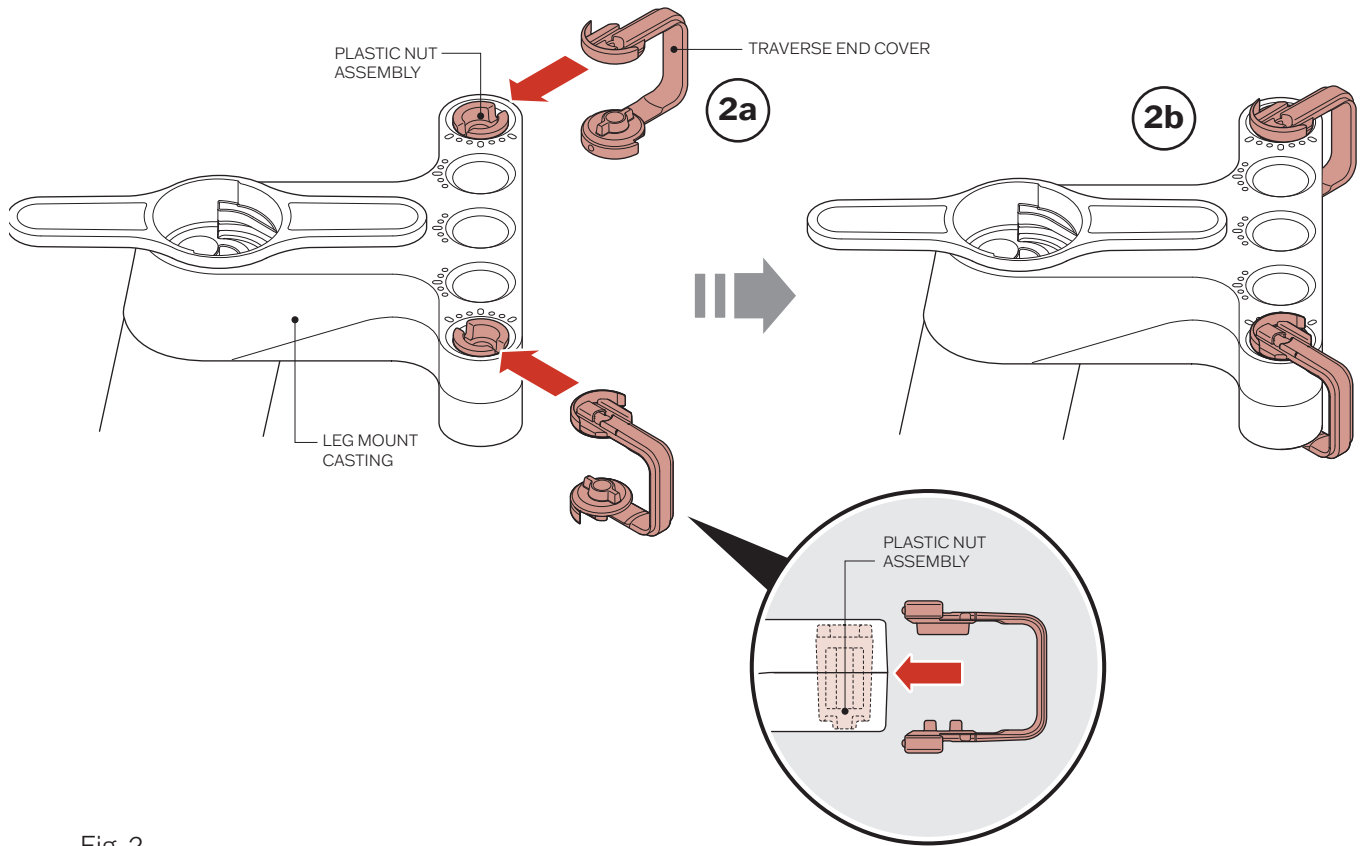
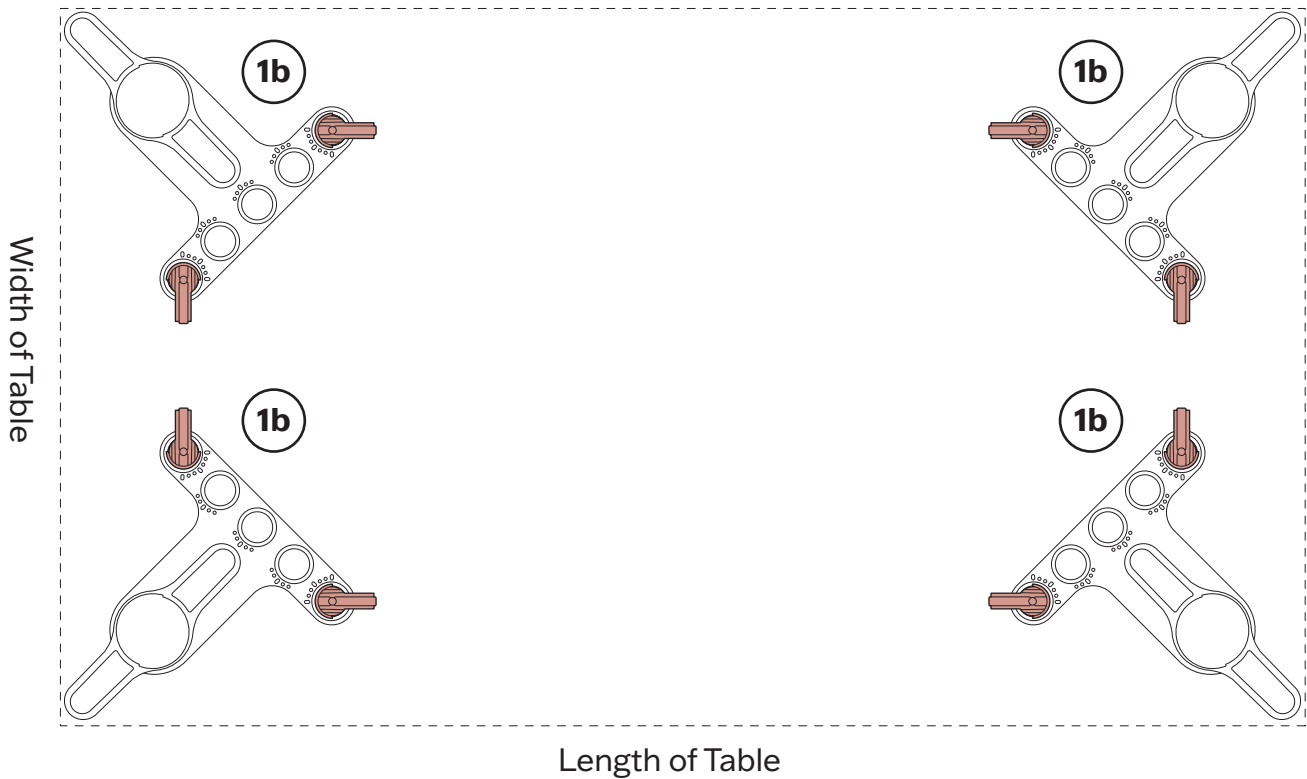

Fig. 2



3. Attach Traverses.

Slide Traverses over each Traverse End Covers to attach the Legs and build the Base (3a & 3b).
Assemble as shown.

Note: The Long Traverse will run parallel to the length of the Table.

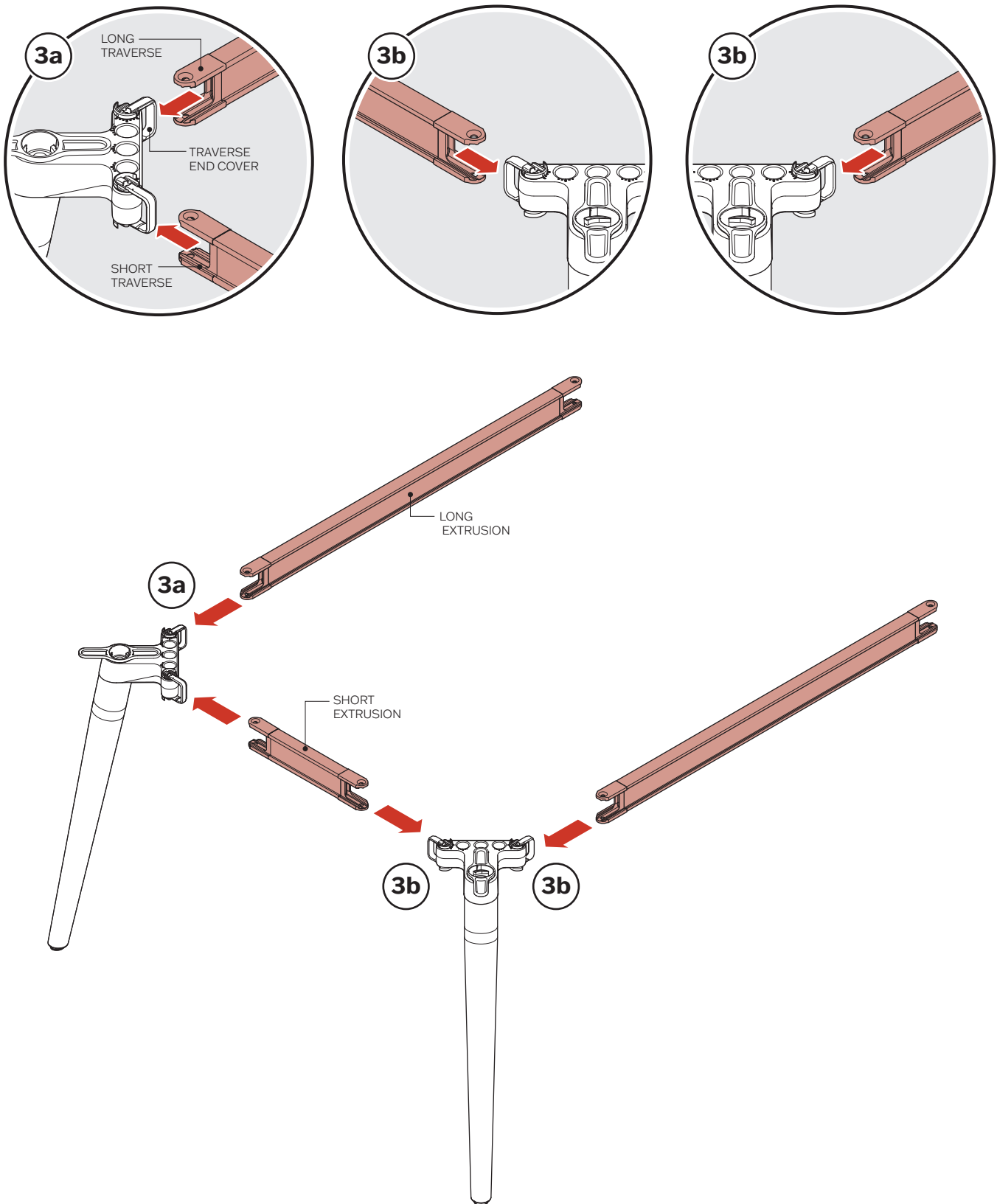

4. Attach Traverses.

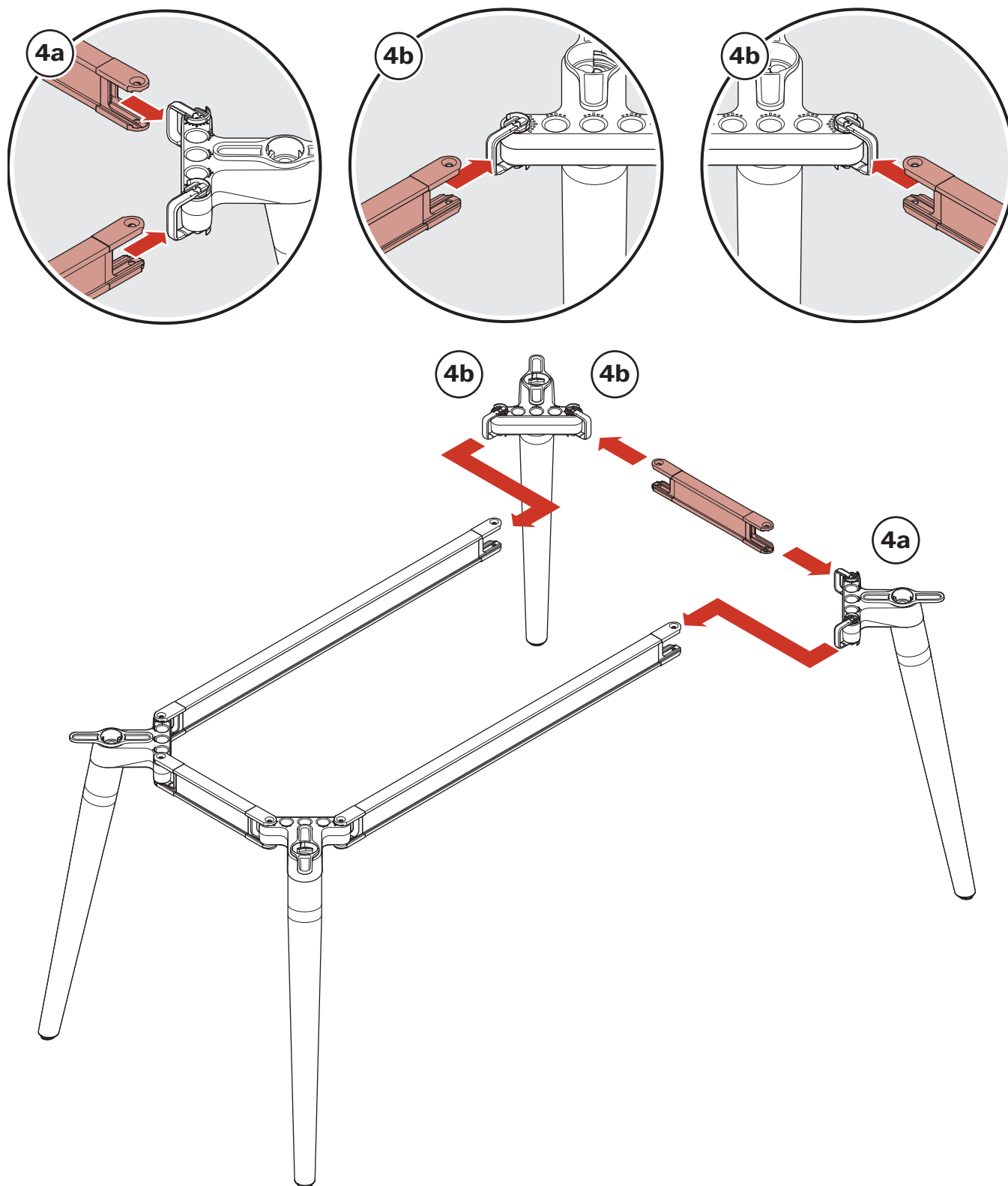

5. Secure Base.

Using a 5mm Hex Wrench, secure Traverses by threading (4) M8 x 25MM screws into each Plastic Nut Assembly from above and below (5a thru 5d).

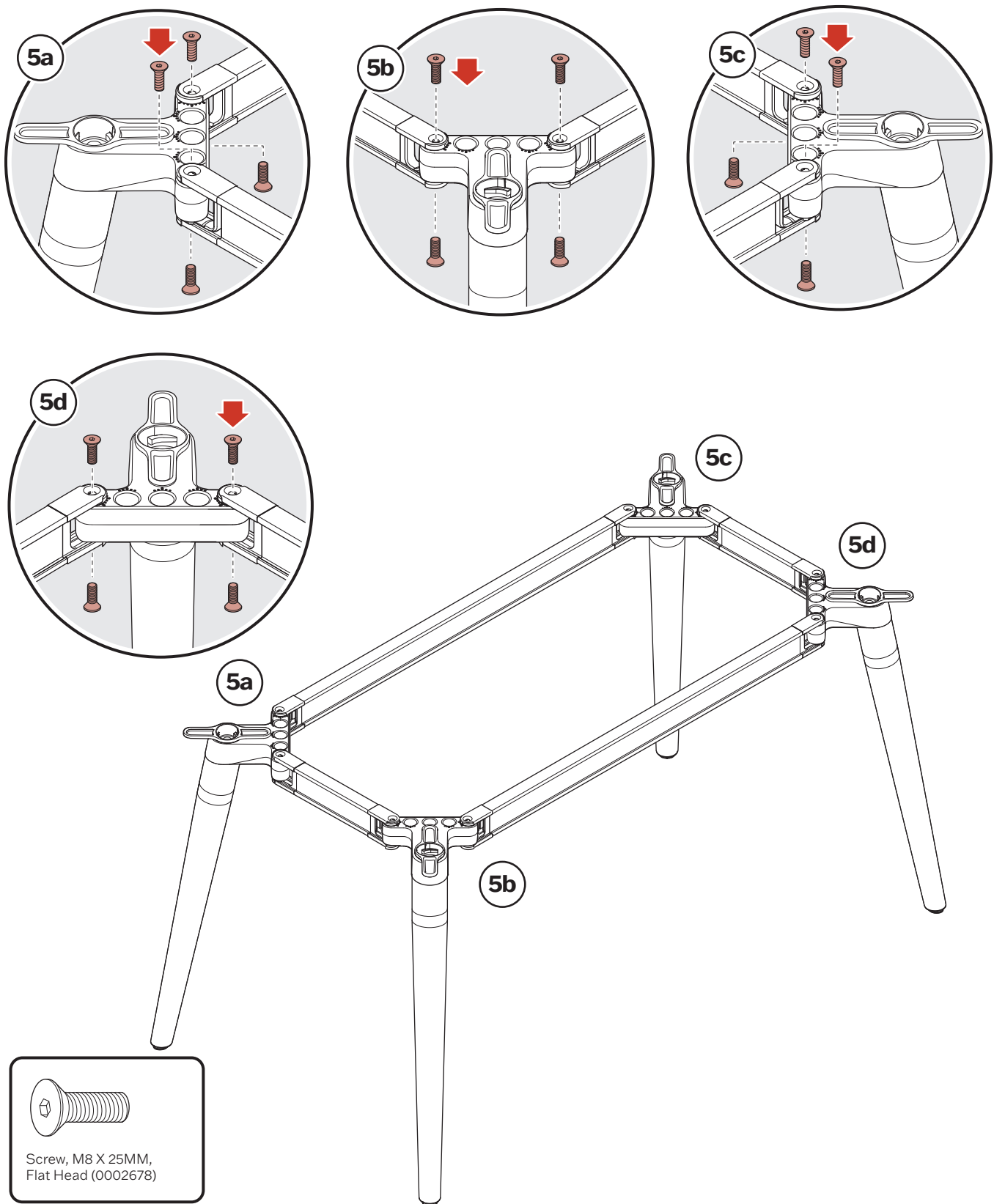

6. Install Footbar (High Table Only).

Flip frame upside down. Fit the Footbar between the table legs, ensuring the correct orientation as shown (6a). Secure Footbar to Legs using four (4) M8x35mm Pan Head Screws (6b). Flip Base back over.

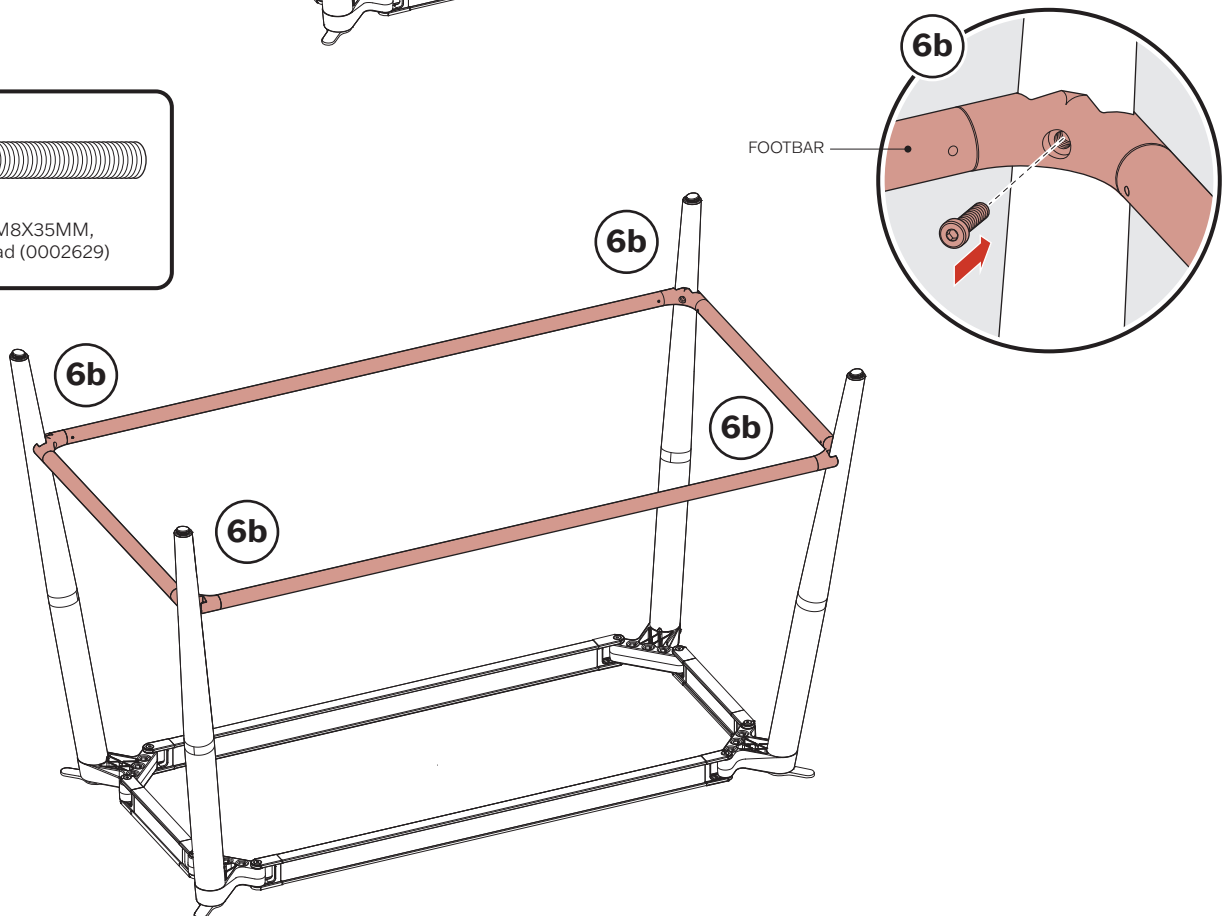
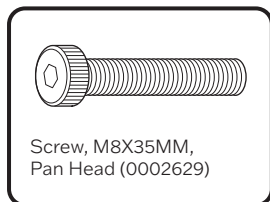
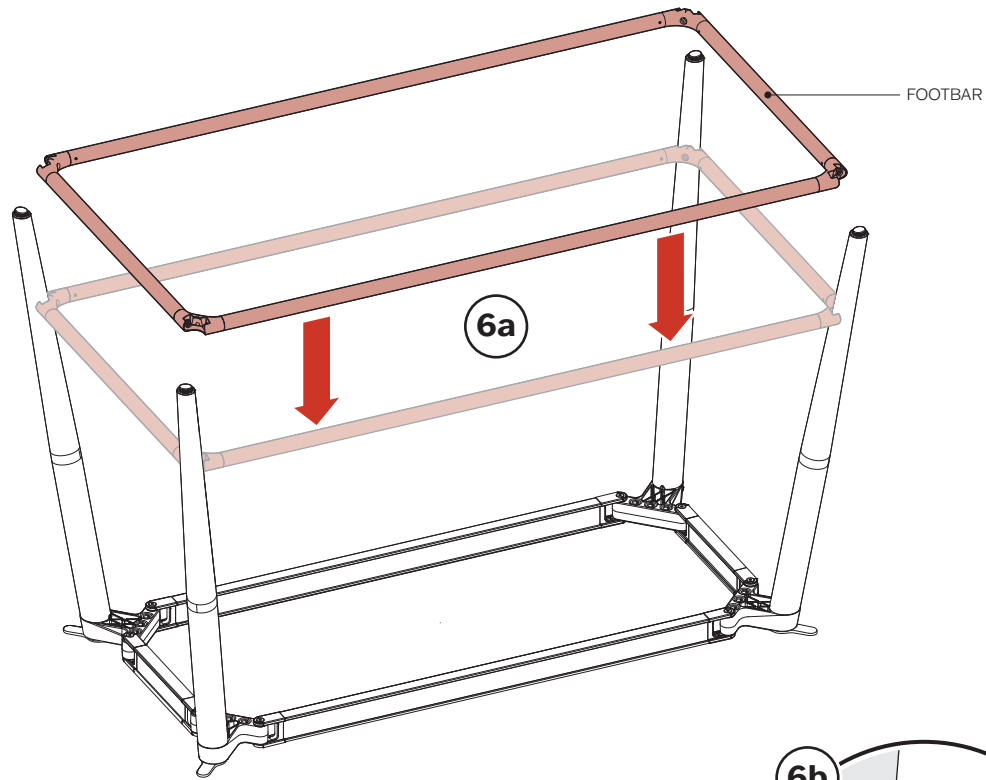

7. Install Top Surface.

Place Top Surface onto Base (7a) making sure the Table Mount Castings (pre-installed) (7b) are placed into the receiving ends of each Leg Mount Casting (7c). Turn each locking component in leg 90° to secure top (7d).

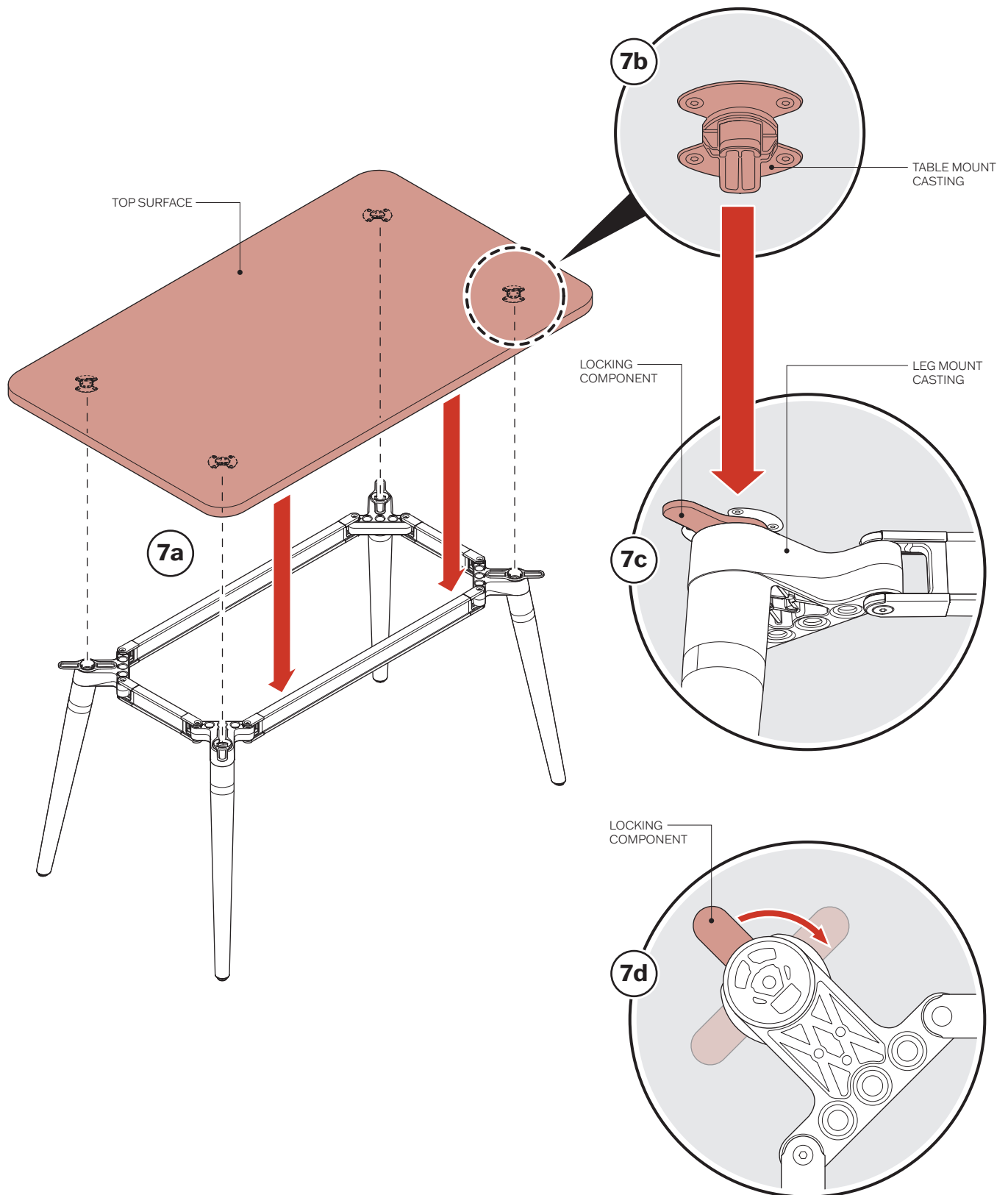

8. Attach Optional Cable Tray.

Align each Cable Tray with five (5) pilot holes in the surface (8a).

Attach the each Cable Tray using five (5) #10 x 5/8" Phillips Head Screws (8b). Flip table over.



Screw, #10 x 5/8, BK,
Phillips (0002148)

