

# ASSEMBLY

## Seven Flip Table / Multipurpose Table

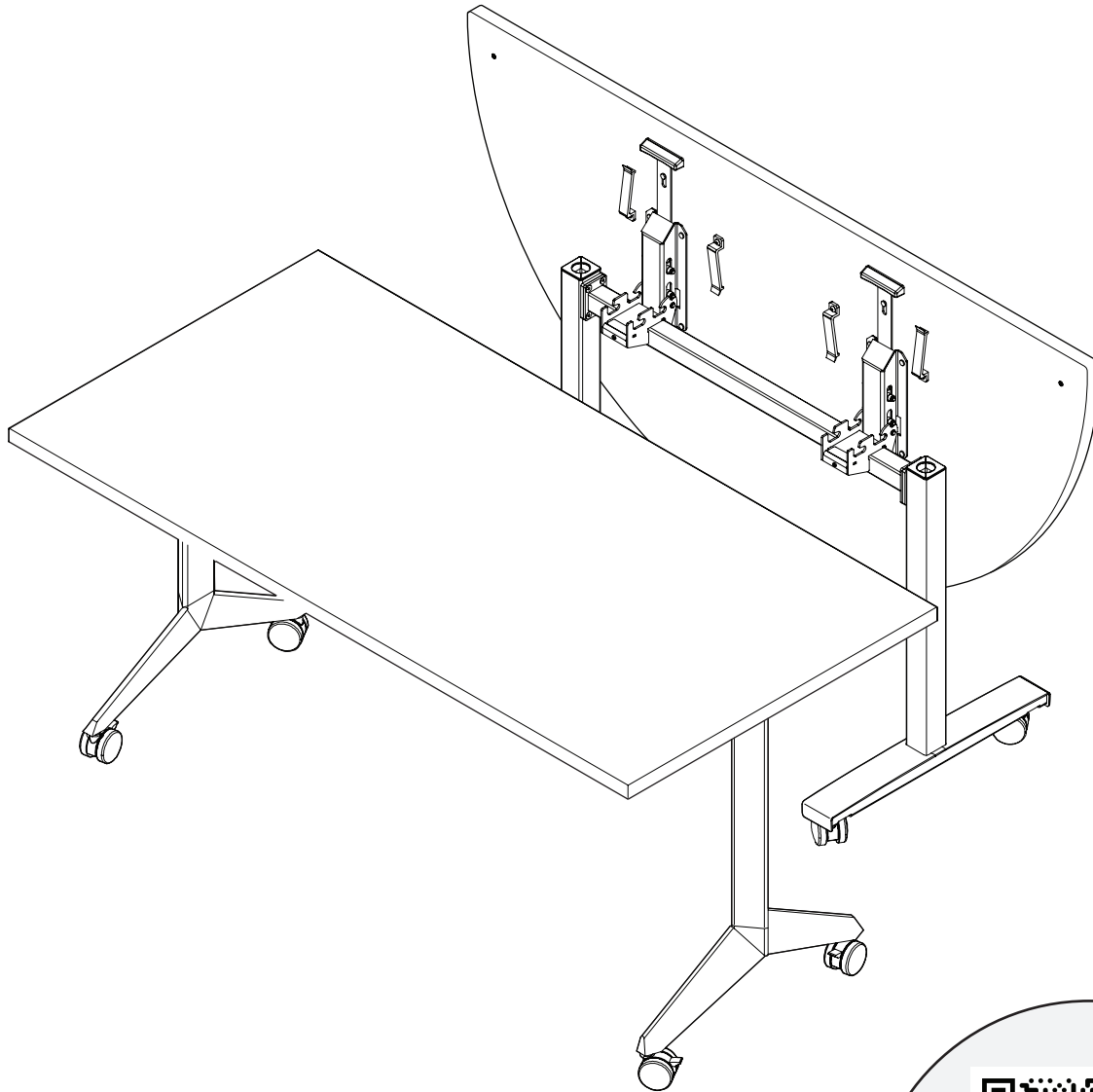

View Digitally

# Basic Table Components

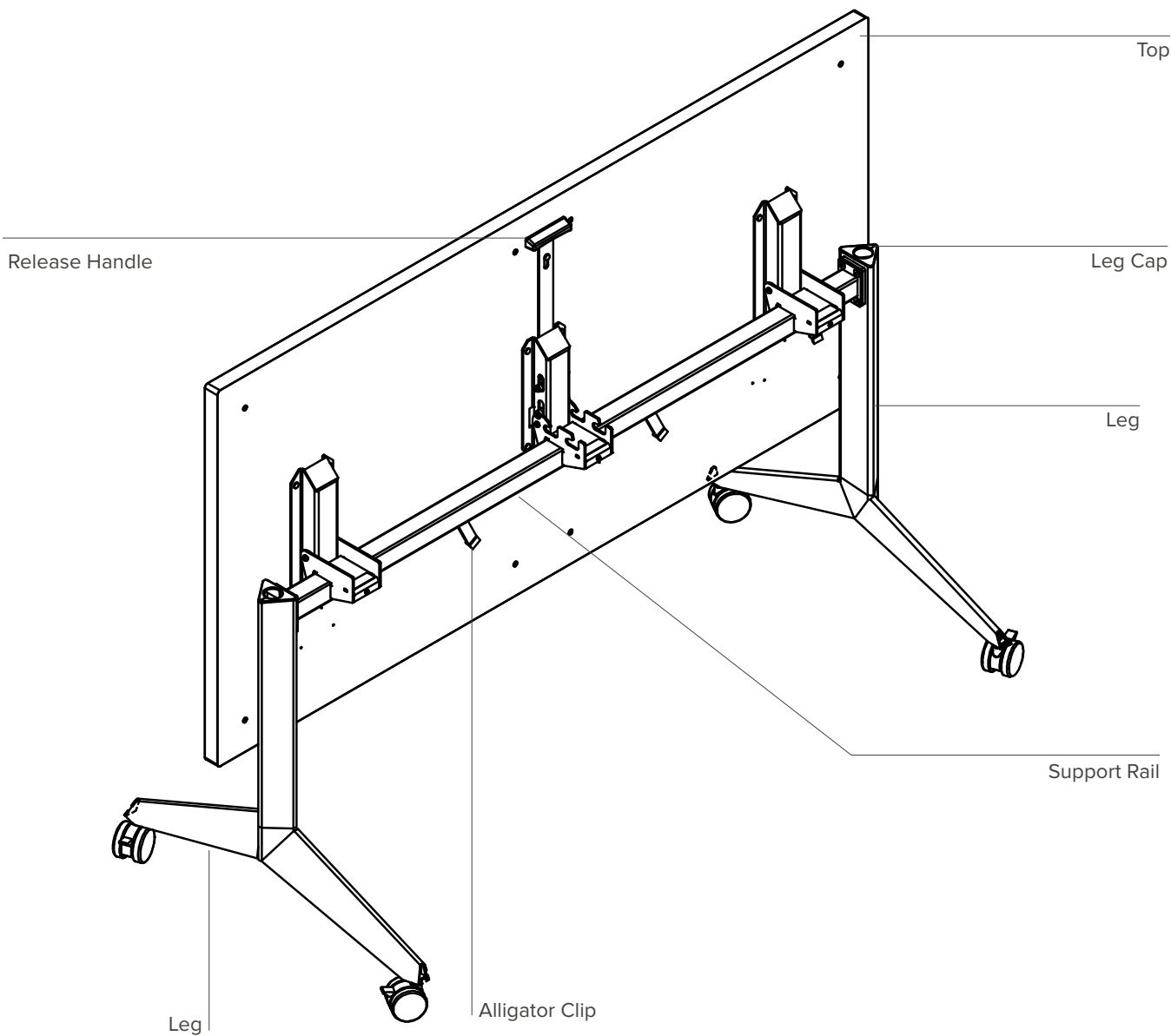

## FASTENERS

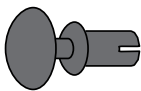

Securing Rivet  
(0000556)

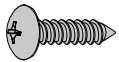

#10x3/4"  
Wood Screw  
(122875)



1/4-20x3/8"  
Flat Cap Screw  
(0000538)

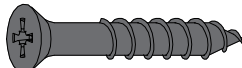

#8 x1-1/4  
Flathead woodScrew  
(122805)



#10x1"  
Wood Screw  
(122850)

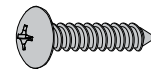

#8x1"  
Wood Screw  
(122820)



3/16"  
Flanged Bushing  
(0000554)

## TOOLS



5/32" Hex Key

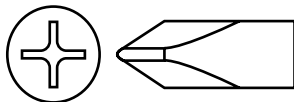

Phillips Head Driver

# PRODUCT BASIC COMPONENTS

## Top

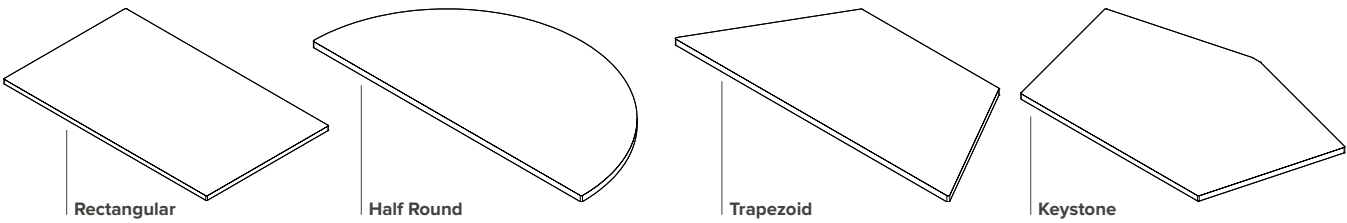

## Base

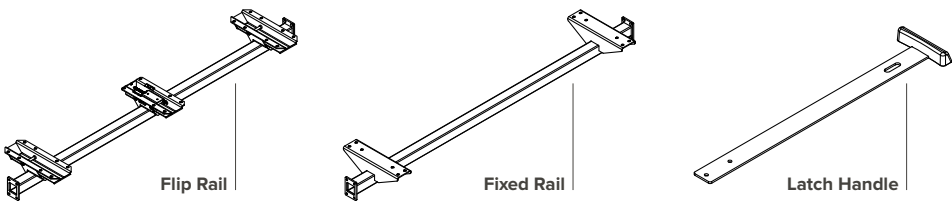

## Legs

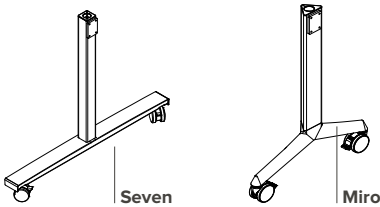

## Accessories

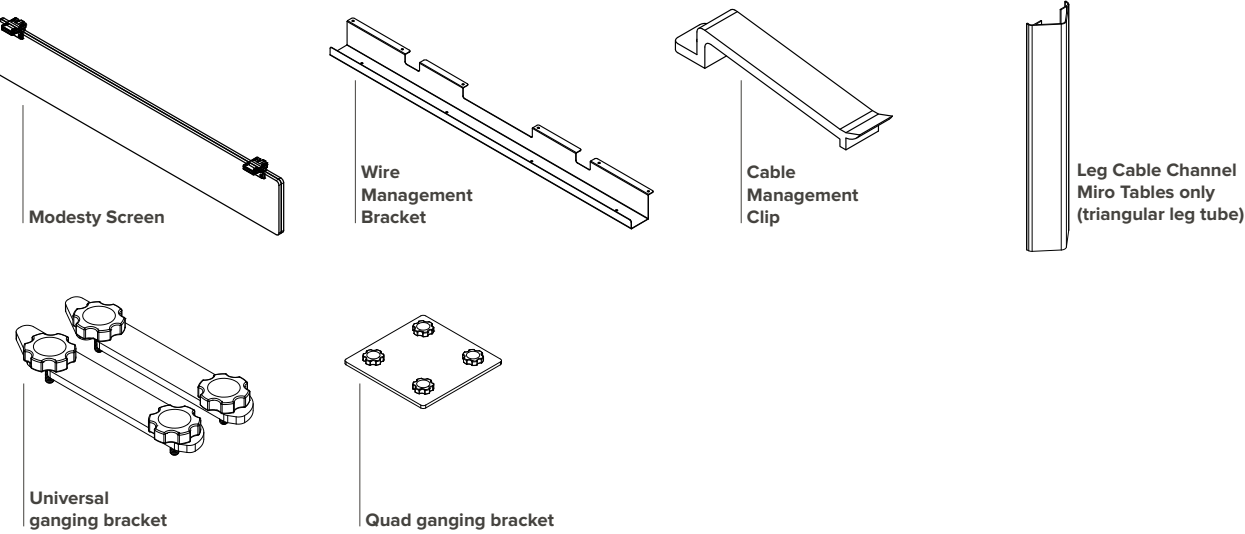

1. **Flip table assembly instructions.**  
if using a fixed base, see page 9.

Attach legs to support rail using four 1/4-20x3/8" flat cap screws on each side.

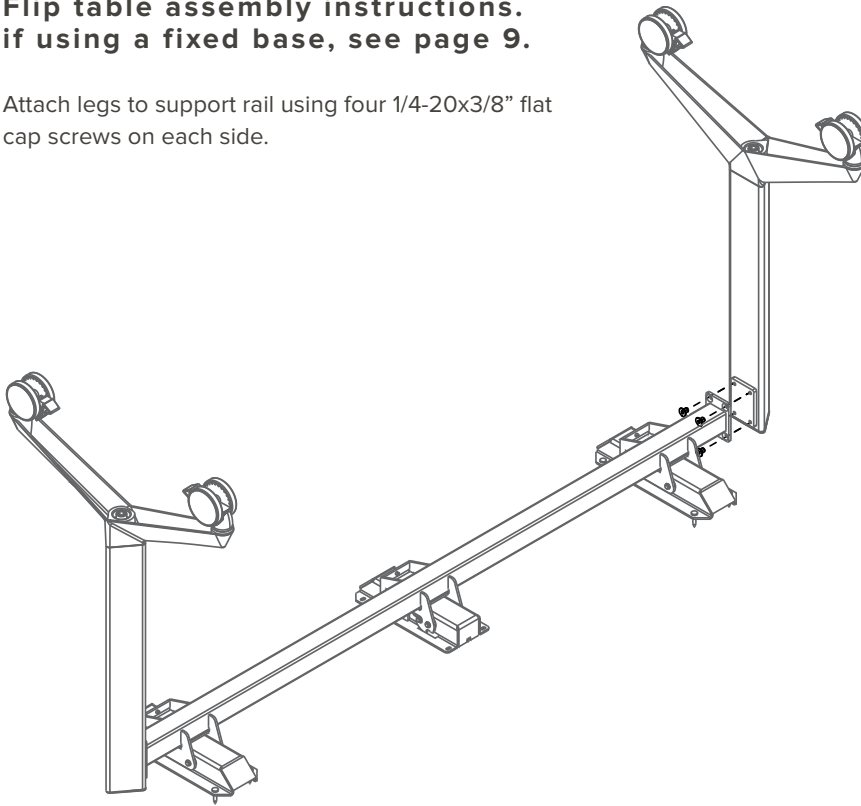

(0000538)

2. Attach release handle to support rail using two securing rivets

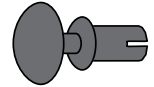
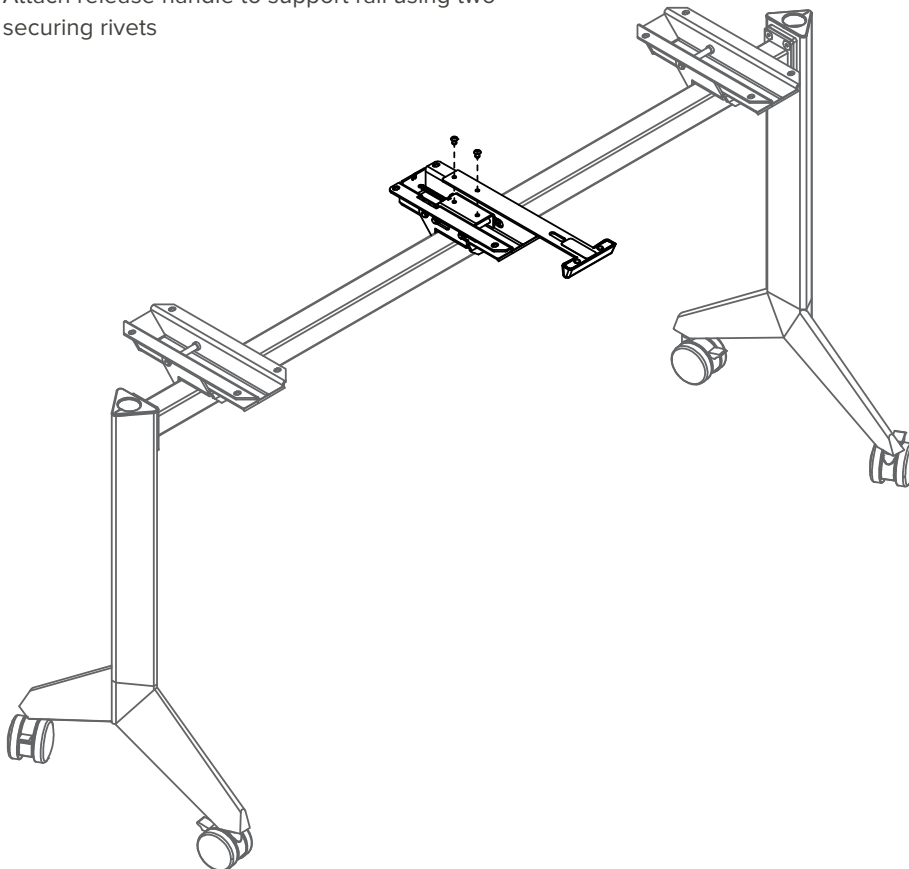

(0000556)

3. Attach table base to table top using 4 #10x1" wood screws per bracket.

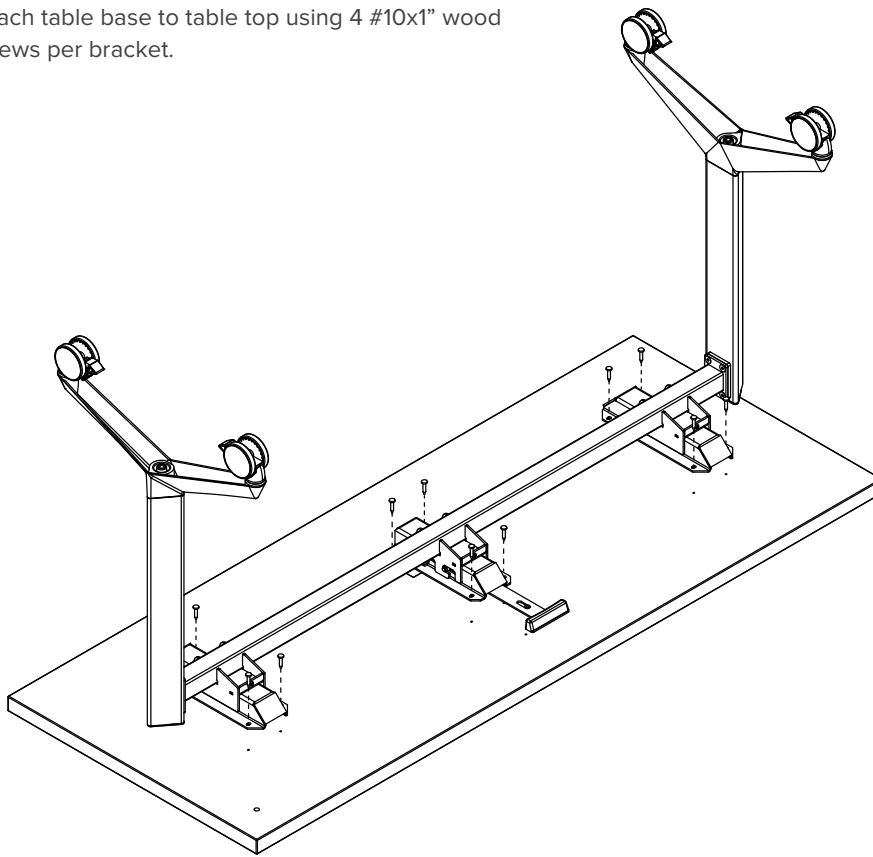

(122850)

4. Secure release handle using one 3/16 flanged bushing and one #10x1" wood screw per handle. Ensure that the pull handle can still move in and out freely.

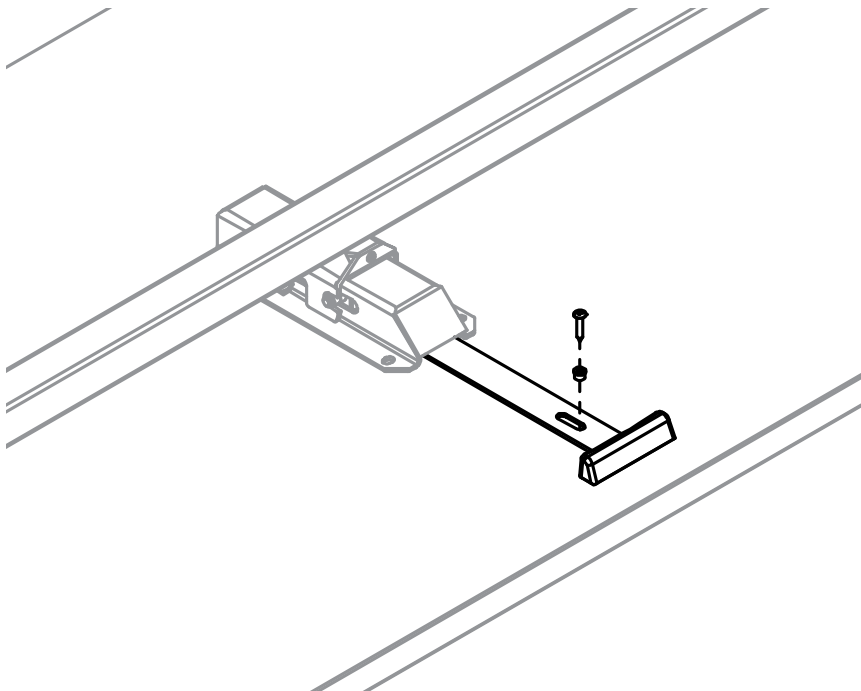

(122850)



(0000554)

5. Attach wire management clips to table top using one #10x3/4" wood screw per clip.



Note that the pilot holes for the clips at the ends of the table are not in line with the other clips.

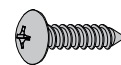

(122875)

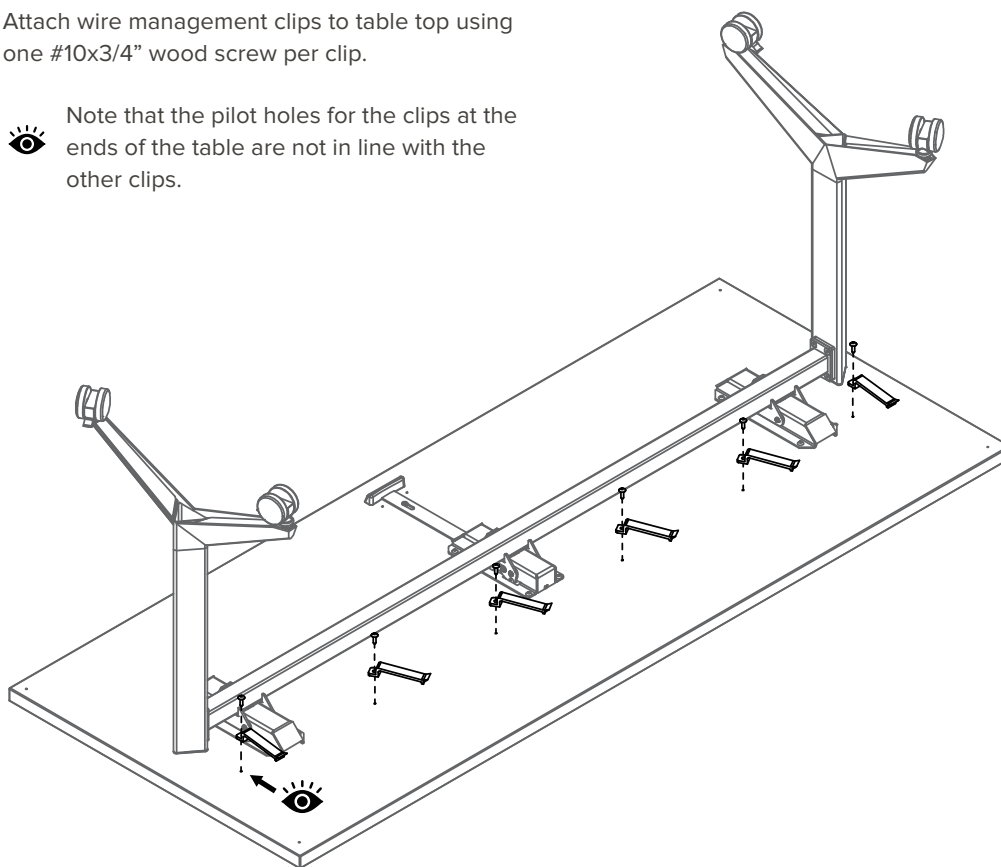

## 6. Optional Accessories

If using optional modesty screen, attach the modesty screen brackets to table top using four #8x1" wood screws per bracket.



Note that the release tab must face out, away from the support rail.

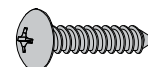

(122820)

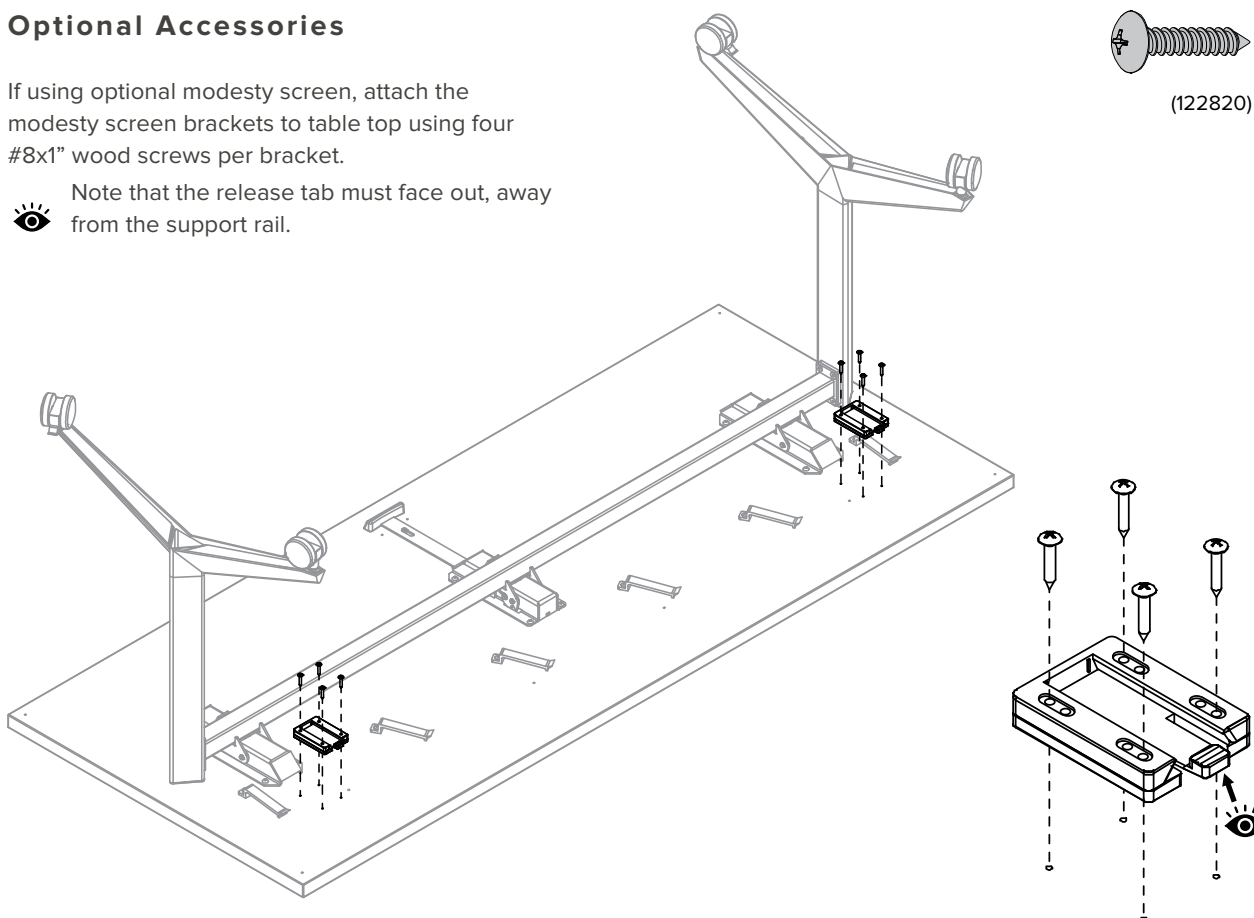

7. If using the optional wire management bracket, secure the bracket to the table top using #10x3/4" wood screws. If using optional modesty screen, you must install the wire management bracket before attaching the screen to the installed brackets.

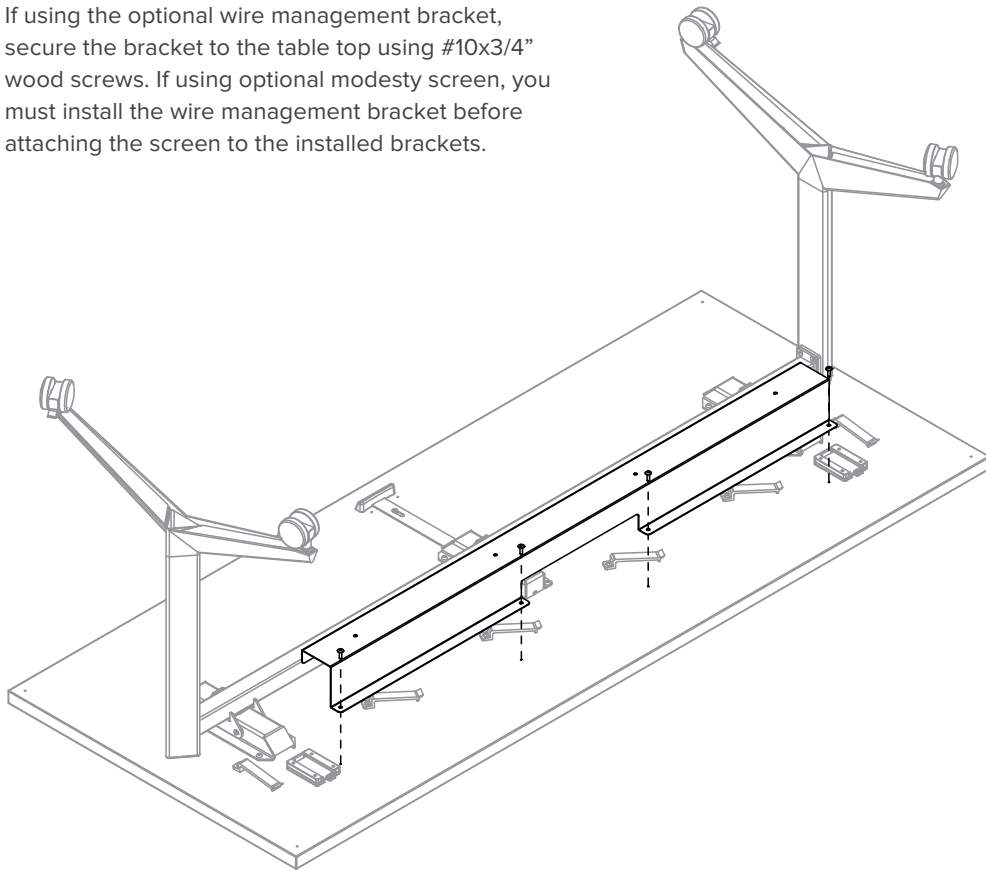
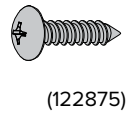

8. If using optional modesty screen, attach the screen by sliding into brackets installed in step 6.

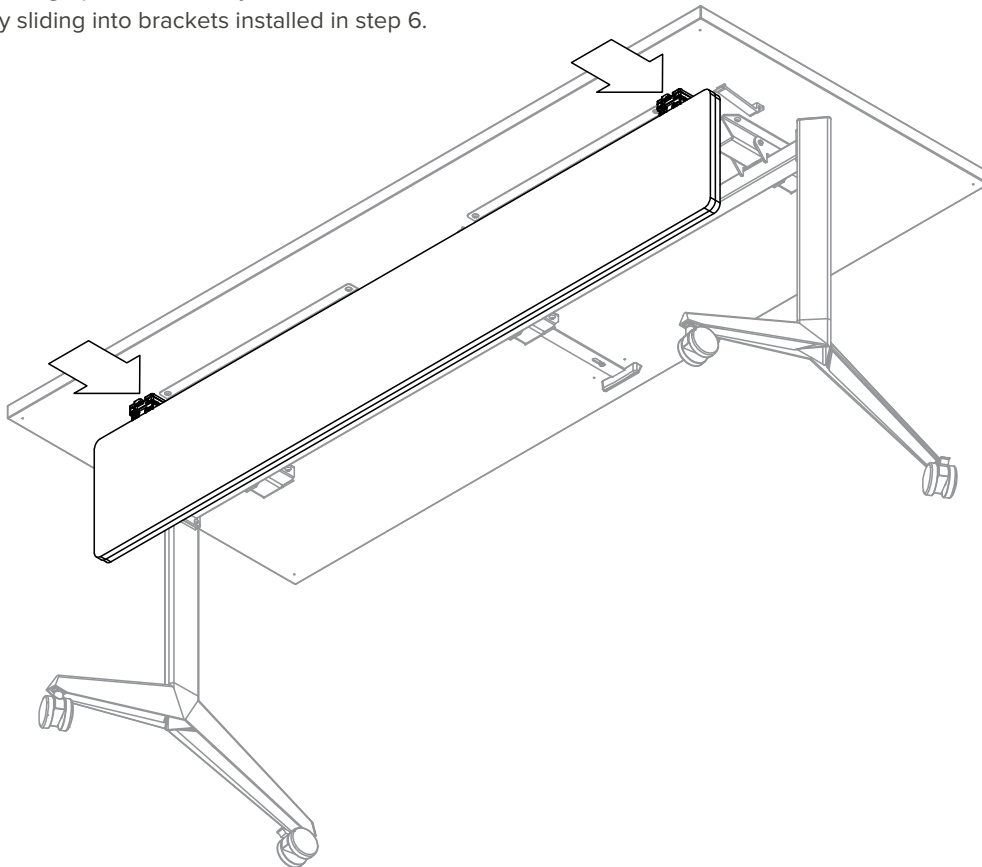

9A. If ganging two tables together order part WAGDU. It comes with 2 brackets and 4 knobs (0001011)

👁 Ensure that the knobs are installed using the inserts in the table.

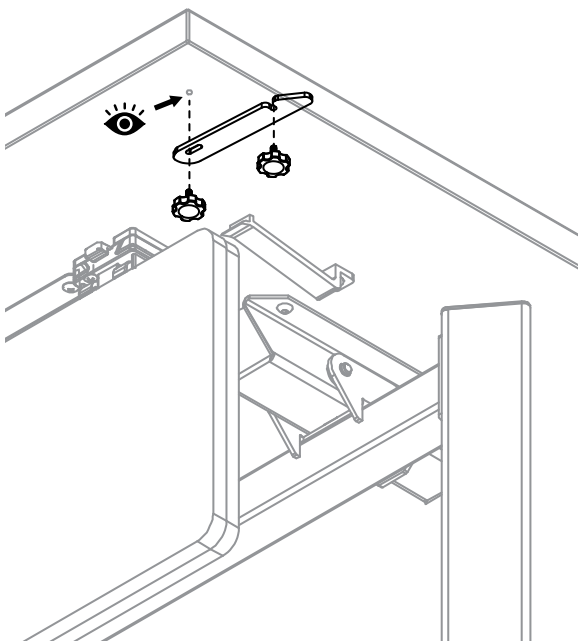

9B. If ganging four tables together order part WAGDG. It comes with 1 bracket and 4 knobs (0001011)

👁 Ensure that knobs are installed using the inserts in the table

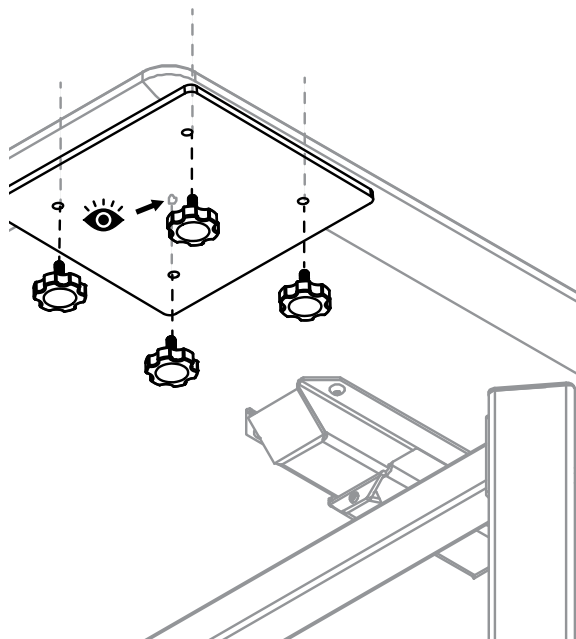

10. The optional Cable Channel (Miro Tables only) is a snap-on design and may be attached to either leg. From the inside of the leg, snap the rounded corners of the cable channel around the leg column. No hardware is needed.

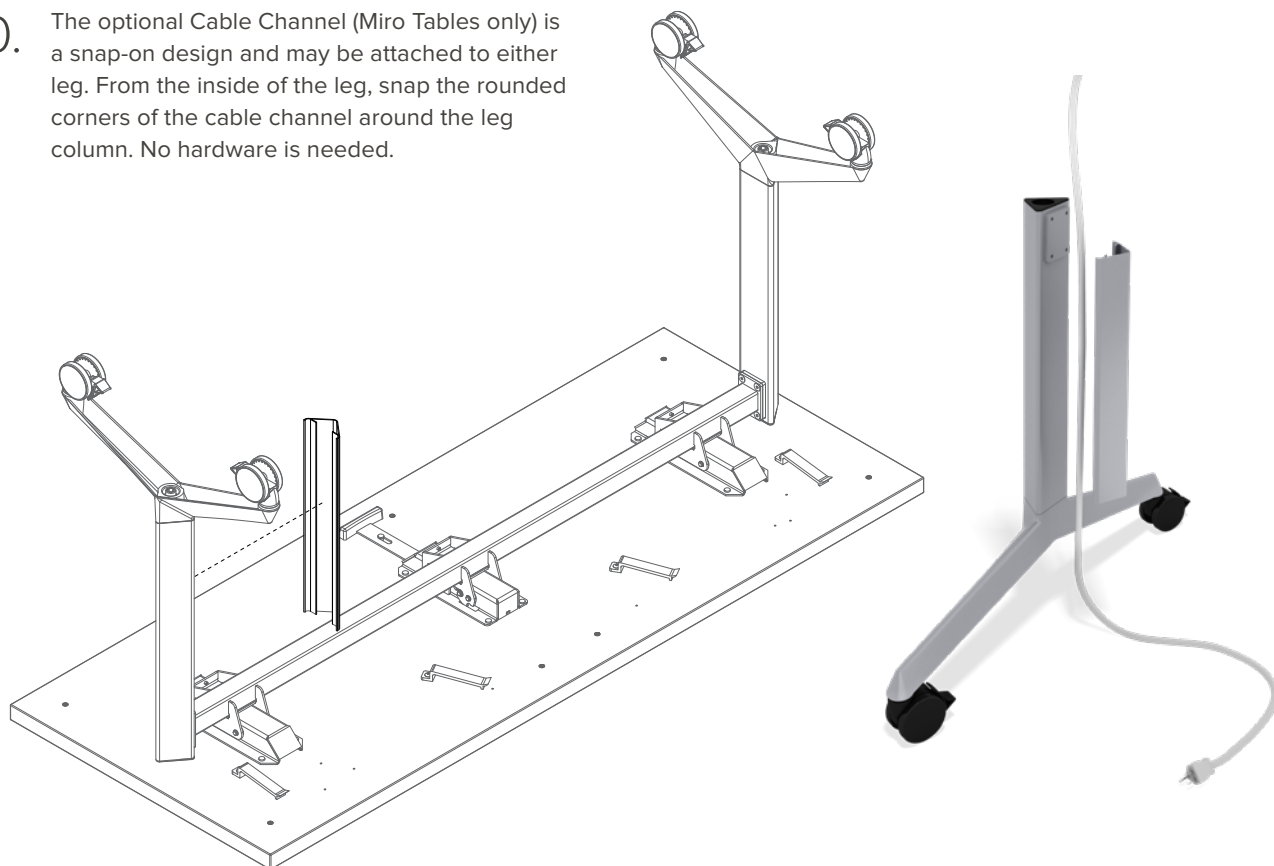



1. **Fixed table assembly instructions.**  
if using a flip base, see page 4.

Attach legs to support rail using four 1/4-20x3/8" flat cap screws per leg.



(0000538)

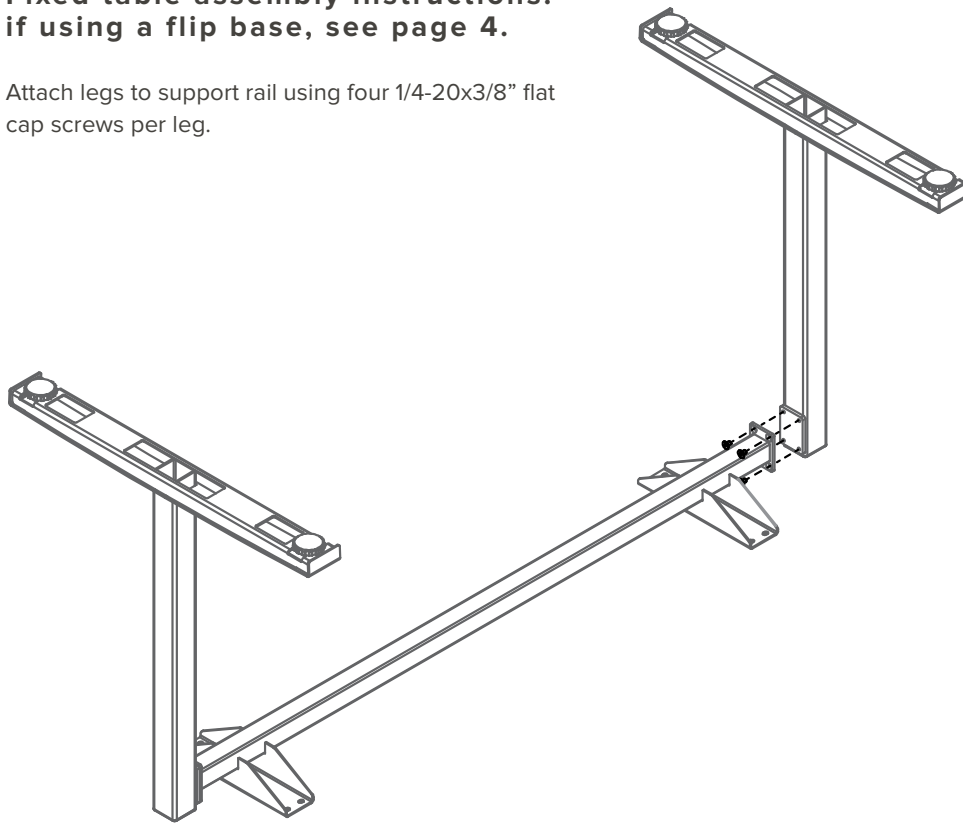

2. If using optional power module install before attaching the top. Remove leg grommet, and pass power cable through side gap in the grommet. Insert grommet back into the leg and pass cable down through the bottom.

To attach table base to table top, use #10x1" wood screws.

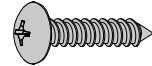

(122850)

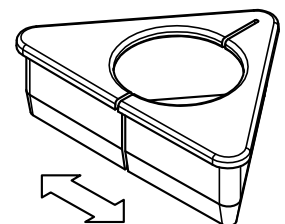
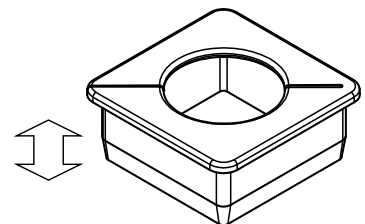
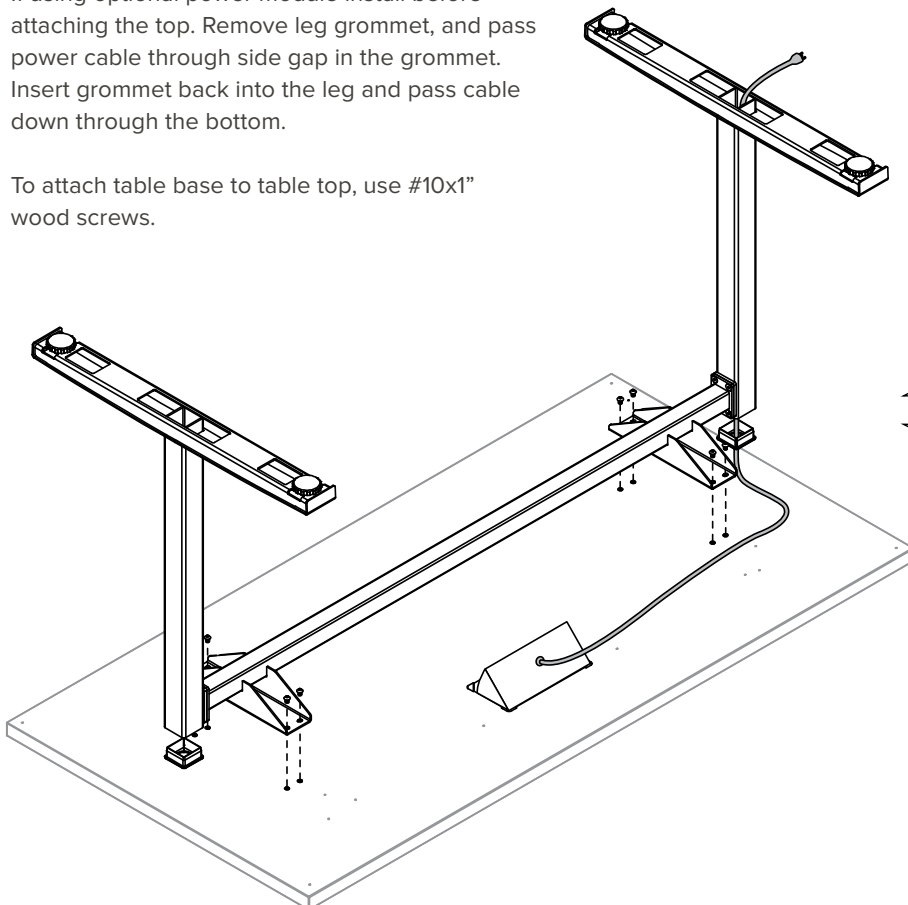

3. Attach wire management clips to table top using one #10x3/4" wood screw per clip.



Note that the pilot holes for the clips at the ends of the table are not in line with the other clips.

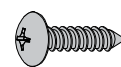
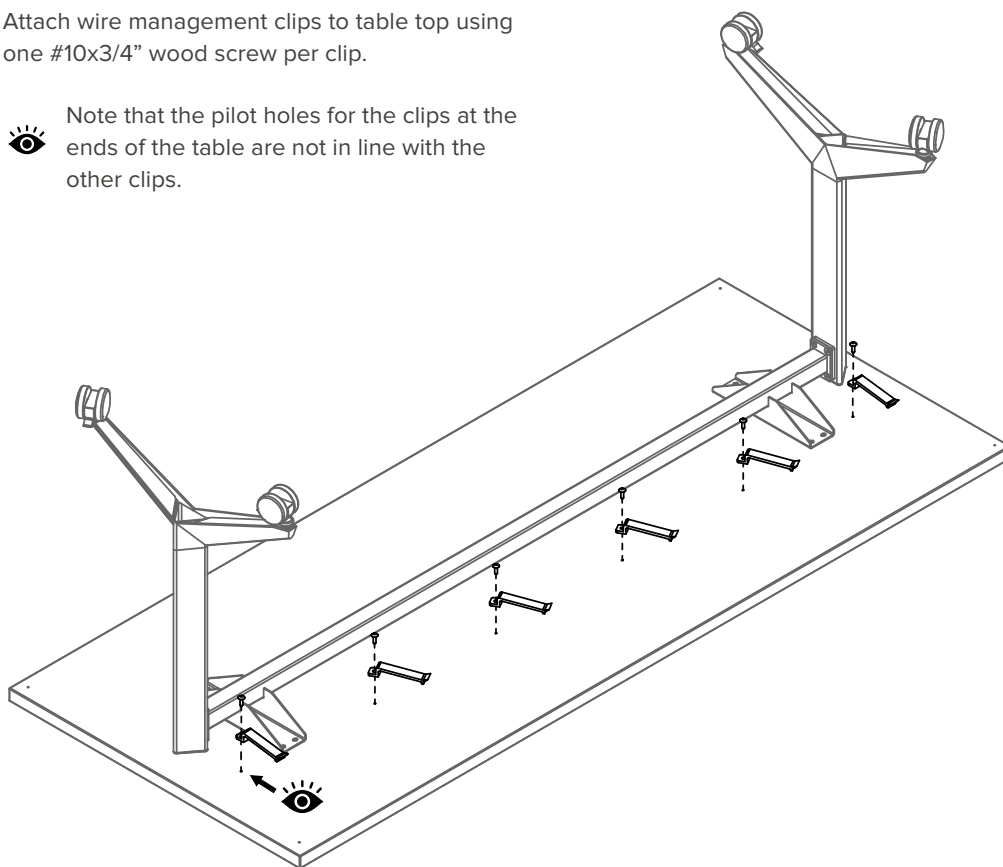

(122875)

#### 4. Optional Accessories

If using optional modesty screen, attach the modesty screen brackets to table top using four #8x1" wood screws per bracket.

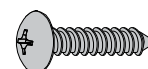
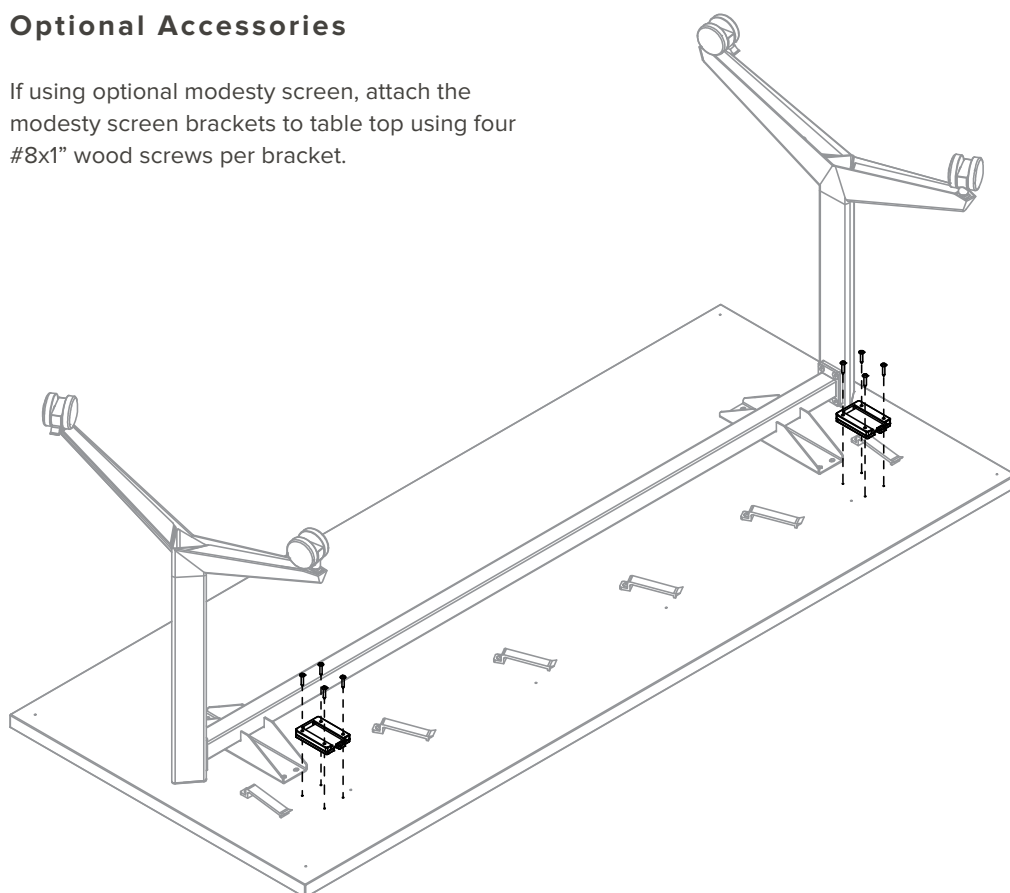

(122820)

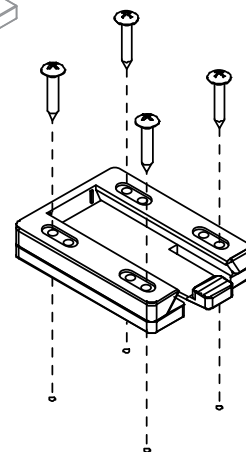

5. If using the optional wire management bracket, secure the bracket to the table top using #10x3/4" wood screws. If using optional modesty screen, you must install the wire management bracket before attaching the screen to the installed brackets.

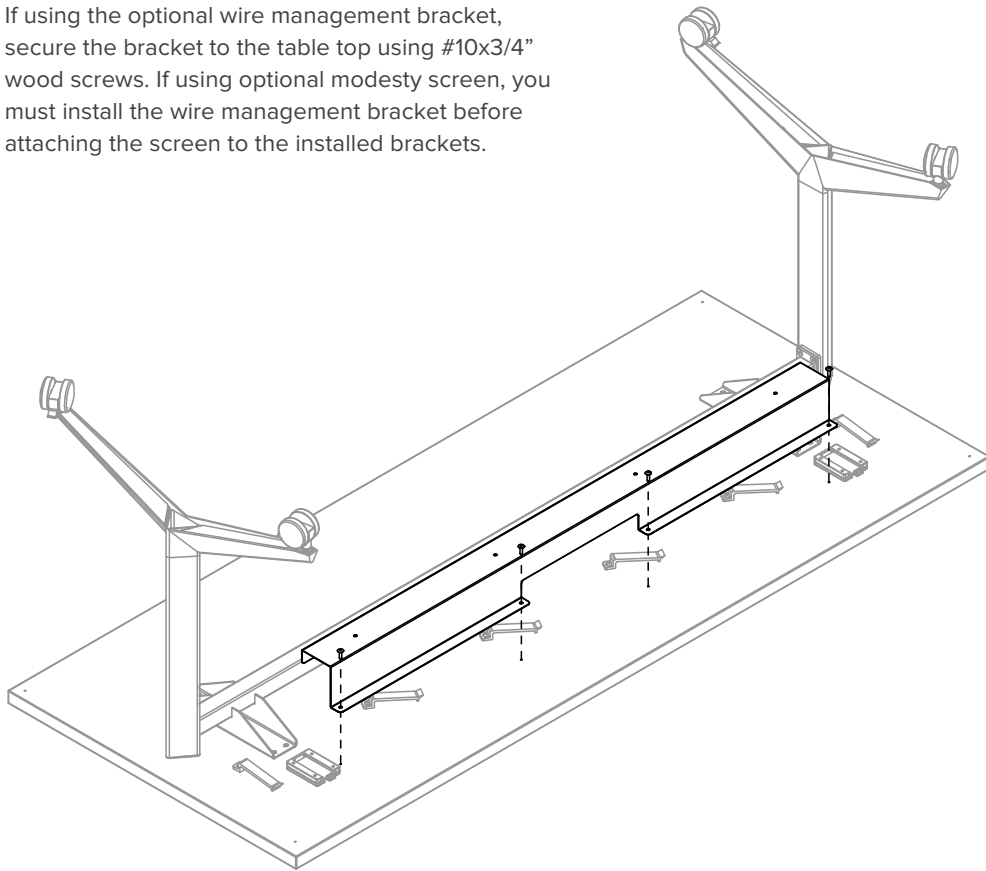
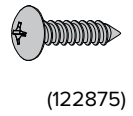

6. If using optional modesty screen, attach the screen by sliding into brackets installed in step 4.

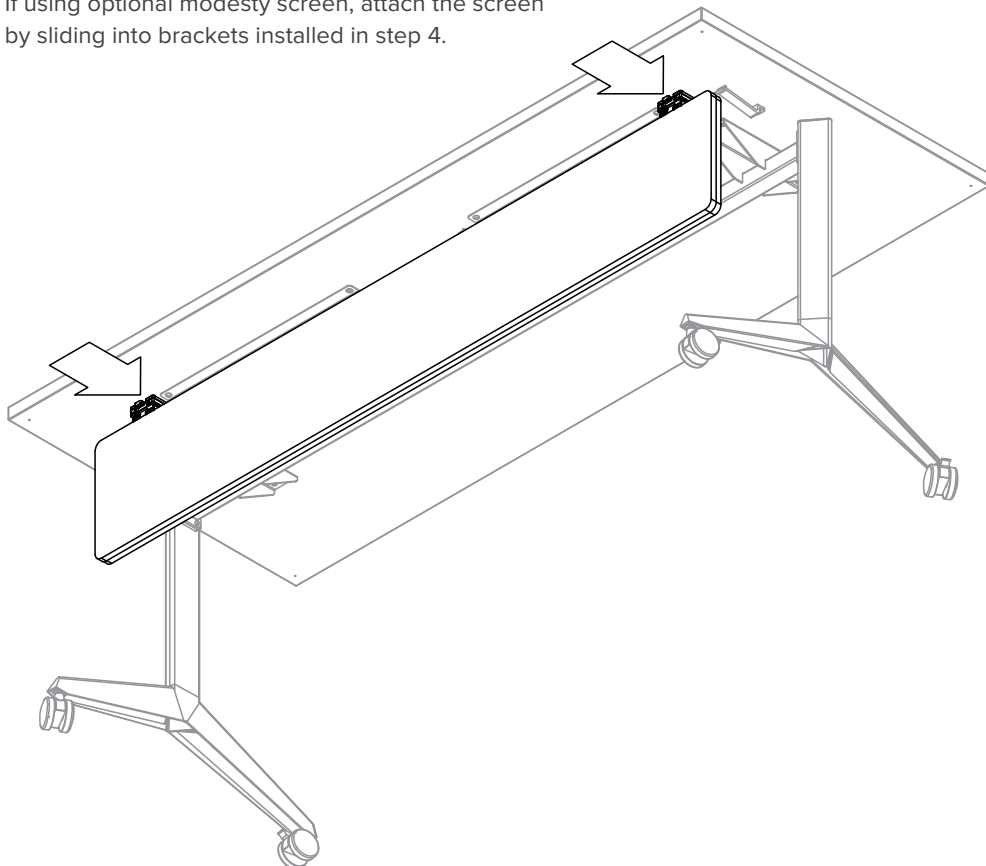

7A. If ganging two tables together order part WAGDU. It comes with 2 brackets and 4 knobs (0001011).



Ensure that the knobs are installed using the inserts in the table.

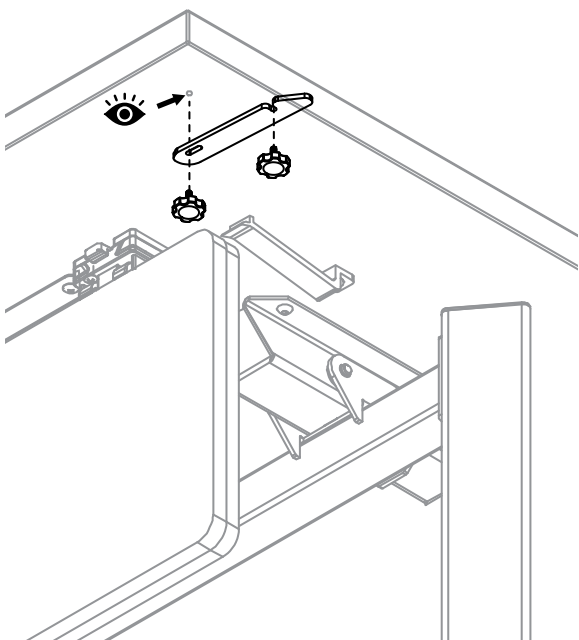

7B. If ganging four tables together order part WAGDG. It comes with 1 bracket and 4 knobs (0001011).



Ensure that the knobs are installed using the inserts in the table.

