

ASSEMBLY

Tonic Worktable

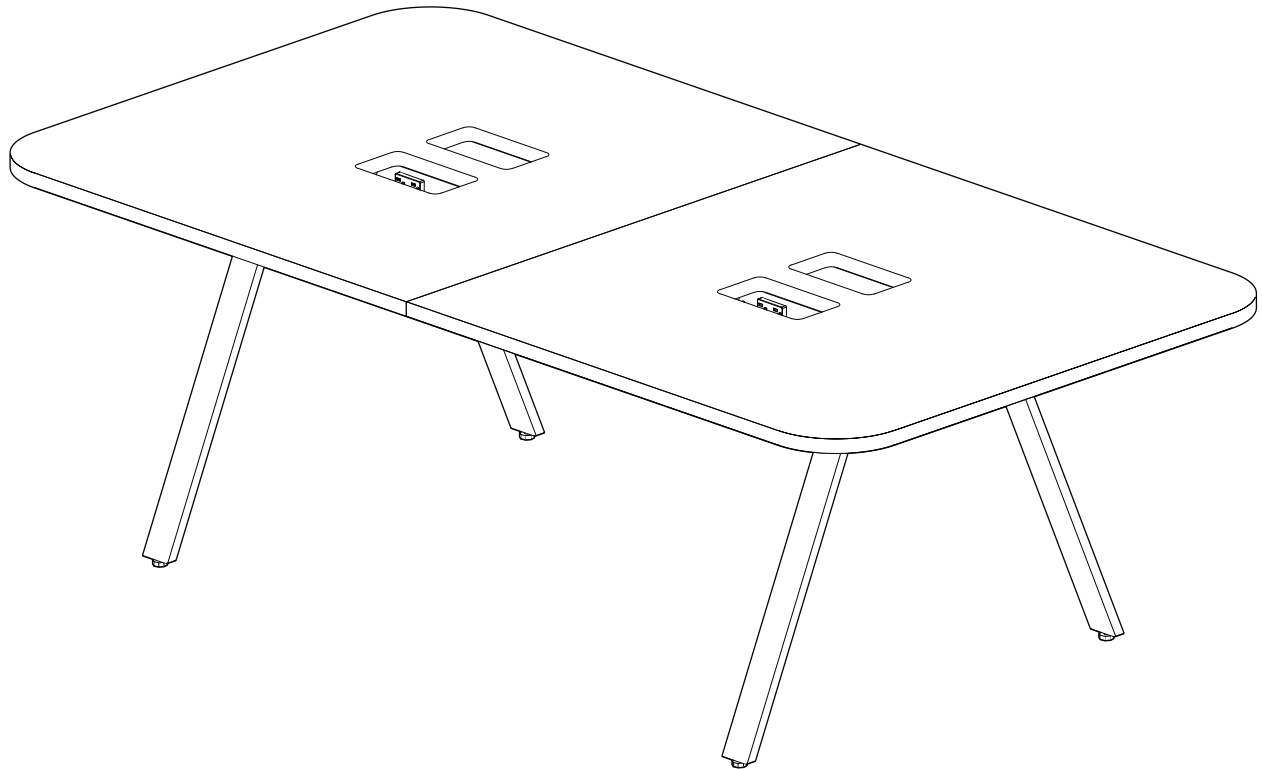

View Digitally

Important Safety Instructions

This product is for commercial use only.

When using an electrical furnishing, basic precautions should always be followed, including the following:

Read all instructions before using (this furnishing).

WARNING -

To reduce the risk of burns, fire, electric shock, or injury to persons:

1. Unplug from outlet before putting on or taking off parts.
2. Close supervision is necessary when this furnishing is used by, or near children, invalids, or disabled persons.
3. Use this furnishing only for its intended use as described in these instructions. Do not use attachments not recommended by the manufacturer.
4. Never operate this furnishing if it has a damaged cord or plug, if it is not working properly, if it has been dropped or damaged, or dropped into water.
5. Keep the cord away from heated surfaces.
6. Do not use outdoors.
7. Do not operate where aerosol (spray) products are being used or where oxygen is being administered.
8. To disconnect, turn all controls to the off position, then remove the plug from outlet.
9. **WARNING: Risk of Electric Shock –** Connect this furnishing to a properly grounded outlet only. See Grounding Instructions (Figure 77.1).
10. Mount furnishings at the correct height.

Figure 77.1
Grounding methods

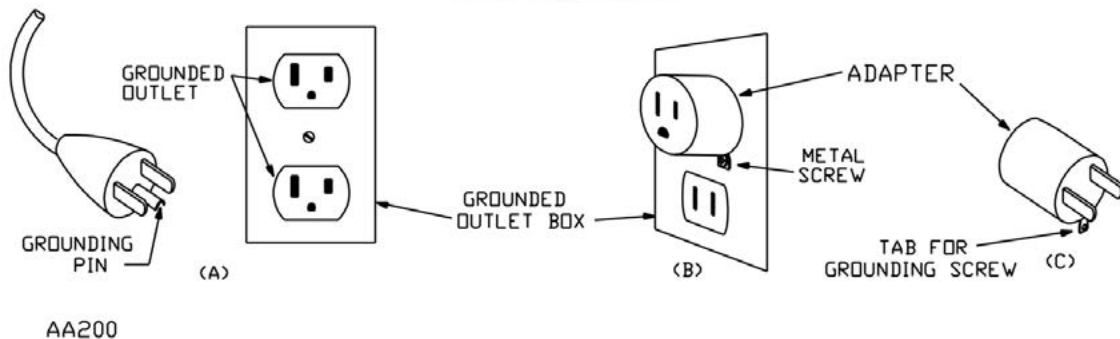

Save These Instructions

OPERATING INSTRUCTIONS – Please refer to the provided Installation Instructions and User Guide.

POLARIZED PLUG INSTRUCTIONS – To reduce the risk of electric shock, this furnishing has a polarized plug (one blade is wider than the other). This plug will fit in a polarized outlet only one way. If the plug does not fit fully in the outlet, reverse the plug. If it still does not fit, contact a qualified electrician to install the proper outlet. Do not change the plug in any way.

SERVICING OF DOUBLE-INSULATED PRODUCTS – In a double-insulated product, two systems of insulation are provided instead of grounding. No grounding means is provided on a double-insulated product, nor is a means for grounding to be added to the product. Servicing a double-insulated product requires extreme care and knowledge of the system, and is to be done only by qualified service personnel. Replacement parts for a double-insulated product must be identical to the parts they replace. A double-insulated product is marked with the words “DOUBLE INSULATION”, “DOUBLE INSULATED”, or .

This product is for use on a nominal 120-V circuit. Make sure that the product is connected to an outlet having the same configuration as the plug. No adapter should be used with this product.

Hardware



M6 1.00 x 12mm
Screw (125285)



#10 X 1" WOOD
SCREW (0002147)



LOCK WASHER
(121406)

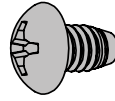

8-32 X 1/4"
THREAD CUTTING
SCREW (121538)

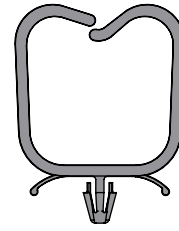

DATA MANAGER
CLIPS (0000003)

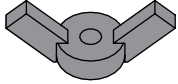

8-32 WING NUT
(888101)

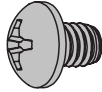

8-32 X 1/4" SCREW
(121535)

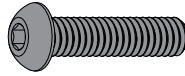

5/16-18 X 1.25"
SCREW (125030)

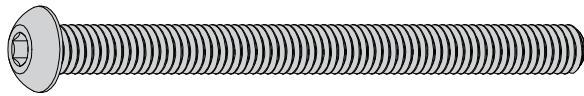

5/16-18 X 3.5"
SCREW (0002127)

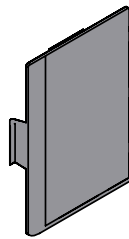

BLANK DATA PORT
(0001367)

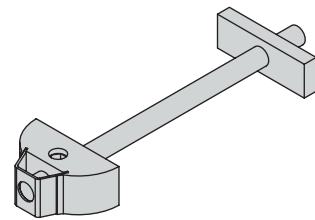

TIGHT JOINT
(0002294)

Tonic Worktable Components

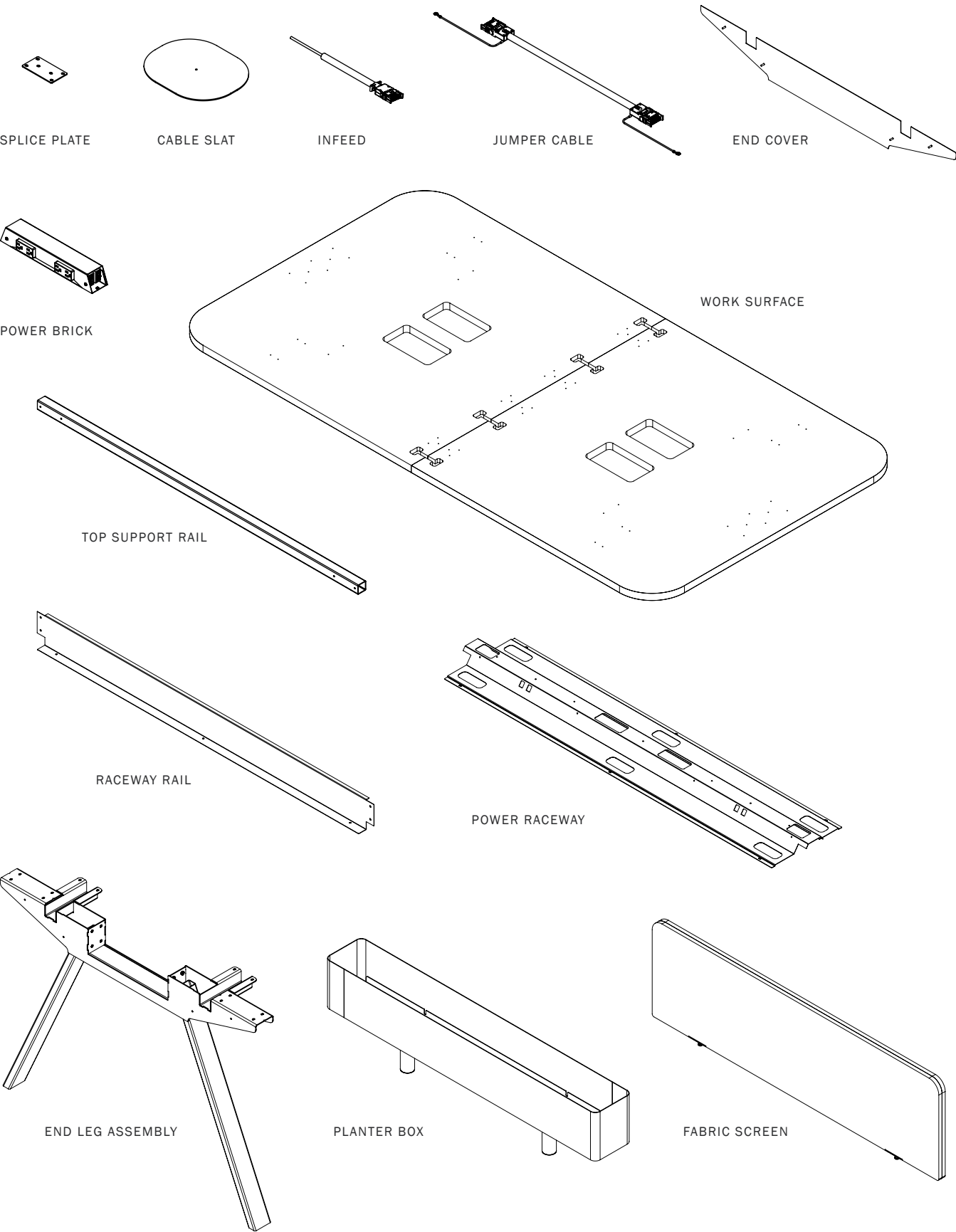

Tools

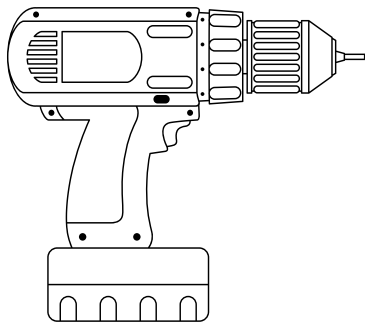

Electric Drill



P2 Phillips
Driver Bit



4mm Hex Drill/
Driver Bit



6mm Hex Drill/
Driver Bit



Torx T-25
Driver Bit

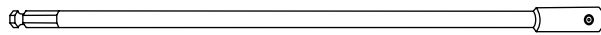
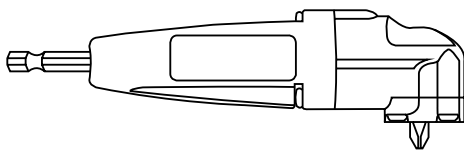

Additional tools such as a 90 Degree Bit and an 18" Extension are helpful for some steps

*No torque or ball bits should be used

1. Top Support Rail

Orient Leg Assemblies upright and attach top support rails with 4 screws (125285) per top support rail.



M6 1.00 x 12mm
Screw (125285)

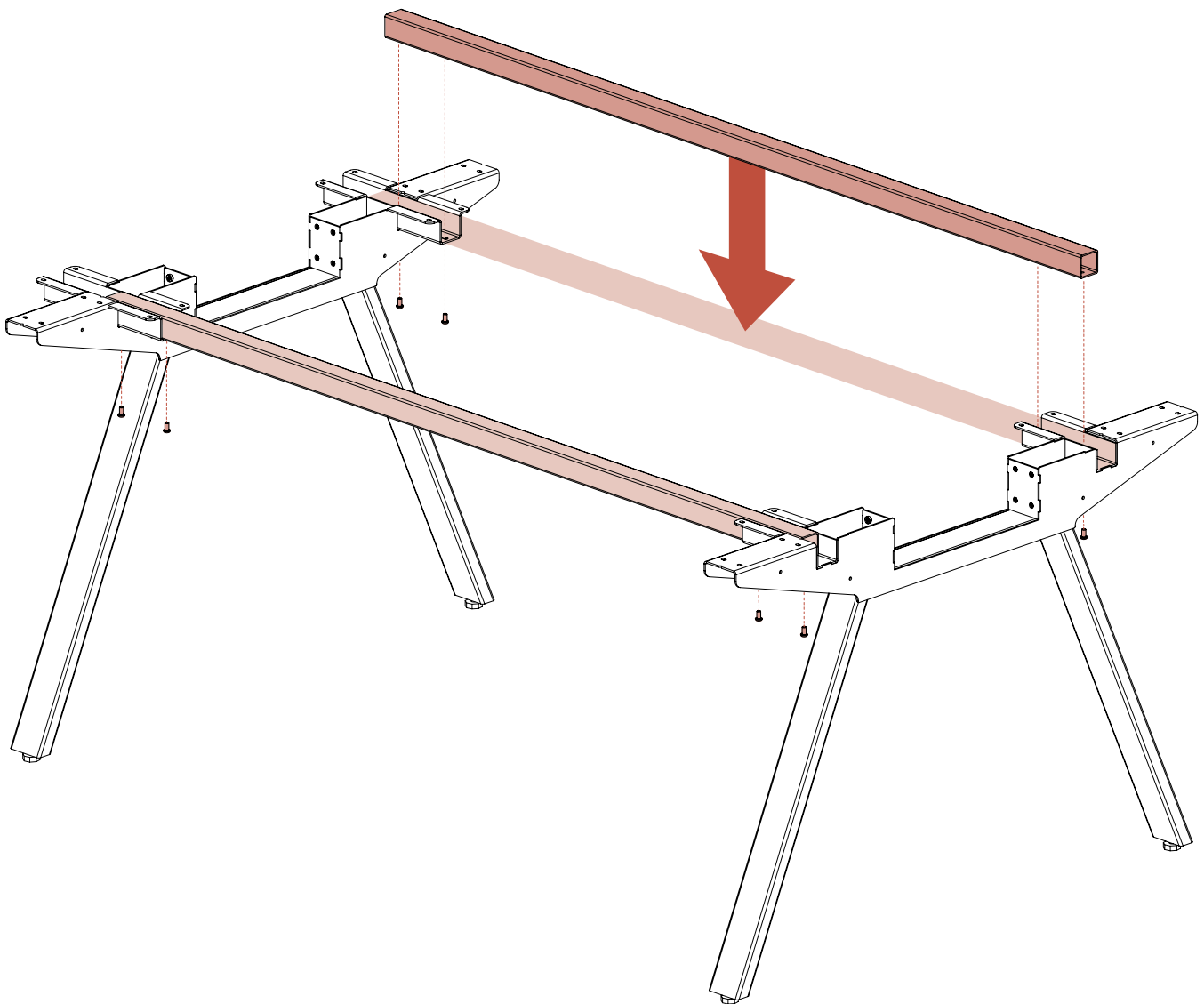

2.

Raceway Rail

Attach raceway rails with 4 screws (125285) per rail.



M6 1.00 x 12mm
Screw (125285)

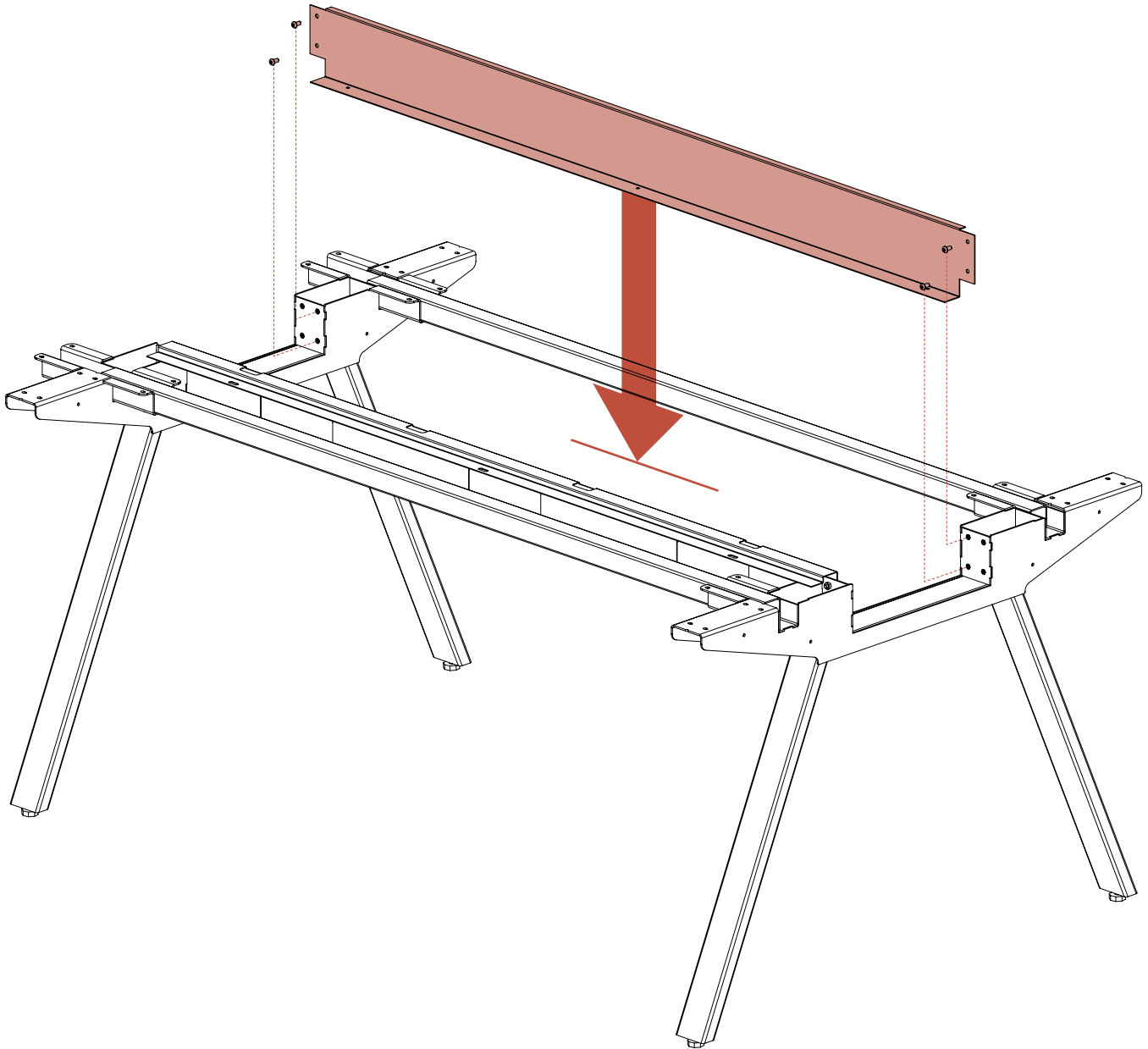

3. Attach Power Bricks

- (a) Attach power bricks to power raceway using thread cutting screw (121538) with washer (121406).
- (b) Push data manager clips (0000003) into provided holes in top of power raceway.

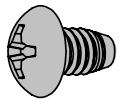

8-32 X 1/4"
THREAD CUTTING
SCREW (121538)



LOCK WASHER
(121406)

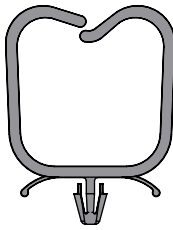

DATA MANAGER
CLIPS (0000003)

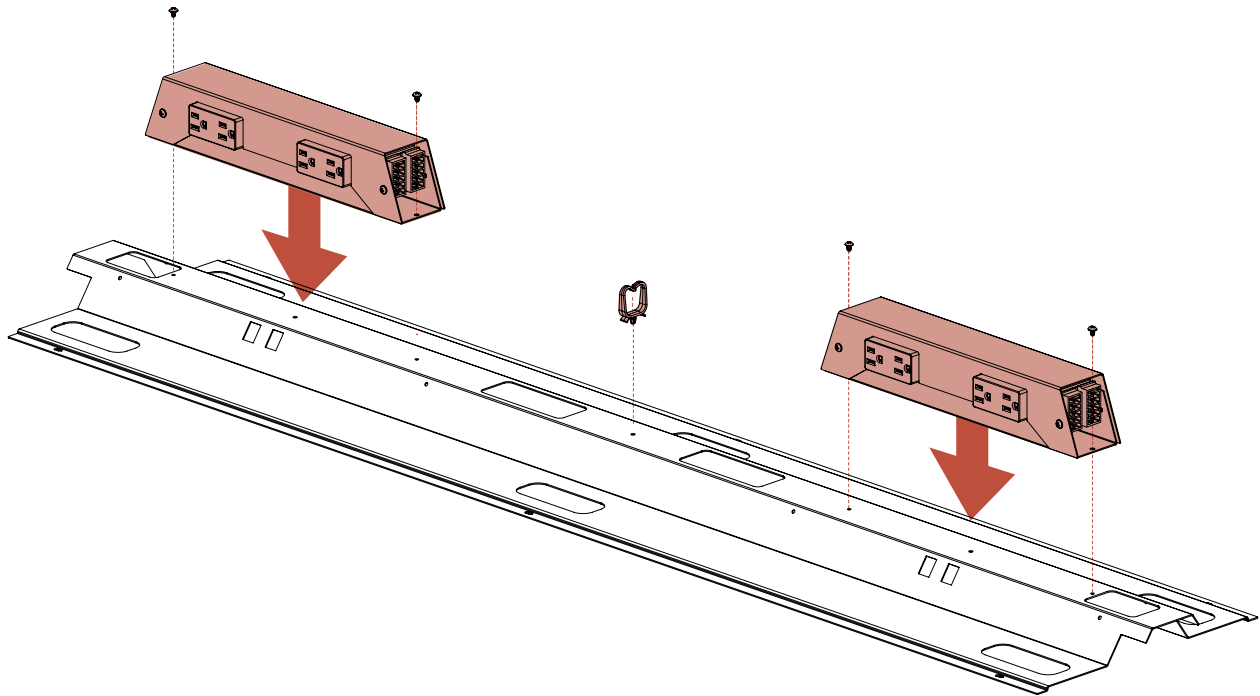

4. Install Power

WARNING - All bolted connections must be securely fastened to insure that furnishings are mechanically interconnected before Raceway installation.

- (a) Securely fasten all screws to ensure the components are mechanically interconnected before Raceway installation.
- (b) Place the power raceway into the center of the table. Attach the Power Raceway to the Raceway Rails with 6 screws (121535).
- (c) Create electrical connection between Power Bricks by connecting the Jumper Cables or Infeed to the end of power bricks. Check each connection by slowly pulling on each cable after making a connection.

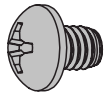

8-32 X 1/4" SCREW
(121535)

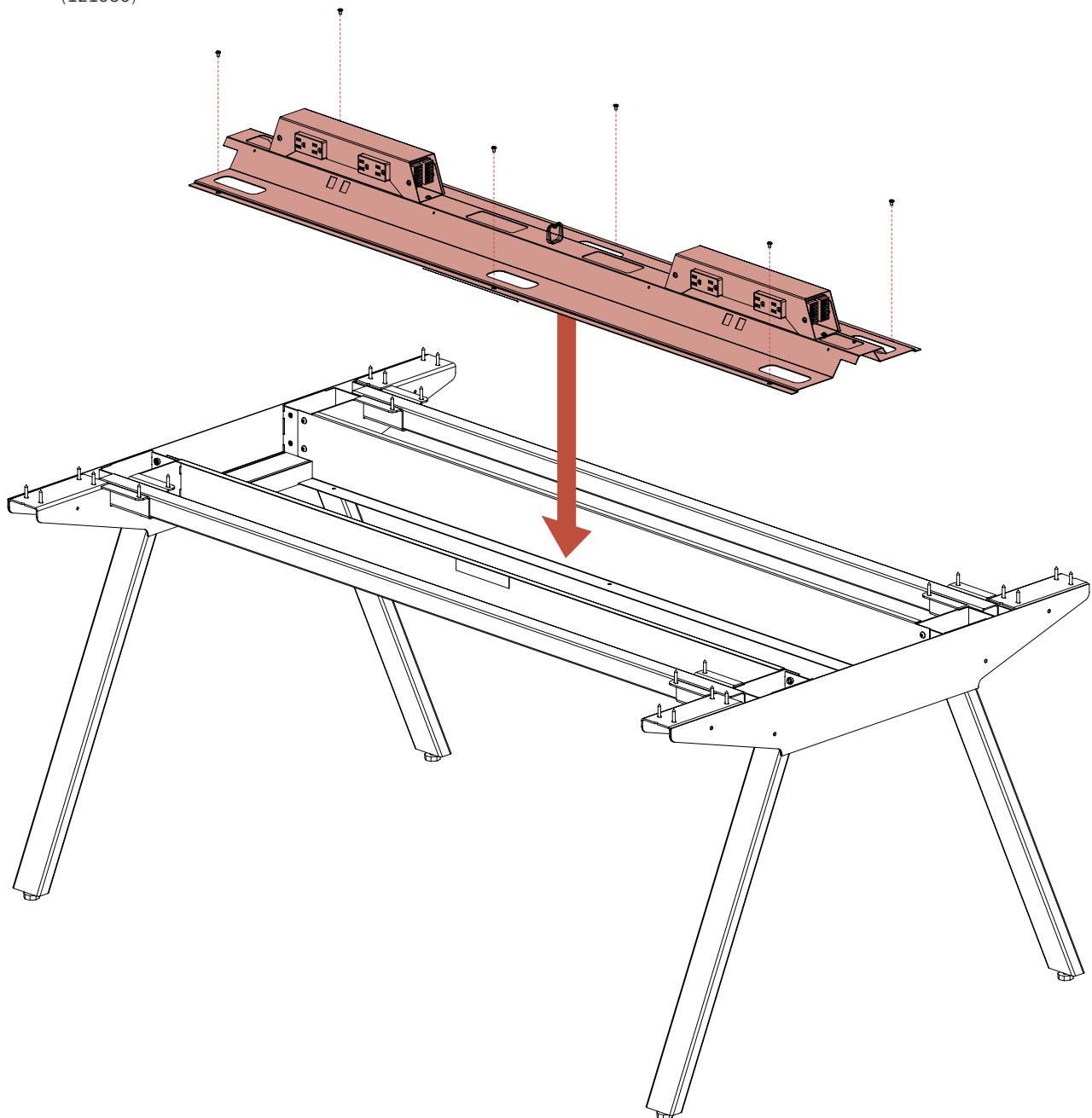

5.

Ground Jumper Cables

Ground the jumper cable to the power raceway with the provided screws (121538) and washers (121406).

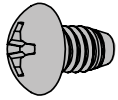

8-32 X 1/4"
THREAD CUTTING
SCREW (121538)



LOCK WASHER
(121406)

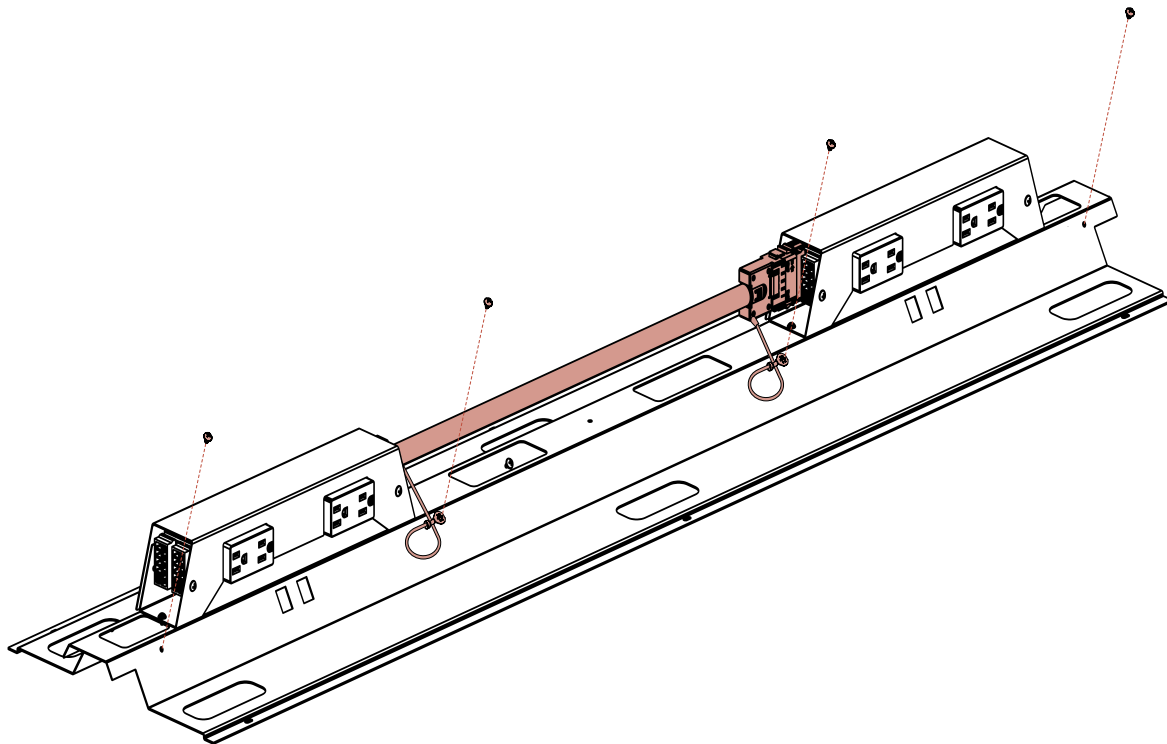

6. Secure Surfaces Together

(a) Place the surface(s) on top of the base

(b) For two piece tops, tighten tite joints with T25 Torx bit. Completely secure splice plates to surfaces with 6 screws (0002147) per splice plate.

After this step is completed, accessories may be attached.

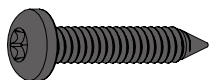

#10 X 1" WOOD
SCREW (0002147)

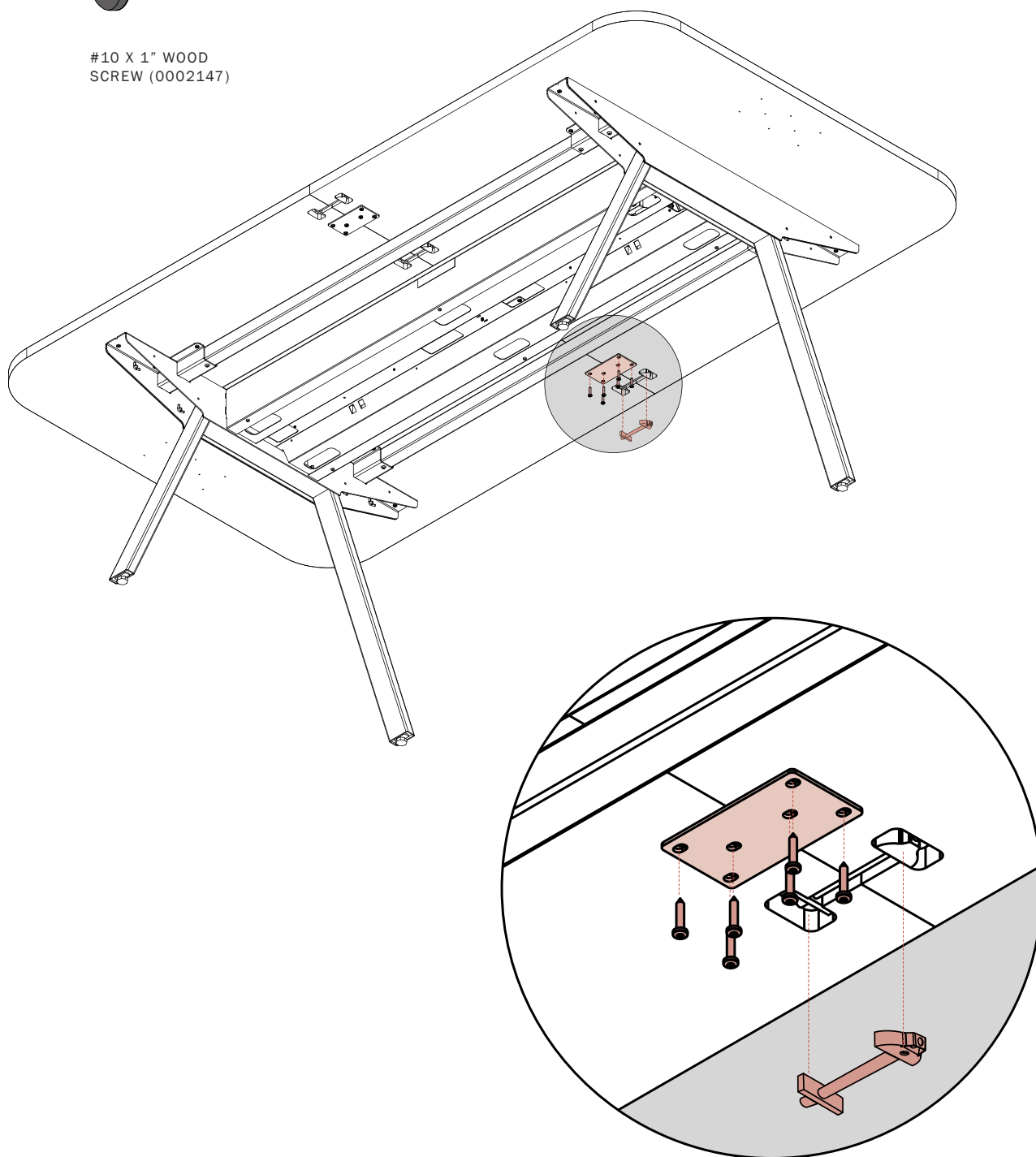

7. Attach Planter (Optional)

Secure planter box to work surface with 2 screws (0002127).

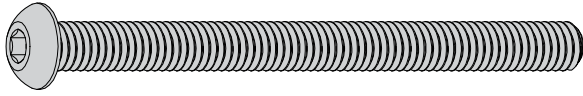

5/16-18 X 3.5"
SCREW (0002127)

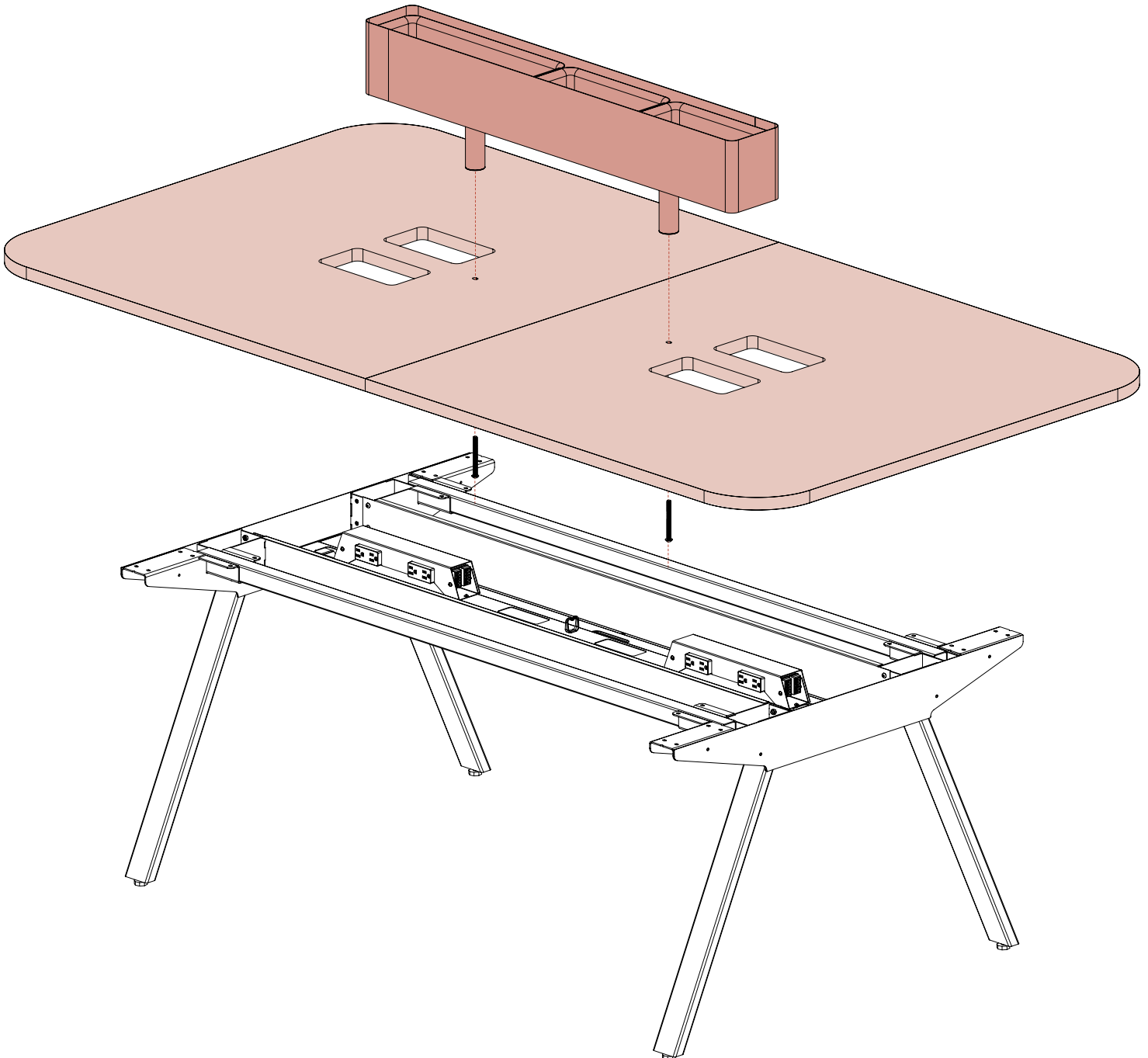

8. Attach Screen (Optional)

Secure screen to work surface with 2 screws (125030) per screen.

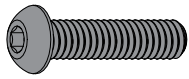

5/16-18 X 1.25"
SCREW (125030)

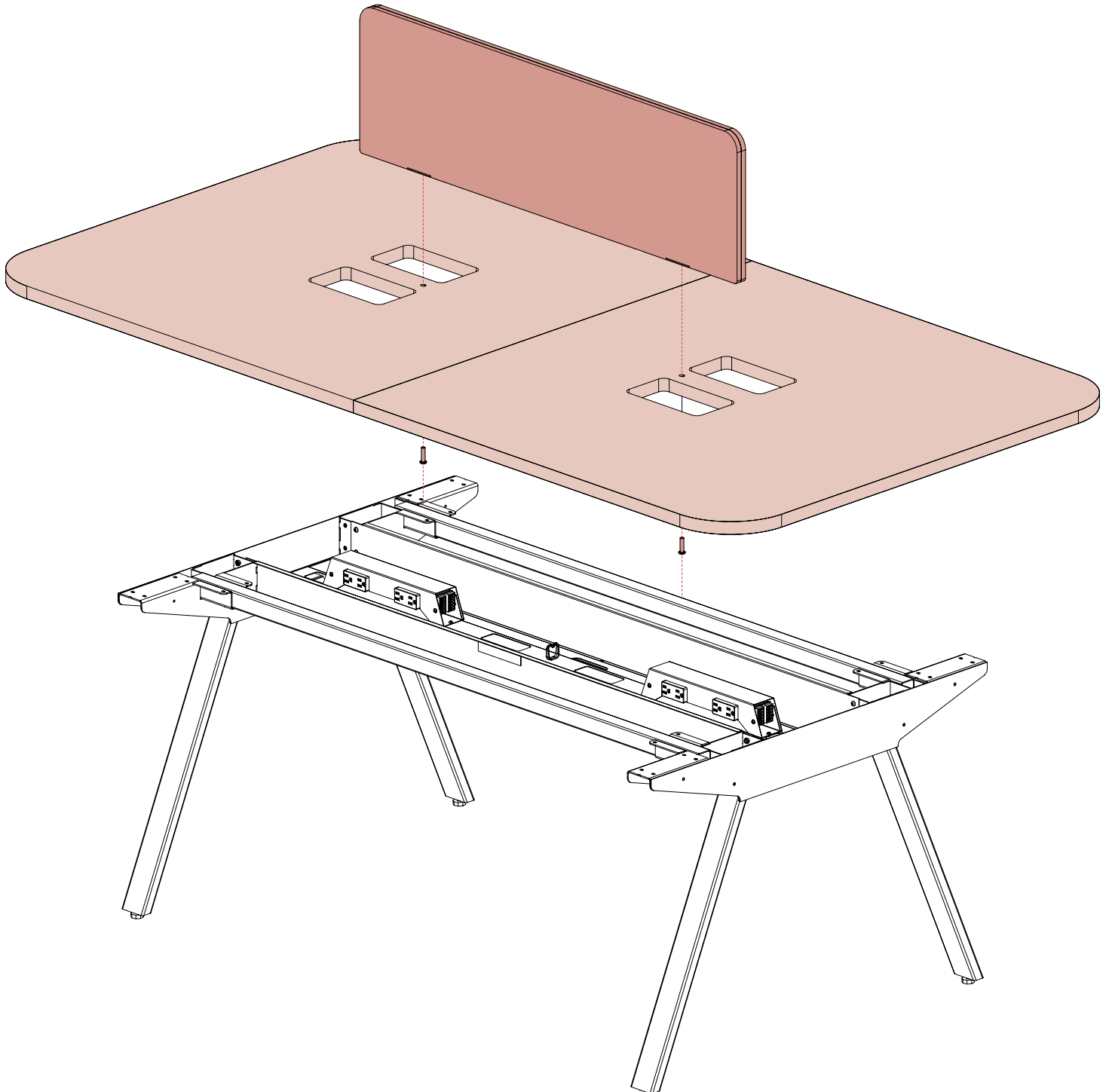

9. Attach Surface

Use screws (0002147) to secure the work surfaces to the legs.

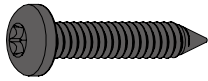

#10 X 1" WOOD
SCREW (0002147)

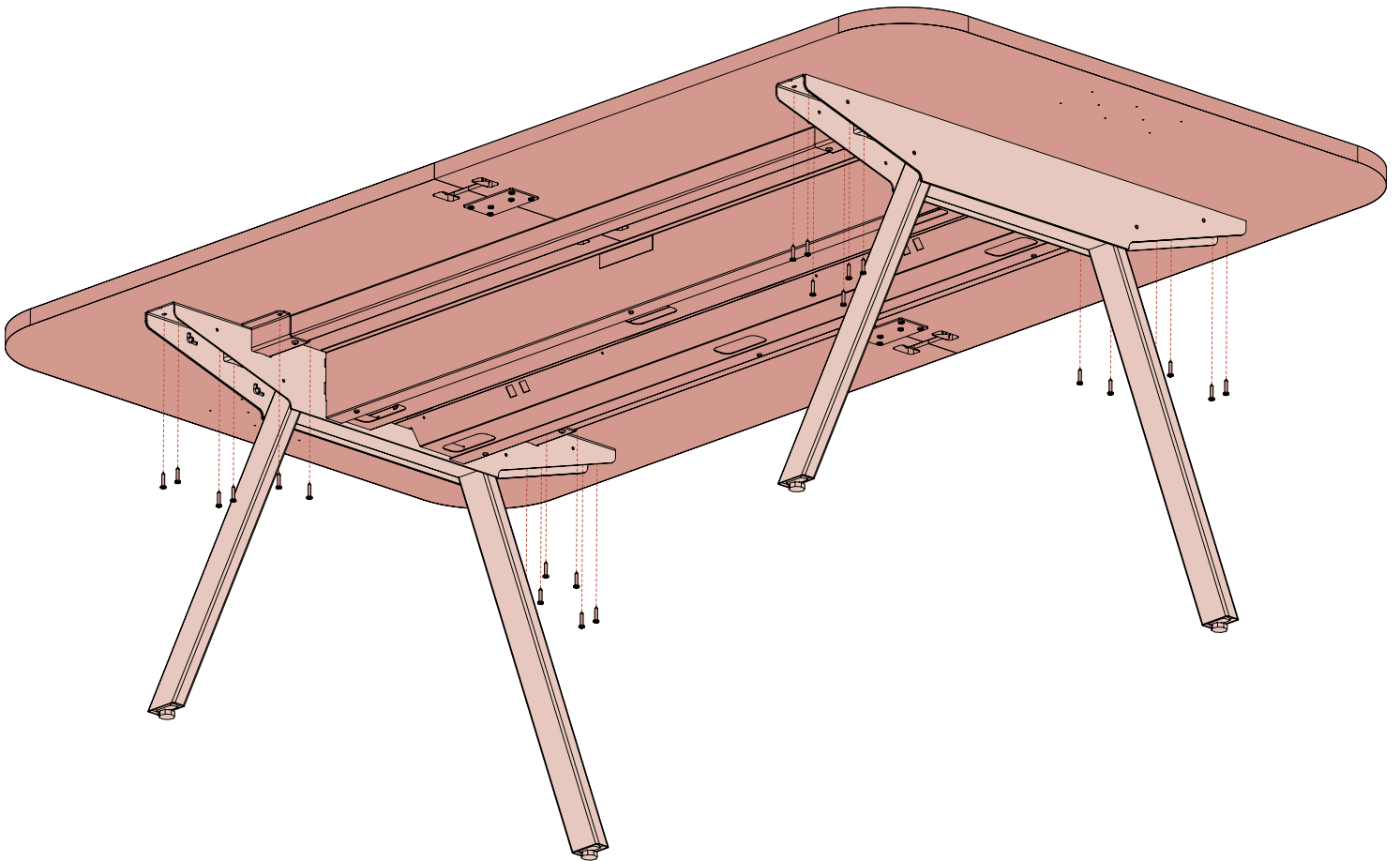

10. Cable Slats

Cable Slats go underneath the Power Raceway to keep data cables from hanging below the raceway. To install, rotate in between raceway rails until the fit is snug and secure.

